



Chipsmall Limited consists of a professional team with an average of over 10 year of expertise in the distribution of electronic components. Based in Hongkong, we have already established firm and mutual-benefit business relationships with customers from,Europe,America and south Asia,supplying obsolete and hard-to-find components to meet their specific needs.

With the principle of “Quality Parts,Customers Priority,Honest Operation,and Considerate Service”,our business mainly focus on the distribution of electronic components. Line cards we deal with include Microchip,ALPS,ROHM,Xilinx,Pulse,ON,Everlight and Freescale. Main products comprise IC,Modules,Potentiometer,IC Socket,Relay,Connector.Our parts cover such applications as commercial,industrial, and automotives areas.

We are looking forward to setting up business relationship with you and hope to provide you with the best service and solution. Let us make a better world for our industry!



Contact us

Tel: +86-755-8981 8866 Fax: +86-755-8427 6832

Email & Skype: info@chipsmall.com Web: www.chipsmall.com

Address: A1208, Overseas Decoration Building, #122 Zhenhua RD., Futian, Shenzhen, China



Hall Effect Current Sensors

3 to 25 Amp Applications — Open Loop

- Compact PCB Mount Design
- Voltage Output type
- Very High Linearity
- 15V Supply Voltage
- CE EN50178 (pending)



Specifications Measured at 25°C, RL=10KΩ, Vcc=+15V

Specification	L16P003D15	L16P005D15	L16P010D15	L16P015D15	L16P020D15	L16P025D15
Nominal Primary DC Current (If)	3A	5A	10A	15A	20A	25A
Maximum Current If(max)	±9	±15	±30	±45	±60	±75
Output Voltage @ If	V _{OUT} 4V					
Offset Voltage V _{OE}	< ±40mV					
Accuracy @ If ²	< ± 1% of If					
Output Linearity ² (0..If MAX)	E _L < ± 1% of If					
Power Supply V _{cc}	±15V ±5%					
Response Time t _r	<5μs					
Current Consumption I _c	±12mA typ					
Output Temperature Characteristic TCE _G	<±0.1% / °C					
Offset Temperature Characteristic V _{OT}	± 1.2mV / °C typ					
Hysteresis Allowance @ If=0 V _{OH}	<±25mV					
Withstand Voltage (50/60Hz) V _d	2,000VACrms for 1 minute (Sensing Current 0.5mA)					
Insulation Resistance @ 500VDC R _{IS}	≥ 500MΩ					
Operating Bandwidth ¹ (-3dB) f	DC - 35kHz					
Operating Temperature T _A	-10 - +80°C					
Storage Temperature T _s	-20 - +85°C					

¹ Small signal only; derating needed to avoid excessive core heating at high frequency

² Without offset

Package & Weight Information

QTY/Box	Weight/each(g)
100	10

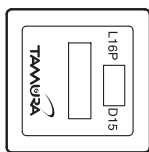

View A

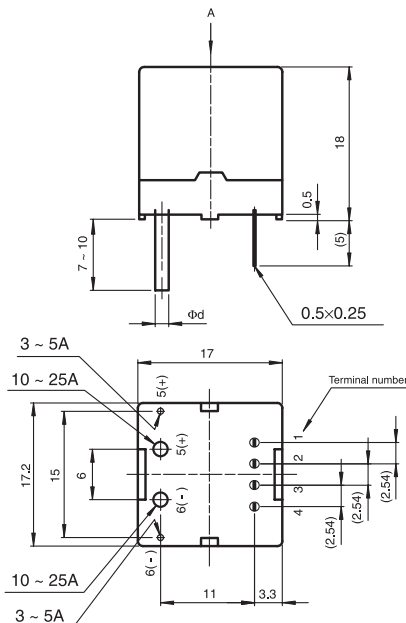

Types	Rated current	φ d
L16P003D15	3A	φ 0.5
L16P005D15	5A	φ 0.6
L16P010D15	10A	φ 0.8
L16P015D15	15A	φ 1.2
L16P020D15	20A	φ 1.4
L16P025D15	25A	φ 1.4

Terminal number	
1	- 15V
2	0V
3	+15V
4	OUT
5	+IN
6	- IN

TAMURA CORPORATION

43352 Business Park Drive. | P.O. Box 892230 Temecula, CA 92589-2230 | www.tamuracorp.com
 USA | Japan | United Kingdom | Hong Kong
 Tel: 800-872-6624 | Tel: 81 (0)3 3978-2111 | Tel: 44 (0) 1380 731 700 | Tel: 852-2389-4321
 Fax: 909-676-9482 | Fax: 81 (0)3 3923-0230 | Fax: 44 (0) 1380 731 702 | Fax: 852-2341-9689