



Chipsmall Limited consists of a professional team with an average of over 10 year of expertise in the distribution of electronic components. Based in Hongkong, we have already established firm and mutual-benefit business relationships with customers from,Europe,America and south Asia,supplying obsolete and hard-to-find components to meet their specific needs.

With the principle of “Quality Parts,Customers Priority,Honest Operation,and Considerate Service”,our business mainly focus on the distribution of electronic components. Line cards we deal with include Microchip,ALPS,ROHM,Xilinx,Pulse,ON,Everlight and Freescale. Main products comprise IC,Modules,Potentiometer,IC Socket,Relay,Connector.Our parts cover such applications as commercial,industrial, and automotives areas.

We are looking forward to setting up business relationship with you and hope to provide you with the best service and solution. Let us make a better world for our industry!



Contact us

Tel: +86-755-8981 8866 Fax: +86-755-8427 6832

Email & Skype: info@chipsmall.com Web: www.chipsmall.com

Address: A1208, Overseas Decoration Building, #122 Zhenhua RD., Futian, Shenzhen, China



This document is the property of Amphenol Corporation and is delivered on the express condition that it is not to be disclosed, reproduced or used, in whole or in part, for the manufacture or sale by anyone other than Amphenol Corporation without its prior consent, and that no right is granted to disclose or to use any information in this document.

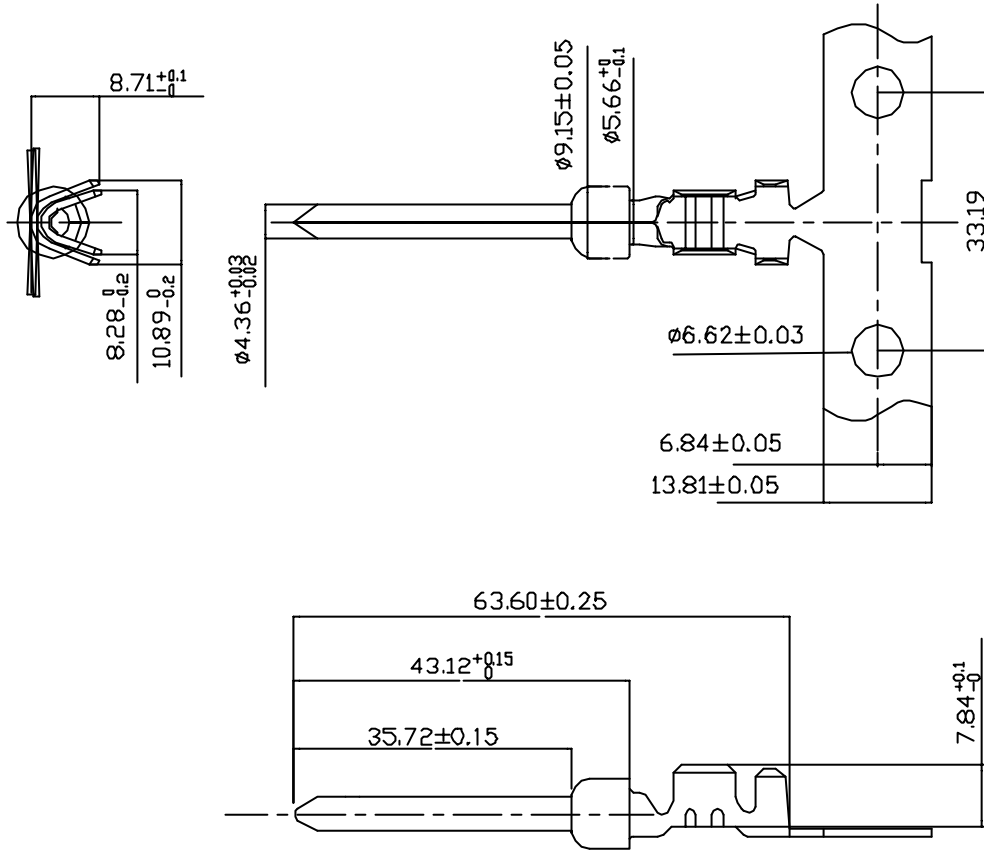

SPECIFICATIONS

Material : Brass
 Burr : 0,1mm Max. on mating area
 Camber : 0,1mm Max.
 Deformation : 0,05mm Max.
 Plating : see table below
 Underplating : $50\mu'$ Nickel

ROHS Compliant
 MSL components : level 3

L17RR D1M -- 100

Plating :
 01 : $5\mu'$ Full Gold
 02 : $15\mu'$ Full Gold
 04 : $30\mu'$ Full Gold

Packaging :
 Bag of 100 contacts

11 : $5\mu'$ selective Gold
 (tails $78\mu'$ Tin)
 12 : $15\mu'$ selective Gold
 (tails $78\mu'$ Tin)
 14 : $30\mu'$ selective Gold
 (tails $78\mu'$ Tin)

TOLERANCE (mm)	APPROVALS	DATE	TITLE	AMPHENOL	
X. ±0.25	DRAWN GDU	15/11/05	Rear Release DSub Crimp plug contacts AWG 20-24	AMPHENOL SOCAPEX	
X.X ±0.13	CHECKED PGI	15/11/05		Dole Business Unit	
X.XX ±0.05	APPROVED PGI	15/11/05		Scale N.A.	Sheet 1 of 1
Angular ±0°30'					
UNLESS OTHERWISE SPECIFIED		UNIT : MM	SIZE : A4	DRAWING N° L17RR D1M -- 100	
				REV. A	