



Chipsmall Limited consists of a professional team with an average of over 10 year of expertise in the distribution of electronic components. Based in Hongkong, we have already established firm and mutual-benefit business relationships with customers from,Europe,America and south Asia,supplying obsolete and hard-to-find components to meet their specific needs.

With the principle of "Quality Parts,Customers Priority,Honest Operation,and Considerate Service",our business mainly focus on the distribution of electronic components. Line cards we deal with include Microchip,ALPS,ROHM,Xilinx,Pulse,ON,Everlight and Freescale. Main products comprise IC,Modules,Potentiometer,IC Socket,Relay,Connector.Our parts cover such applications as commercial,industrial, and automotives areas.

We are looking forward to setting up business relationship with you and hope to provide you with the best service and solution. Let us make a better world for our industry!



## Contact us

Tel: +86-755-8981 8866 Fax: +86-755-8427 6832

Email & Skype: info@chipsmall.com Web: www.chipsmall.com

Address: A1208, Overseas Decoration Building, #122 Zhenhua RD., Futian, Shenzhen, China



REV.	DESCRIPTION	DATE	APPROVED
F	Engineering Release	10/03/12	T. Y.
G	Added LED P/N	04/01/16	J. C.
H	Updated Tables	08/08/16	J. C.

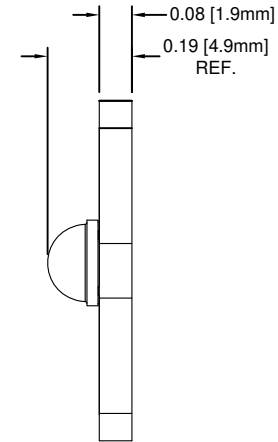
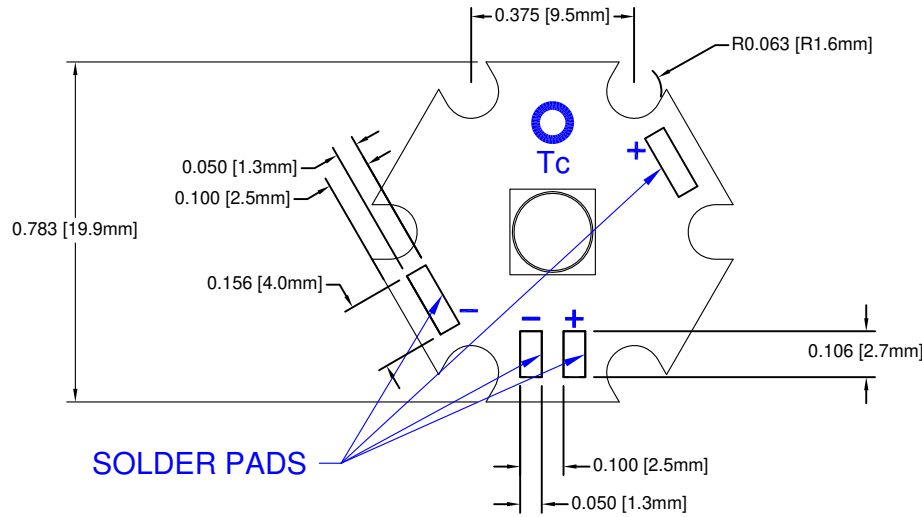

Part Number	CCT (K)	CRI	Typical Luminous Flux @ If = 400mA, Tc=70C (lm)	Typical Luminous Flux @ If = 750mA, Tc=100C (lm)	Typical DC Forward Current, Vf (V)	Viewing Angle (°)	LED P/N
L2-MLC1-S	6500	65	144	236	2.8 ~ 2.9	125	BDL-1436
L2-MLN1-S	4100	75	124	202	2.8 ~ 2.9	125	BDL-1437
L2-MLW1-S	3100	80	103	169	2.8 ~ 2.9	125	BDL-1438

Part Number	CCT (K)	CRI	Typical Luminous Flux @ If = 1000mA, Tc=110C (lm)	Typical Luminous Flux @ If = 3000mA, Tc=60C (lm)	Typical DC Forward Current, Vf (V)	Viewing Angle (°)	LED P/N
L2-MLC1-S	6500	65	281	660	3.0 ~ 3.3	125	BDL-1436
L2-MLN1-S	4100	75	241	566	3.0 ~ 3.3	125	BDL-1437
L2-MLW1-S	3100	80	201	472	3.0 ~ 3.3	125	BDL-1438

NOTES:

- BDL-1436: Reference Cree part number XMLAWT-00-0000-0000T6051 for characteristics.
- BDL-1437: Reference Cree part number XMLAWT-00-0000-000LT40E4 for characteristics.
- BDL-1438: Reference Cree part number XMLAWT-00-0000-000LT20E7 for characteristics.

STANDARD TOLERANCE (UNLESS OTHERWISE SPECIFIED)		BIVAR®	
DECIMALS	ANGULAR	4 THOMAS, IRVINE, CA. 92618 TEL.: (949) 951-8808 FAX: (949) 951-3974	
.X ± .1	X° ± 1°	TITLE: L2 Starboard Light Engine	
.XX ± .02		DESIGNED: <b>B. Oliver</b>	DATE: 11/02/11
.XXX ± .010		CHECKED: <b>M. Chen</b>	DATE: 11/02/11
		PART NO: <b>L2-MLXX-S</b>	REVISION: <b>H</b>
		CAGE CODE : 32559	SHEET # 1 OF 1
CAD GENERATED DOCUMENT. DO NOT MEASURE DRAWING.			