



Chipsmall Limited consists of a professional team with an average of over 10 year of expertise in the distribution of electronic components. Based in Hongkong, we have already established firm and mutual-benefit business relationships with customers from,Europe,America and south Asia,supplying obsolete and hard-to-find components to meet their specific needs.

With the principle of “Quality Parts,Customers Priority,Honest Operation,and Considerate Service”,our business mainly focus on the distribution of electronic components. Line cards we deal with include Microchip,ALPS,ROHM,Xilinx,Pulse,ON,Everlight and Freescale. Main products comprise IC,Modules,Potentiometer,IC Socket,Relay,Connector.Our parts cover such applications as commercial,industrial, and automotives areas.

We are looking forward to setting up business relationship with you and hope to provide you with the best service and solution. Let us make a better world for our industry!



## Contact us

Tel: +86-755-8981 8866 Fax: +86-755-8427 6832

Email & Skype: [info@chipsmall.com](mailto:info@chipsmall.com) Web: [www.chipsmall.com](http://www.chipsmall.com)

Address: A1208, Overseas Decoration Building, #122 Zhenhua RD., Futian, Shenzhen, China



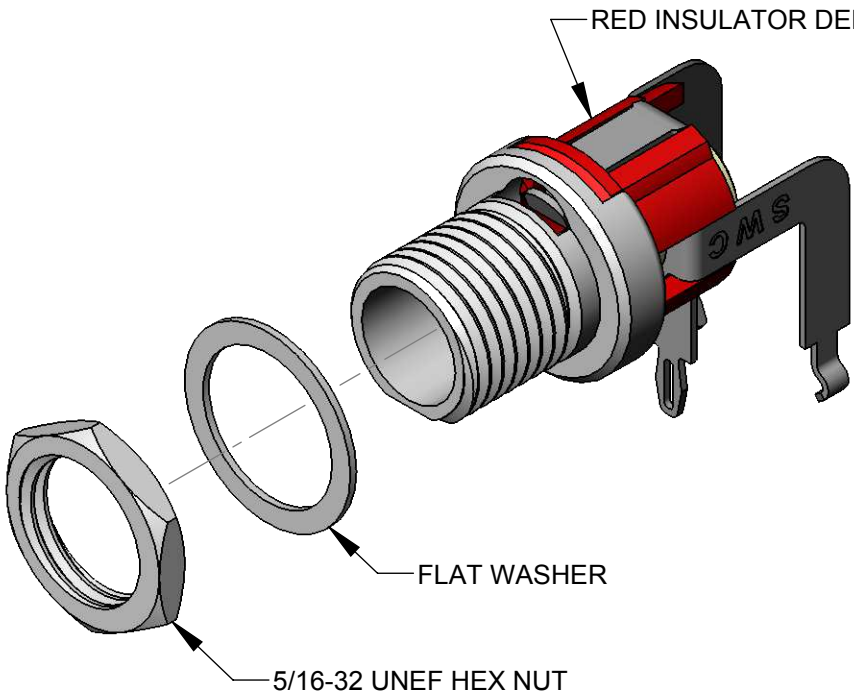

PART NUMBER	DESCRIPTION	SWITCHCRAFT MATING 2.1mm POWER PLUGS
L721RA	2.1mm POWER JACK, LONG BUSHING, RIGHT-ANGLE PC	767K, 768K

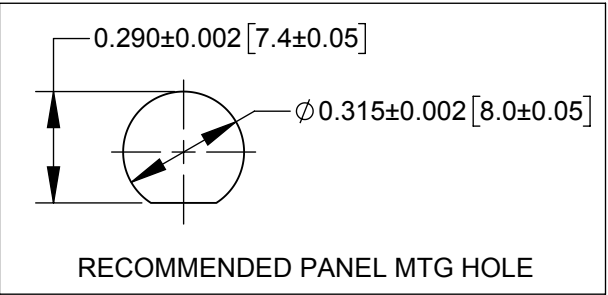
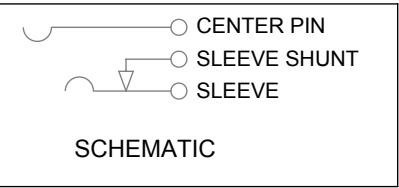
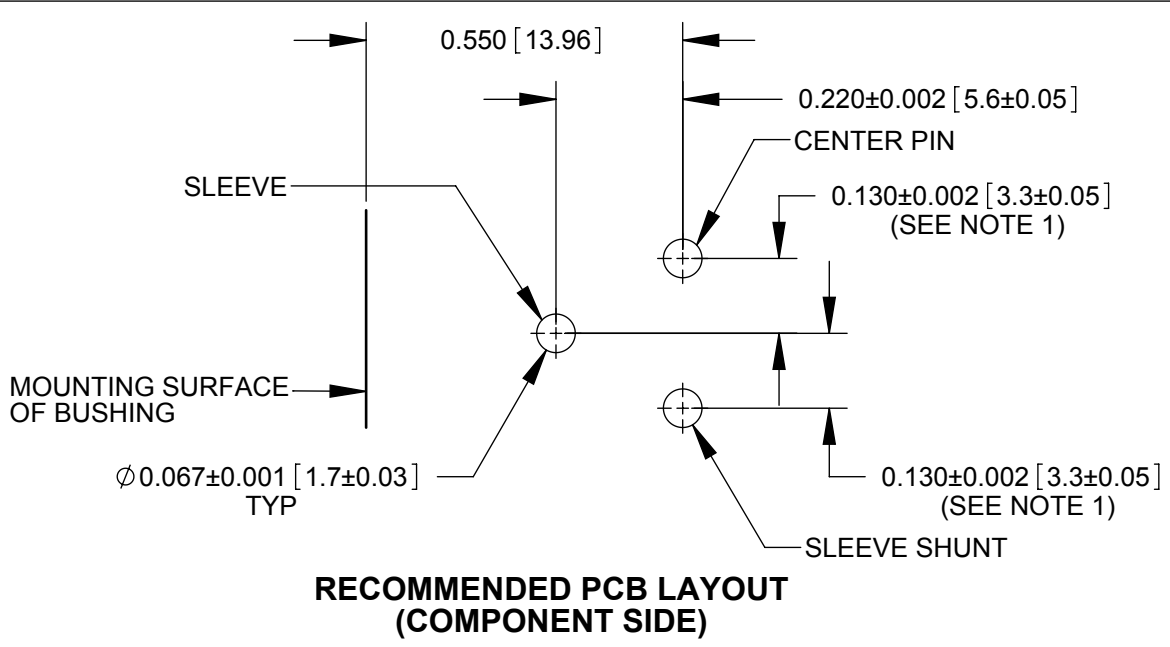
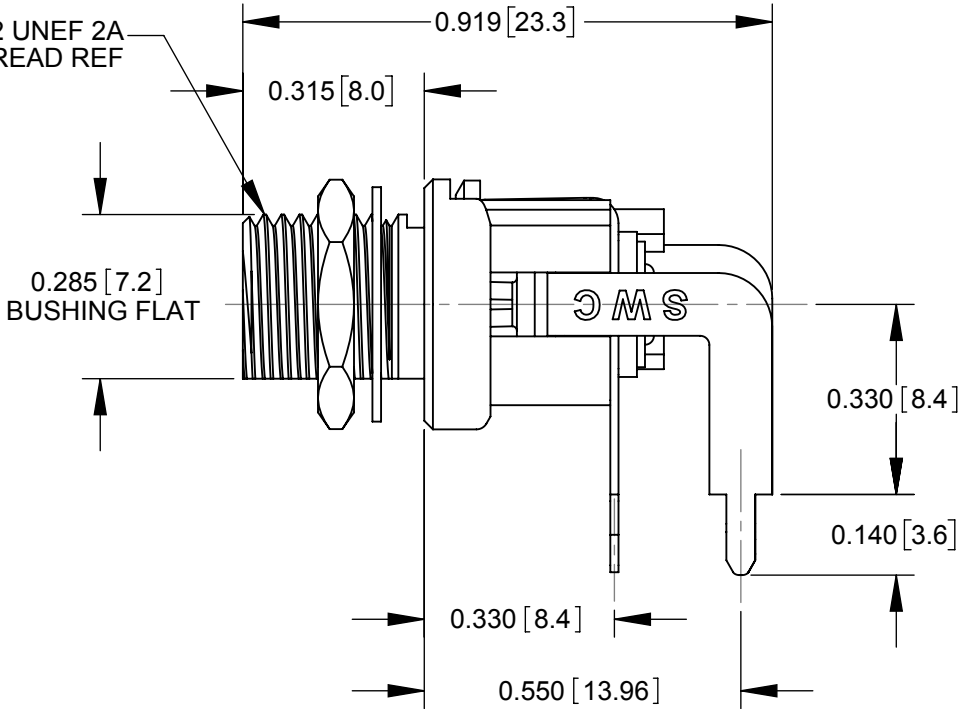
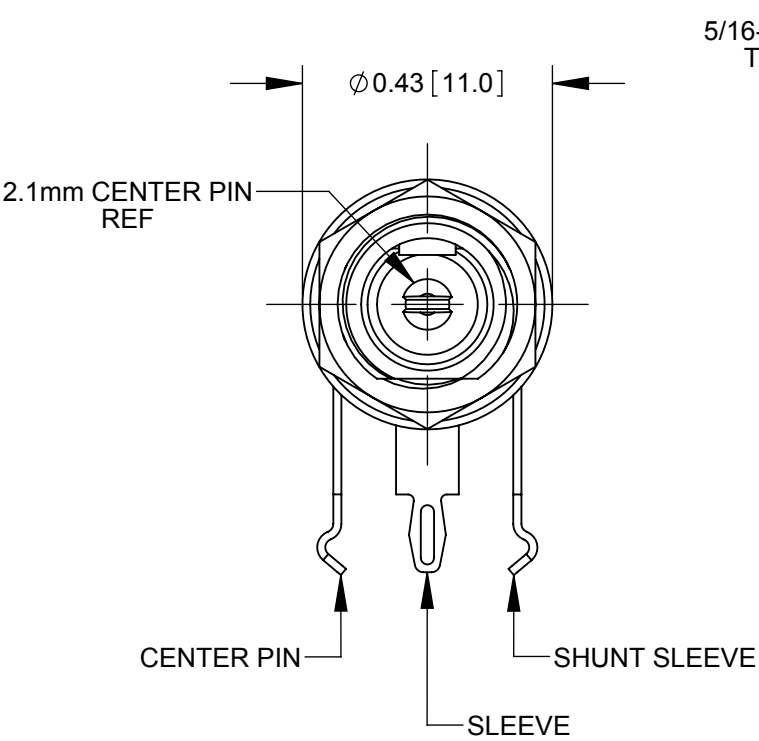

- NOTES:
1. FOR HAND INSERTION USE SPACING 0.130 [3.30]  
FOR AUTOMATED INSERTION USE SPACING 0.135 [3.43]
  2. DIMENSIONS SHOWN FOR REFERENCE ONLY.
  3. HEX NUT AND FLAT WASHER SUPPLIED UNASSEMBLED.
  4. MATERIAL:  
HOUSING, HEX NUT - COPPER ALLOY, NICKEL PLATED  
INSULATOR HOUSING - THERMOPLASTIC  
TERMINAL INSULATORS - PHENOLIC  
FLAT WASHER - STEEL, NICKEL PLATED  
PIN, SPRING, TERMINALS - COPPER ALLOY, SILVER PLATED
  5. THESE PRODUCTS ARE RoHS COMPLIANT

CUSTOMER DRAWING

						THIS DRAWING DESCRIBES A DESIGN CONSIDERED PROPRIETARY IN NATURE, DEVELOPED AND MANUFACTURED BY SWITCHCRAFT INC. AND IS RELEASED ON A CONFIDENTIAL BASIS FOR IDENTIFICATION PURPOSES ONLY.									
					UNLESS OTHERWISE SPECIFIED  1. ALL DIMENSIONS IN INCHES  - TWO PLACE DECIMALS    ±0.02  - THREE PLACE DECIMALS    ±0.005	SIZE	WIDTH		MULT		LBS/M		TEMPER		
						FINISH SPEC No.					MATERIAL SPEC No.				
						FIRST USED ON			SCALE 3:1		Switchcraft®				
						DATE DRAWN 02/09/17	BY PNK	CHKD PNK 02/09/17	APVD SRC 02/09/17						
0A	PRELIMINARY	02/09/17	PNK	SRC							SHEET    1            OF       1				
REV	ECO NUMBER	DATE	BY	APVD							NAME 2.1mm POWER JACK LONG BUSHING, RIGHT-ANGLE PC, RoHS		PART No.  L721RA		REV 0A
REVISIONS					DO NOT SCALE DRAWING										