



Chipsmall Limited consists of a professional team with an average of over 10 year of expertise in the distribution of electronic components. Based in Hongkong, we have already established firm and mutual-benefit business relationships with customers from,Europe,America and south Asia,supplying obsolete and hard-to-find components to meet their specific needs.

With the principle of "Quality Parts,Customers Priority,Honest Operation,and Considerate Service",our business mainly focus on the distribution of electronic components. Line cards we deal with include Microchip,ALPS,ROHM,Xilinx,Pulse,ON,Everlight and Freescale. Main products comprise IC,Modules,Potentiometer,IC Socket,Relay,Connector.Our parts cover such applications as commercial,industrial, and automotives areas.

We are looking forward to setting up business relationship with you and hope to provide you with the best service and solution. Let us make a better world for our industry!



## Contact us

Tel: +86-755-8981 8866 Fax: +86-755-8427 6832

Email & Skype: [info@chipsmall.com](mailto:info@chipsmall.com) Web: [www.chipsmall.com](http://www.chipsmall.com)

Address: A1208, Overseas Decoration Building, #122 Zhenhua RD., Futian, Shenzhen, China



This document is the property of Amphenol Corporation and is delivered on the express condition that it is not to be disclosed, reproduced or used, in whole or in part, for manufacture or sale by anyone other than Amphenol Corporation without its prior consent, & that no right is granted to disclose or to use any information in this document.

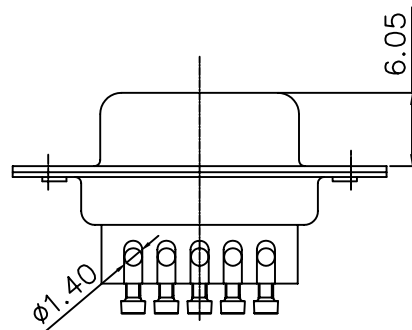
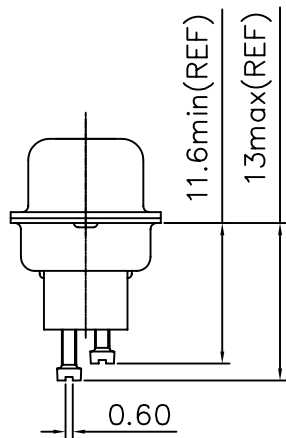
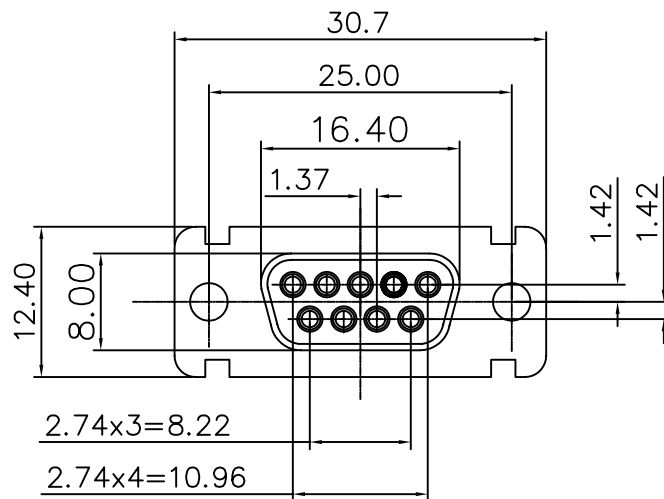

REVISIONS				
SYM	ECN	DESCRIPTION	DATE	APPROVED
A1			06/12/07	

### D-SUB TECHNICAL DATA

SHELL :Steel 2.5um (100u") min tin over 1.25um (50u") min nickel

BODY : Glass filled thermoplastic.

Flame retardant to UL94 V-0 Color Black

CONTACTS : brass.

0.1um(4u") min gold over 1.25um (50u") min nickel

SCREWLOCK : brass. 6um up to 10um tinned over nickel 2um up to 3um

ELECTRICAL : Voltage rating : 300 V RMS at 50 Hz  
withstanding volatage : 1000V RMS at 50Hz

Current rating: 7.5A.

Insulation resistance >5000 M Ohms

Contact resistance 20 mOhms max.

CLIMATIC : Temperature range -55 °C up to 85°C ,peak at 125°C

MARKING : Amphenol-...(Series No.)

Commercial reference

Manufacturing date

### PRODUCT CODE

L 77D E 09 S ST

L: RoHS Compliance

77D: tinned shel for receptable

shell size: E

configuration: 09

contact termination:  
ST=Screw termination

contact type:  
S=Female

UNLESS OTHERWISE SPECIFIED TOLERANCES		APPROVAL	DATE
U.S.	METRIC	DRAWN	Lisa peng 06/12/07
.X +/-	0.50	CHECKED	lik.wang 06/12/07
.XX +/-	0.30	CHECKED	
.XXX +/-	0.20		
FRACTIONS +/-	2'		
ANGLES +/-			
FOR MATERIALS AND FINISHES SEE NOTES		DRAWING FILE :	
REMOVE SHARP EDGES		ANGLE OF PROJECTION	
DIMENSIONS			
U.S.	INCHES		
METRIC	MM		

Amphenol

TITLE  
machined contact, D-ST series

SIZE	DRAWING NO.	REV.
A4	C L77DE09SST	A
SCALE	NONE	SHEET 1 OF 1



# REVISIONS

SYM	ECN	DESCRIPTION	DATE	APPROVED

## Plastic hoods

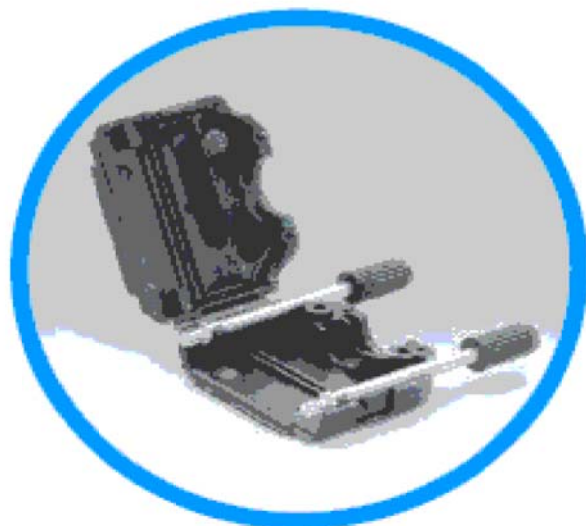

DPPK Straight cable entry

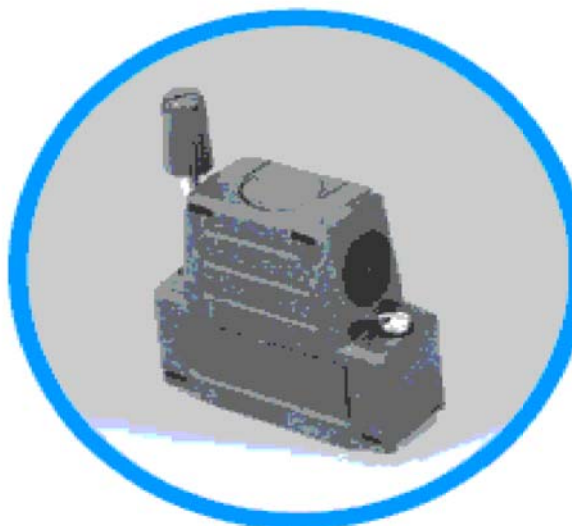

DSSK Angled cable entry

Kit connector+hood option:  
(See following decscription) c

X X ST X X

- 1=DPPK
- 2=DSSK
- 3=DTZK
- 4=DVZK

Blank: standard type

## Metallic hoods



DTZK Straight cable entry

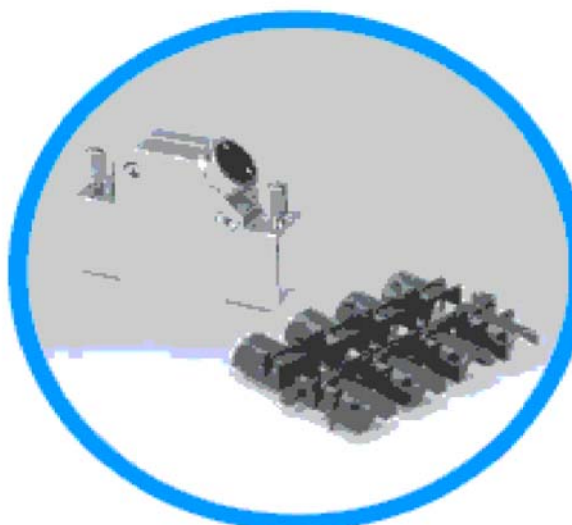

DVZK Angled cable entry

APPROVAL	DATE	Amphenol	
DRAWN Terry.sie	4/19/07		
CHECKED Mh.wang	4/19/07		
CHECKED			
DRAWING FILE :		TITLE	
		Stamped and Formed connector, SD series	
ANGLE OF PROJECTION		SIZE DRAWING NO.	REV.
		A4 C STXX	
		SCALE NONE	SHEET 1 OF 1