



Chipsmall Limited consists of a professional team with an average of over 10 year of expertise in the distribution of electronic components. Based in Hongkong, we have already established firm and mutual-benefit business relationships with customers from,Europe,America and south Asia,supplying obsolete and hard-to-find components to meet their specific needs.

With the principle of “Quality Parts,Customers Priority,Honest Operation,and Considerate Service”,our business mainly focus on the distribution of electronic components. Line cards we deal with include Microchip,ALPS,ROHM,Xilinx,Pulse,ON,Everlight and Freescale. Main products comprise IC,Modules,Potentiometer,IC Socket,Relay,Connector.Our parts cover such applications as commercial,industrial, and automotives areas.

We are looking forward to setting up business relationship with you and hope to provide you with the best service and solution. Let us make a better world for our industry!



## Contact us

Tel: +86-755-8981 8866 Fax: +86-755-8427 6832

Email & Skype: [info@chipsmall.com](mailto:info@chipsmall.com) Web: [www.chipsmall.com](http://www.chipsmall.com)

Address: A1208, Overseas Decoration Building, #122 Zhenhua RD., Futian, Shenzhen, China



# .290" MOUNT PANEL LIGHT SOCKETS

## 90 Series Mounting Hardware

- Sockets for 90 Series Panel Lights
- Mounting Hole Diameter: Ø.375" - Ø.385".  
Panel Thickness: Max: 0.80"

### TO ORDER, FOLLOW THE EXAMPLE:

Select one **BOLD** component from each SHADED column in the tables below.

1 Model	2 Lens Diffusion	3 Lens Color
L92	-C	R

→Part Number **L92-CR**

### 90 SERIES SOCKETS & HARDWARE

1 Model	Description	Mating Components
<b>PS90</b> <sup>[1]</sup>	90 Series Socket, Solder Terminals	C905, C91, C94, C96, C961, C964
<b>PS90T</b> <sup>[1]</sup>	90 Series Socket, Turret Terminals	C905, C91, C94, C96, C961, C964
<b>RC90</b>	Retaining Collar	PS90, PS90T
<b>SH90</b>	Wiring Plug	905, 91, 94, 96, 961, 964, C905, C91, C94, C96, C961, C964
<b>CSH90</b>	Wiring Plug with collar	905, 91, 94, 96, 961, 964, C905, C91, C94, C96, C961, C964
<b>TC9</b>	90 Series Mounting Clip	905, 91, 94, 96, 961, 964, C905, C91, C94, C96, C961, C964
<b>NW9</b>	90 Series Mounting Washer (neoprene)	905, 91, 94, 96, 961, 964, C905, C91, C94, C96, C961, C964

### 90 SERIES LENS (For use with PS90 or PS90T Socket with Model C905 Panel Light)

1 Model	2 Lens Diffusion	3 Lens Color
L92	-C Clear	R Red
	-N Diffused	A Amber
		Y Yellow
		G Green
		B Blue
		W Water Clear
		-S Smoke <sup>[2]</sup>



[1] Hardware Assembled.

[2] Omit Lens Diffusion Code (e.g. L92-S).

### PS90

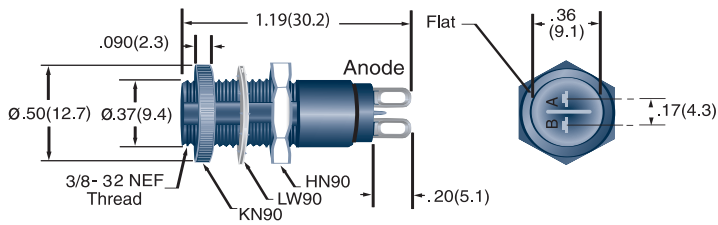

### PS90T

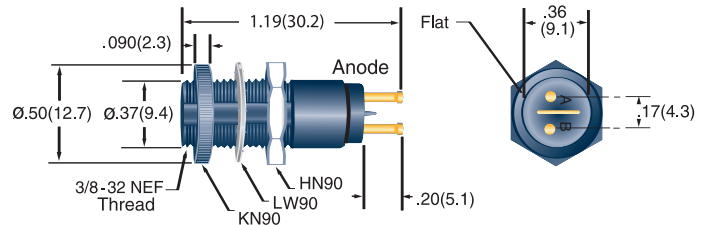

### SH90

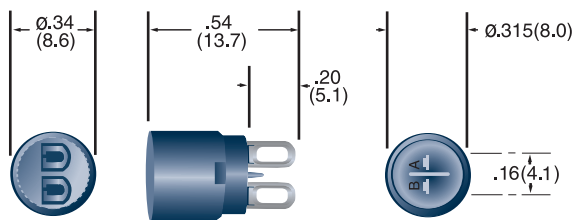

### CSH90

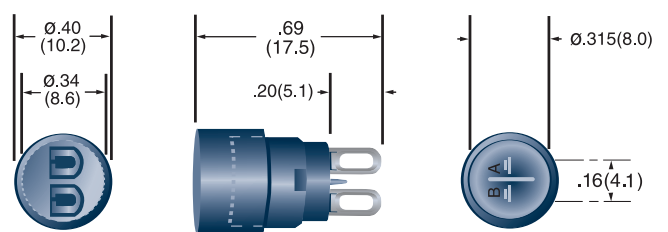

### RC90-B

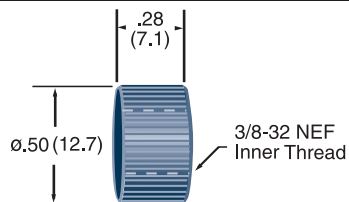

### L92

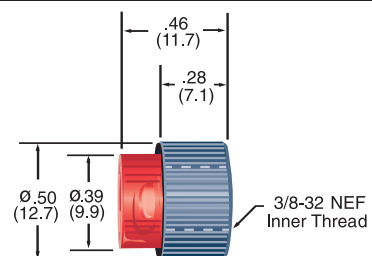

### TC9 & NW9 Mounting Hardware

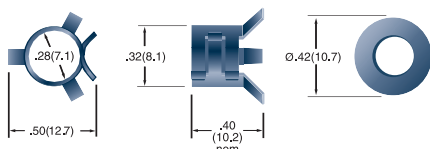

**All dimensions are in inches (mm)**

Tolerances: .xx"(.x) ±.025"(.63) / .xxx"(.xx)±.010"(.25)

Specifications are subject to change without notice.