



Chipsmall Limited consists of a professional team with an average of over 10 year of expertise in the distribution of electronic components. Based in Hongkong, we have already established firm and mutual-benefit business relationships with customers from,Europe,America and south Asia,supplying obsolete and hard-to-find components to meet their specific needs.

With the principle of “Quality Parts,Customers Priority,Honest Operation,and Considerate Service”,our business mainly focus on the distribution of electronic components. Line cards we deal with include Microchip,ALPS,ROHM,Xilinx,Pulse,ON,Everlight and Freescale. Main products comprise IC,Modules,Potentiometer,IC Socket,Relay,Connector.Our parts cover such applications as commercial,industrial, and automotives areas.

We are looking forward to setting up business relationship with you and hope to provide you with the best service and solution. Let us make a better world for our industry!



## Contact us

Tel: +86-755-8981 8866 Fax: +86-755-8427 6832

Email & Skype: info@chipsmall.com Web: www.chipsmall.com

Address: A1208, Overseas Decoration Building, #122 Zhenhua RD., Futian, Shenzhen, China



## Current Transducer LA 305-S

For the electronic measurement of currents: DC, AC, pulsed..., with galvanic isolation between the primary circuit (high power) and the secondary circuit (electronic circuit).



### $I_{PN} = 300 \text{ A}$

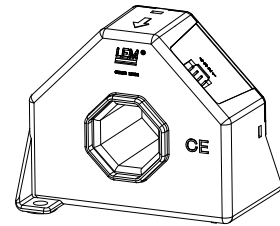

### Electrical data

|          |                                  |                                   |                              |                          |              |              |             |
|----------|----------------------------------|-----------------------------------|------------------------------|--------------------------|--------------|--------------|-------------|
| $I_{PN}$ | Primary nominal current rms      | 300                               | A                            |                          |              |              |             |
| $I_{PM}$ | Primary current, measuring range | 0 .. $\pm 500$                    | A                            |                          |              |              |             |
| $R_M$    | Measuring resistance             | $T_A = 70^\circ\text{C}$          |                              | $T_A = 85^\circ\text{C}$ |              |              |             |
|          |                                  |                                   | $R_{M \min}$                 | $R_{M \max}$             | $R_{M \min}$ | $R_{M \max}$ |             |
|          |                                  | with $\pm 12 \text{ V}$           | @ $\pm 300 \text{ A}_{\max}$ | 0                        | 52           | 0            | 50 $\Omega$ |
|          |                                  |                                   | @ $\pm 500 \text{ A}_{\max}$ | 0                        | 17           | 0            | 15 $\Omega$ |
|          | with $\pm 15 \text{ V}$          | @ $\pm 300 \text{ A}_{\max}$      | 0                            | 75                       | 5            | 73 $\Omega$  |             |
|          |                                  | @ $\pm 500 \text{ A}_{\max}$      | 0                            | 31                       | 5            | 29 $\Omega$  |             |
| $I_{SN}$ | Secondary nominal current rms    | 120                               | mA                           |                          |              |              |             |
| $K_N$    | Conversion ratio                 | 1 : 2500                          |                              |                          |              |              |             |
| $V_C$    | Supply voltage ( $\pm 5 \%$ )    | $\pm 12 \dots 15$                 | V                            |                          |              |              |             |
| $I_C$    | Current consumption              | 20 ( $\pm 15 \text{ V}$ ) + $I_S$ | mA                           |                          |              |              |             |

### Accuracy - Dynamic performance data

|              |  |            |                  |
|--------------|--|------------|------------------|
| $X_G$        | Overall accuracy @ $I_{PN}$ , $T_A = 25^\circ\text{C}$   | $\pm 0.8$  | %                |
| $\epsilon_L$ | Linearity error  | $< 0.1$    | %                |
| $I_O$        | Offset current @ $I_p = 0$ , $T_A = 25^\circ\text{C}$  | Typ        | $\pm 0.20$ mA    |
|              |  | Max        | $\pm 0.20$ mA    |
| $I_{OM}$     | Magnetic offset current <sup>1)</sup> @ $I_p = 0$ and specified $R_M$ , after an overload of $3 \times I_{PN}$ |            | $\pm 0.40$ mA    |
| $I_{OT}$     | Temperature variation of $I_O$ - $10^\circ\text{C} \dots +85^\circ\text{C}$                                    | $\pm 0.12$ | $\pm 0.30$ mA    |
| $t_{ra}$     | Reaction time @ 10 % of $I_{PN}$   | $< 500$    | ns               |
| $t_r$        | Response time <sup>2)</sup> @ 90 % of $I_{PN}$ step  | $< 1$      | $\mu\text{s}$    |
| di/dt        | di/dt accurately followed  | $> 100$    | A/ $\mu\text{s}$ |
| BW           | Frequency bandwidth (-3 dB)  | DC .. 100  | kHz              |

### General data

|       |                               |                            |                  |
|-------|-------------------------------|----------------------------|------------------|
| $T_A$ | Ambient operating temperature | - 10 .. + 85               | $^\circ\text{C}$ |
| $T_S$ | Ambient storage temperature   | - 40 .. + 90               | $^\circ\text{C}$ |
| $R_S$ | Secondary coil resistance     | @ $T_A = 70^\circ\text{C}$ | 35 $\Omega$      |
|       |                               | @ $T_A = 85^\circ\text{C}$ | 37 $\Omega$      |
| $m$   | Mass                          | 200                        | g                |
|       | Standards                     | EN 50178: 1997             |                  |

**Notes:** <sup>1)</sup> The result of the coercive force (Hc) of the magnetic circuit

<sup>2)</sup> With a di/dt of 100 A/ $\mu\text{s}$ .

### Features

- Closed loop (compensated) current transducer using the Hall effect
- Isolated plastic case recognized according to UL 94-V0.

### Advantages

- Excellent accuracy
- Very good linearity
- Low temperature drift
- Optimized response time
- Wide frequency bandwidth
- No insertion losses
- High immunity to external interference
- Current overload capability.

### Applications

- AC variable speed drives and servo motor drives
- Static converters for DC motor drives
- Battery supplied applications
- Uninterruptible Power Supplies (UPS)
- Switched Mode Power Supplies (SMPS)
- Power supplies for welding applications.

### Application domain

- Industrial.

## Current Transducer LA 305-S

### Isolation characteristics

|             |   |      |    |
|-------------|---|------|----|
| $V_d$       | Rms voltage for AC isolation test, 50 Hz, 1 min | 6    | kV |
| $\hat{V}_w$ | Impulse withstand voltage 1.2/50 $\mu$ s        | 20   | kV |
|             |   | Min  |    |
| <b>dCp</b>  | Creepage distance                               | 27   | mm |
| <b>dCI</b>  | Clearance distance                              | 26.5 | mm |
| <b>CTI</b>  | Comparative Tracking Index (group IIIa)         | 225  |    |

### Applications examples

According to EN 50178 and IEC 61010-1 standards and following conditions:

- Over voltage category OV 3
- Pollution degree PD2
- Non-uniform field

|   | EN 50178                 | IEC 61010-1     |
|---|--------------------------|-----------------|
| <b>dCp, dCI, <math>\hat{V}_w</math></b> | Rated insulation voltage | Nominal voltage |
| Single insulation                       | 2500 V                   | 2500 V          |
| Reinforced insulation                   | 1250 V                   | 1250 V          |

According VDE 0160 (1994):      single insulation 3500 V  
    Reinforced insulation 1750 V

### Safety



This transducer must be used in electric/electronic equipment with respect to applicable standards and safety requirements in accordance with the manufacturer's operating instructions.



Caution, risk of electrical shock

When operating the transducer, certain parts of the module can carry hazardous voltage (eg. primary busbar, power supply).

Ignoring this warning can lead to injury and/or cause serious damage.

This transducer is a build-in device, whose conducting parts must be inaccessible after installation.

A protective housing or additional shield could be used.

Main supply must be able to be disconnected.



## Dimensions LA 305-S (in mm)

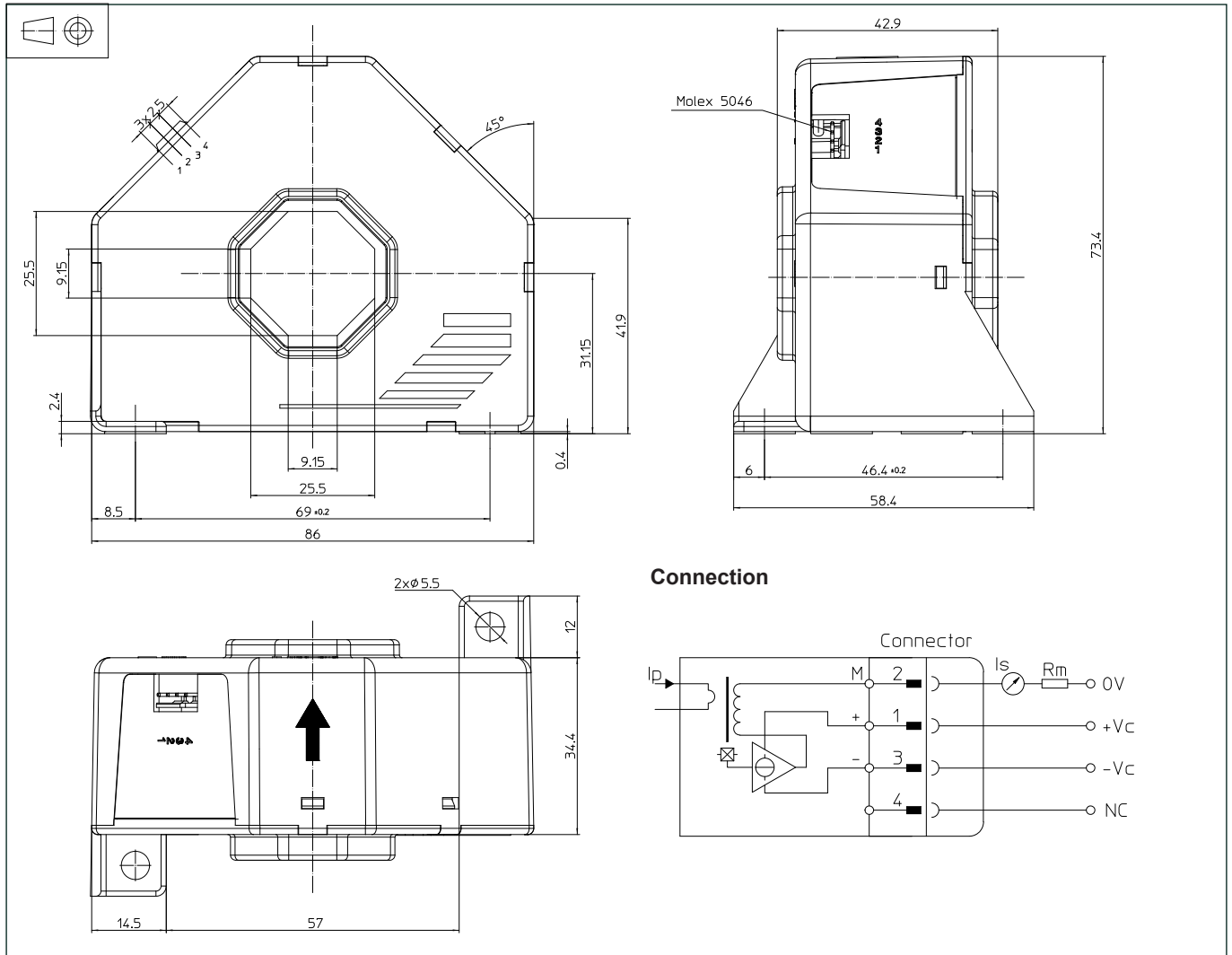

## Mechanical characteristics

- General tolerance  $\pm 0.5$  mm
- Transducer fastening 2 holes  $\varnothing 5.5$   
2 M5 steel screws
- Recommended fastening torque 4 Nm
- Primary through-hole 25.5 x 25.5 mm
- Connection of secondary MOLEX 5046 4 pins  
tin plated

## Remarks

- $I_s$  is positive when  $I_p$  flows in the direction of the arrow.
- Temperature of the primary conductor should not exceed 100°C.
- Dynamic performances ( $di/dt$  and response time) are best with a single bar completely filling the primary hole.
- This is a standard model. For different versions (supply voltages, turns ratios, unidirectional measurements...), please contact us.