



Chipsmall Limited consists of a professional team with an average of over 10 year of expertise in the distribution of electronic components. Based in Hongkong, we have already established firm and mutual-benefit business relationships with customers from,Europe,America and south Asia,supplying obsolete and hard-to-find components to meet their specific needs.

With the principle of "Quality Parts,Customers Priority,Honest Operation,and Considerate Service",our business mainly focus on the distribution of electronic components. Line cards we deal with include Microchip,ALPS,ROHM,Xilinx,Pulse,ON,Everlight and Freescale. Main products comprise IC,Modules,Potentiometer,IC Socket,Relay,Connector.Our parts cover such applications as commercial,industrial, and automotives areas.

We are looking forward to setting up business relationship with you and hope to provide you with the best service and solution. Let us make a better world for our industry!



Contact us

Tel: +86-755-8981 8866 Fax: +86-755-8427 6832

Email & Skype: info@chipsmall.com Web: www.chipsmall.com

Address: A1208, Overseas Decoration Building, #122 Zhenhua RD., Futian, Shenzhen, China



PANDUIT PART NUMBER	CONDUCTOR SIZE	STUD SIZE	OVERALL LENGTH "A" +/- .12	BARREL LENGTH "B" MIN	BARREL		TONGUE WIDTH "W" +/- .060	TONGUE THICKNESS "T" +/- .020	TONGUE LENGTH "P" MIN	HOLE OFFSET "G" +/- .031	STUD HOLE DIA "D" +/- .02	WRENCH CLEARANCE "C" REF	WIRE STRIP LENGTH	PANDUIT DIE COLOR CODE PANDUIT DIE INDEX NUMBER (BURNDY DIE INDEX NUMBER)
					I.D. +/- .010	O.D. +/- .010								
LAA300-38-2 LAA300-12-2	300 kcmil	3/8" 1/2"	4.00	2.25	0.65	1.01	1.38	0.34	1.31	0.63	0.41 0.53	0.68	2-5/16"	BLUE DIE P76 (470)
LAA350-12-2	350 kcmil	1/2"	4.28	2.25	0.72	1.11	1.51	0.38	1.31	0.63	0.53	0.68	2-5/16"	BROWN DIE P87 (299)
LAA400-58-2R	400 kcmil	5/8"	4.88	2.50	0.76	1.19	1.61	0.41	1.25	0.63	0.66	0.62	2-9/16"	GREEN DIE P94 (472)
LAA500-12-2 LAA500-58-2	500 kcmil	1/2" 5/8"	5.50	3.00	0.84	1.32	1.74	0.45	1.50	0.63	0.53 0.66	0.87	3-1/16"	PINK DIE P99 (300)
LAA750-12-1 LAA750-58-1	750 kcmil	1/2" 5/8"	6.50	3.38	1.03	1.59	1.74	0.54	1.88	0.88	0.53 0.66	1.00	3-7/16"	RED DIE P125 (301)
LAA1000-58-1	1000 kcmil	5/8"	7.31	4.50	1.19	1.84	2.56	0.63	1.88	0.88	0.66	1.00	4-3/4"	BROWN DIE P161 (302)

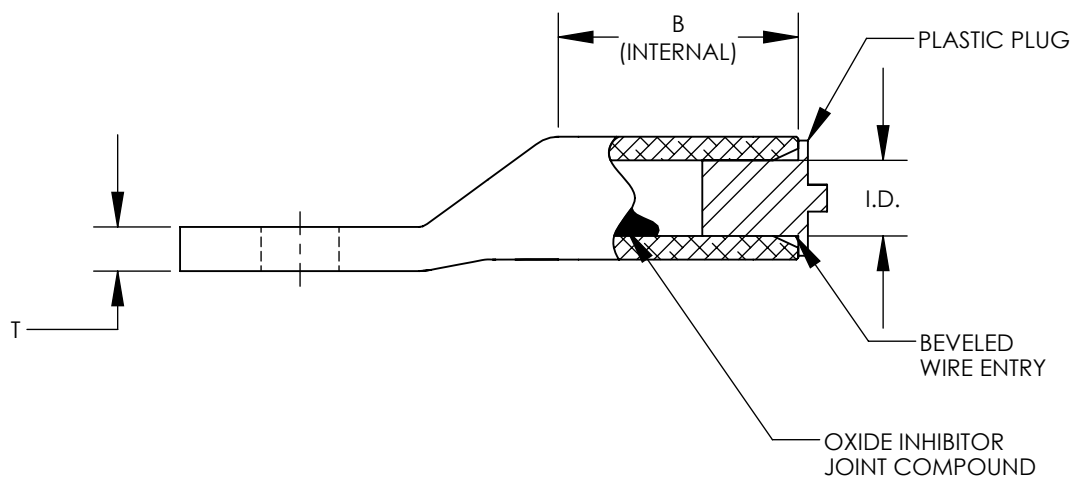
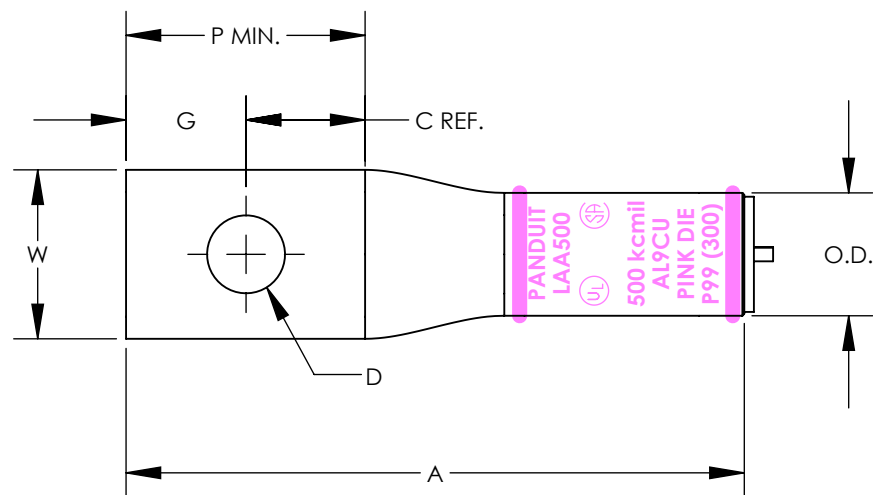

NOTES:

1. MATERIAL: SEAMLESS ALUMINUM TUBING, TIN PLATED
2. BARREL COLOR CODED WITH DIE SET INDEX NUMBER
3. FOR STRANDED ALUMINUM AND COPPER WIRE
4. UL LISTED & CSA CERTIFIED TEMPERATURE RATED 90° C (AL9CU)
5. UL LISTED & CSA CERTIFIED VOLTAGE RATING 35 KV
6. ALL DIMENSIONS IN INCHES



REV	DATE	BY	CHK	APR	DESCRIPTION	ECN
10	7/16	JHNU	JHNU	RGB	REVISED OVERALL LENGTH FOR LAA400-58-2R: 4.88 WAS 4.68	N41129BB-C41129
09	5/16	JHNU	JHNU	RGB	ADDED NOTE TO SPECIFY LAA750-12-1 IS cULus	N41129BB-C41129
08	8/15	JHNU	JHNU	RGB	ADDED "D" DIMENSION	N41129BB-C41129
07	3/15	JHNU	JHNU	RGB	REVISED A DIMENSION: LAA400-58-2R WAS 4.88	N41129BB-C41129
06	3/15	JHNU	JHNU	RGB	REVISED DIMENSIONS, REVISED NOTES ADDED BARREL MARKING ADDED COLOR CODE/DIE INDEX NUMBER REMOVED LAA400-58-2, ADDED LAA400-58-2R	N41129BB-C41129
05	3/13	JHNU	JHNU	RGB	REVISED TITLE BLOCK CONVERTED TO SOLIDWORKS	N41129BB-C41129

TITLE		LAA SERIES 300kcmil-1000kcmil ALUMINUM LUGS CUSTOMER DRAWING	
ITEM REVISION NAME	N41129BB-C41129/10		
DATASET FILE NAME	C41129/10.SLDDRW		
UNLESS OTHERWISE SPECIFIED, DIMENSIONAL TOLERANCES ARE: IN [mm]		MATERIAL	
.X ±	.XXX ±	SEE NOTES	
.XX ±	ANGLES ±	DRAWING NUMBER	
THIRD ANGLE PROJECTION		C41129	
DRAWN BY	DATE	CHK	SCALE
WL	2/93	GRM	NONE
SHEET 1 OF 1			SIZE
			B