



Chipsmall Limited consists of a professional team with an average of over 10 year of expertise in the distribution of electronic components. Based in Hongkong, we have already established firm and mutual-benefit business relationships with customers from,Europe,America and south Asia,supplying obsolete and hard-to-find components to meet their specific needs.

With the principle of “Quality Parts,Customers Priority,Honest Operation,and Considerate Service”,our business mainly focus on the distribution of electronic components. Line cards we deal with include Microchip,ALPS,ROHM,Xilinx,Pulse,ON,Everlight and Freescale. Main products comprise IC,Modules,Potentiometer,IC Socket,Relay,Connector.Our parts cover such applications as commercial,industrial, and automotives areas.

We are looking forward to setting up business relationship with you and hope to provide you with the best service and solution. Let us make a better world for our industry!



Contact us

Tel: +86-755-8981 8866 Fax: +86-755-8427 6832

Email & Skype: info@chipsmall.com Web: www.chipsmall.com

Address: A1208, Overseas Decoration Building, #122 Zhenhua RD., Futian, Shenzhen, China



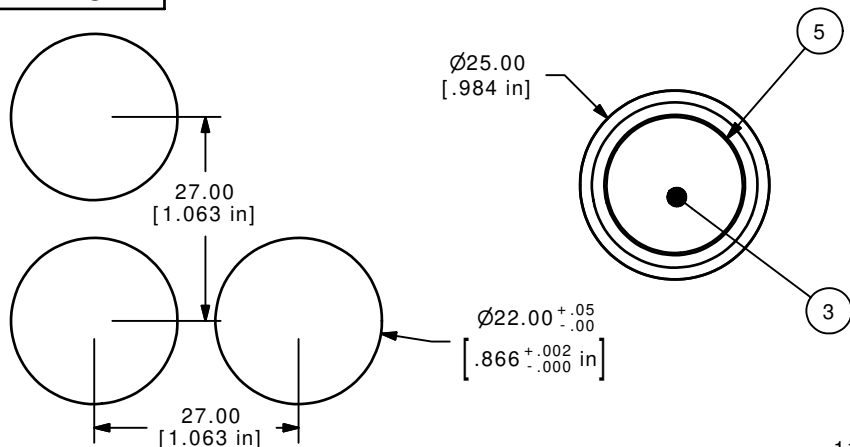

Parts List				
ITEM	QTY	PART NUMBER	DESCRIPTION	
1	1	F060619	LAKEEV11	
2	1	F051601	P16 PLASTIC TERM. PROTECTOR	
3	1	F050422	24VDC GREEN LED	
4	1	F051702	25MM RING	
5	1	F060202	25MM GREEN LENS	

RECOMMEND PANEL MOUNTING

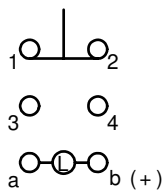

CONTACT CONFIGURATION

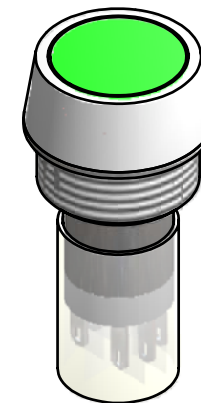
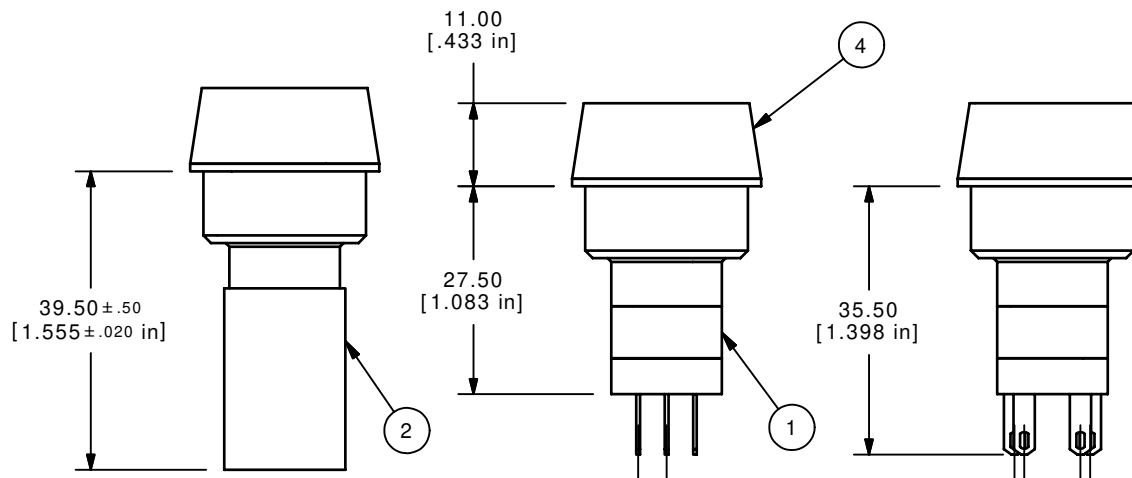

ISOMETRIC

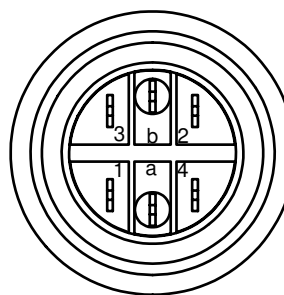

- NOTES:
- ALL DIMENSIONS IN MM [INCH].
 - GENERAL TOLERANCE: 0.0 = ± 0.4
0.00 = ± 0.25
 - TERM. NOS. FOR REF. ONLY.
 - RATING: 5A @250VAC
8A @125VAC
.2A @250VDC
6A @24VDC
 - MECHANICAL LIFE: 2,000,000 MAKE-OR-BREAK CYCLES
 - INSULATION: 1,000 MΩ MIN.
 - DIELECTRIC STRENGTH: 2000V FOR 1 MIN
 - OPERATING TEMP: -25°C TO 55°C
 - LENS COLOR: GREEN
 - LAMP VOLTAGE: 24VDC LED
 - PACKAGE: BOX/20 PER BOX
 - 2002/95/EC (ROHS) COMPLIANT
 - ▲ DENOTES MAJOR DIMENSION.

E-SWITCH®

TITLE LAKEEV11KGRNGRN

A	16899	RELEASED FOR PRODUCTION	1/22/2007	TN
REV	PCR NO	DESCRIPTION	DATE	BY

SCALE	DATE	DR	DWG	REV
1:1	1/22/2007	TN	XF0707P	A

THE INFORMATION CONTAINED IN THIS DOCUMENT IS PROPRIETARY TO E-SWITCH AND IS NOT TO BE COPIED OR TRANSFERRED