



Chipsmall Limited consists of a professional team with an average of over 10 year of expertise in the distribution of electronic components. Based in Hongkong, we have already established firm and mutual-benefit business relationships with customers from,Europe,America and south Asia,supplying obsolete and hard-to-find components to meet their specific needs.

With the principle of “Quality Parts,Customers Priority,Honest Operation,and Considerate Service”,our business mainly focus on the distribution of electronic components. Line cards we deal with include Microchip,ALPS,ROHM,Xilinx,Pulse,ON,Everlight and Freescale. Main products comprise IC,Modules,Potentiometer,IC Socket,Relay,Connector.Our parts cover such applications as commercial,industrial, and automotives areas.

We are looking forward to setting up business relationship with you and hope to provide you with the best service and solution. Let us make a better world for our industry!



Contact us

Tel: +86-755-8981 8866 Fax: +86-755-8427 6832

Email & Skype: info@chipsmall.com Web: www.chipsmall.com

Address: A1208, Overseas Decoration Building, #122 Zhenhua RD., Futian, Shenzhen, China



ALL DIMENSIONS ARE IN (mm)														
Part Number	Wire Size	Wire Class	Stud Size	Wire Strip Length	$l \pm 2.76$	$o \pm .50$	$i \pm .50$	$a \pm 2.25$	m (ref)	$c \pm .50$	n	$d \pm .50$	b	t
LCMDX10-8-Q	10 mm ²	5f & 6f	M8	16.0	79.0	7.20	5.50	14.5	10.3	44.50	6.5±1.25	9.00	13.0±1.25	1.20±.40
LCMDX16-8-Q	16 mm ²	5f & 6f	M8	16.5	81.5	8.80	6.90	15.0	10.0	44.50	8.0±1.25	9.00	15.5±1.25	1.60±.40
LCMDX25-8-Q	25 mm ²	5f & 6f	M8	19.0	86.5	10.40	8.20	17.5	12.3	44.50	8.5±2.25	9.00	15.5±2.25	2.05±.40
LCMDX25-10-Q	25 mm ²	5f & 6f	M10	19.0	86.5	10.40	8.20	17.5	12.3	44.50	8.5±2.25	11.00	15.5±2.25	2.05±.40
LCMDX25-12-Q	25 mm ²	5f & 6f	M12	19.0	92.5	10.40	8.20	17.5	14.5	44.50	11.5±2.25	14.00	21.5±2.25	1.50±.40
LCMDX35-10-Q	35 mm ²	5f & 6f	M10	21.8	91.0	12.30	9.80	20.3	11.5	44.50	10.0±2.25	11.00	18.0±2.25	2.50±.40
LCMDX35-12-Q	35 mm ²	5f & 6f	M12	21.8	94.5	12.30	9.80	20.3	14.0	44.50	11.0±2.25	14.00	23.0±2.25	1.80±.40
LCMDX50-10-X	50 mm ²	5f & 6f	M10	24.8	98.0	14.20	11.50	23.3	14.5	44.50	11.5±2.25	11.00	20.8±2.25	2.85±.40
LCMDX50-12-X	50 mm ²	5f & 6f	M12	24.8	98.0	14.20	11.50	23.3	14.5	44.50	11.5±2.25	14.00	20.8±2.25	2.80±.40
LCMDX70-10-X	70 mm ²	5f & 6f	M10	26.0	105.0	16.50	13.50	24.5	15.0	44.50	13.5±2.25	11.00	24.5±2.25	3.00±.40
LCMDX70-12-X	70 mm ²	5f & 6f	M12	26.0	105.0	16.50	13.50	24.5	15.0	44.50	13.5±2.25	14.00	24.5±2.25	3.00±.40
LCMDX95-12-X	95 mm ²	5f & 6f	M12	26.0	109.5	18.60	15.20	24.5	15.5	44.50	14.5±2.25	14.00	27.5±2.25	3.50±.45
LCMDX95-14-X	95 mm ²	5f & 6f	M14	26.0	109.5	18.60	15.20	24.5	15.5	44.50	14.5±2.25	16.00	27.5±2.25	3.40±.45
LCMDX120-12-X	120 mm ²	5f & 6f	M12	29.0	115.0	21.00	16.50	27.5	18.0	44.50	16.5±2.25	14.00	30.5±2.25	4.45±.45
LCMDX120-14-X	120 mm ²	5f & 6f	M14	29.0	118.5	21.00	16.50	27.5	22.0	44.50	16.5±2.25	16.00	30.5±2.25	4.30±.45
LCMDX150-12-X	150 mm ²	5f & 6f	M12	29.7	117.0	23.00	18.60	28.2	16.5	44.50	17.5±2.25	14.00	33.5±2.25	4.55±.50
LCMDX150-14-X	150 mm ²	5f & 6f	M14	29.7	121.5	23.00	18.60	28.2	21.0	44.50	17.5±2.25	16.00	33.5±2.25	4.40±.50
LCMDX185-12-X	185 mm ²	5f & 6f	M12	36.5	131.0	26.00	20.80	35.0	21.0	44.50	19.5±2.25	14.00	37.5±2.25	5.30±.50
LCMDX185-14-X	185 mm ²	5f & 6f	M14	36.5	131.0	26.00	20.80	35.0	21.0	44.50	19.5±2.25	16.00	37.5±2.25	5.30±.50
LCMDX240-12-5	240 mm ²	5f & 6f	M12	41.8	139.0	29.00	23.50	40.3	22.0	44.50	20.0±2.25	14.00	42.5±2.25	5.40±.55
LCMDX240-14-5	240 mm ²	5f & 6f	M14	41.8	139.0	29.00	23.50	40.3	22.0	44.50	20.0±2.25	16.00	42.5±2.25	5.40±.55
LCMDX300-12-5	300 mm ²	5f	M12	46.3	151.5	33.00	26.20	44.8	26.5	44.50	23.5±2.25	14.00	48.0±2.25	6.70±.55
LCMDX300-14-5	300 mm ²	5f	M14	46.3	151.5	33.00	26.20	44.8	26.5	44.50	23.5±2.25	16.00	48.0±2.25	6.70±.55

- NOTES: 1. Material: High conductivity seamless copper tube.
 2. Plating: Parts are annealed and tin plated.
 3. WireType: Class 5 and 6 Flexible Stranded Copper Conductor per DIN VDE 0295, IEC 60228, and HD 383.
 4. UL Listed & CSA Certified Wire Connectors for applications up to 35kv, when crimped per instruction sheet included with Panduit packaging. Consult cable manufacturer for voltage stress relief instructions with applications greater than 2000 volts.
 5. UL & CSA Temperature Rating: 90°C

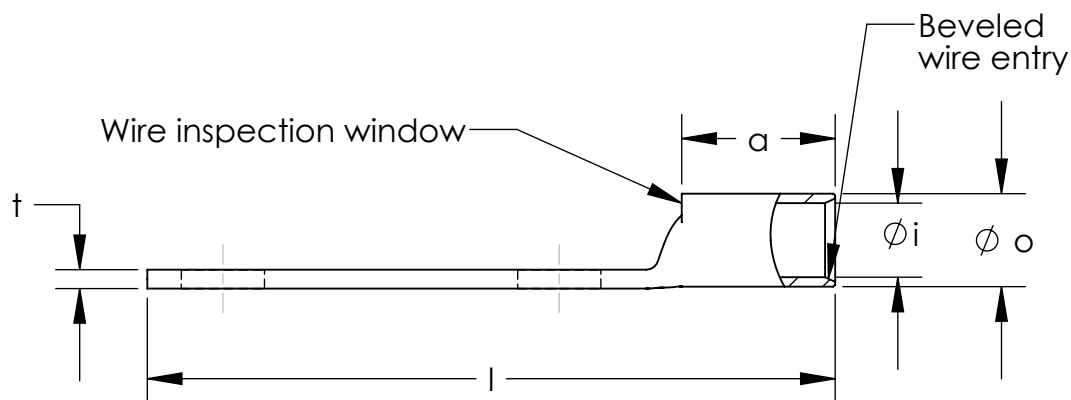
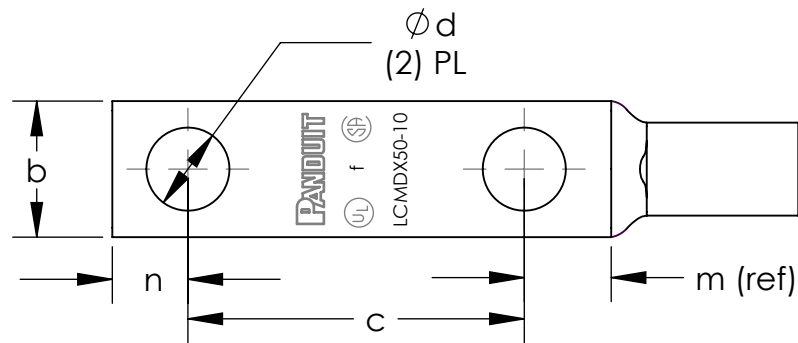

LISTED Wire Connector



CERTIFIED

PANDUIT CORP. TINLEY PARK, ILLINOIS
 METRIC FLEX LUGS - LCMDX SERIES 10-300mm²
 CUSTOMER DRAWING

UNLESS OTHERWISE SPECIFIED
 DIMENSIONAL TOLERANCES ARE:
 (.X) ± (XXX) ±
 (.XX) ± ANGLES ±

UNLESS OTHERWISE SPECIFIED,
 ALL DIMENSIONS ARE GIVEN IN
 INCHES, THIRD ANGLE PROJECTION

DRAWN BY TLCO
 DATE 5/11
 CHK'D TLCO

MAT'L:

SEE NOTES ABOVE

SCALE NONE
 DRAWING NO / CAD FILE DWG B SIZE
 10N014BB-NC

00	11/12	TLCO	TLCO	DRAWING RELEASED	10N014BB-NC	RGB	RGB
REV	DATE	BY	CHK	DESCRIPTION	ECN	-R	SUP