



Chipsmall Limited consists of a professional team with an average of over 10 year of expertise in the distribution of electronic components. Based in Hongkong, we have already established firm and mutual-benefit business relationships with customers from,Europe,America and south Asia,supplying obsolete and hard-to-find components to meet their specific needs.

With the principle of "Quality Parts,Customers Priority,Honest Operation,and Considerate Service",our business mainly focus on the distribution of electronic components. Line cards we deal with include Microchip,ALPS,ROHM,Xilinx,Pulse,ON,Everlight and Freescale. Main products comprise IC,Modules,Potentiometer,IC Socket,Relay,Connector.Our parts cover such applications as commercial,industrial, and automotives areas.

We are looking forward to setting up business relationship with you and hope to provide you with the best service and solution. Let us make a better world for our industry!



Contact us

Tel: +86-755-8981 8866 Fax: +86-755-8427 6832

Email & Skype: info@chipsmall.com Web: www.chipsmall.com

Address: A1208, Overseas Decoration Building, #122 Zhenhua RD., Futian, Shenzhen, China



THIS COPY IS PROVIDED ON A RESTRICTED BASIS AND IS NOT TO BE USED IN ANY WAY DETRIMENTAL TO THE INTERESTS OF PANDUIT CORP.

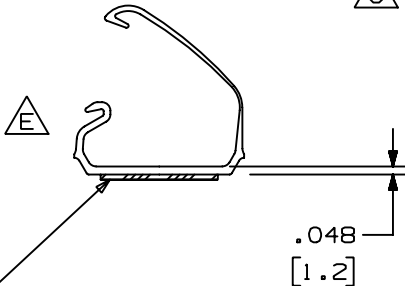
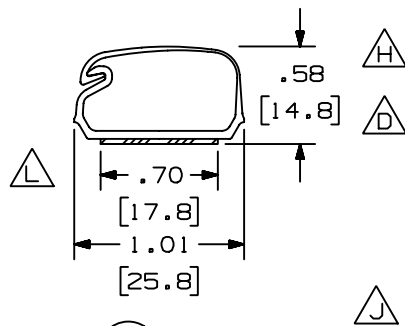

ADHESIVE BACKING
PRESSURE SENSITIVE
FOAM .040 (1.0) THICK
WITH PROTECTIVE LINER.
OPEN VIEW

PART NAME	PANDUIT PART NUMBER (SEE NOTE 1)	LENGTH IN. (MM.)	STATIC LOAD (SEE NOTE 2)	APPROX. WEIGHT
LATCHING DUCT	LD5**6-A	72.0±.09 (1829±2.3)	Δ F .39 lbs/in (7.0 g/mm)	Δ G .089 lbs/ft (.133 g/mm)
	LD5**8-A	96.0±.09 (2438±2.3)	.39 lbs/in (7.0 g/mm)	.089 lbs/ft (.133 g/mm)
	LD5**10-A	120.0±.09 (3048±2.3)	.39 lbs/in (7.0 g/mm)	.089 lbs/ft (.133 g/mm)
	LD5**2-A	78.74±.09 (2000.0±2.3)	.39 lbs/in (7.0 g/mm)	.089 lbs/ft (.133 g/mm)
	LD5**3-A	118.11±.09 (3000.0±2.3)	.39 lbs/in (7.0 g/mm)	.089 lbs/ft (.133 g/mm)

NOTES:



- SEE CURRENT CATALOG FOR ADDITIONAL PART NUMBER SUFFIXES TO INDICATE COLOR AND OR PACKAGE QUANTITY.
- PART IS DESIGNED TO SUPPORT MAXIMUM WEIGHT ON A CLEAN, DRY, SMOOTH SURFACE. THE SURFACE MUST BE PROPERLY PREPARED IN ACCORDANCE WITH PANDUIT RECOMMENDATIONS.
- TO APPLY PART:
 - REMOVE PROTECTIVE LINER.
 - PLACE PART IN DESIRED LOCATION.
 - APPLY PRESSURE TO FLAT SURFACE OF PART.

NO WARRANTY, EXPRESSED OR IMPLIED, IS MADE BY PANDUIT WITH RESPECT TO ADHESIVE BOND PERFORMANCE. AMONG OTHER THINGS, THE CONDITIONS UNDER WHICH THESE MOUNTS MAY BE APPLIED AND/OR THE SURFACE TO WHICH THEY MAY BE APPLIED ARE BEYOND PANDUIT'S CONTROL.

DIMENSIONS IN PARENTHESES ARE IN METRIC.

14	6-12-03	JBN	RMH	M. CAD FILE WAS D15247BA_LD5_01 L. REVISED TAPE WIDTH: WAS .80 (20.3)	SS-15247	RGRO	RGRO			CAD FILENAME/LAYERS Δ M Δ I D15247BA_DC_LD5_02A.PRT
13	11-19-98	DW	HIW	K. REVISED NOTE 2. J. ADDED LD5**2-A AND LD5**3-A TO CHART.	SS-15247	HIW	HIW			PANDUIT CORP. TINLEY PARK, ILLINOIS
12	2-13-98	PM	HIW	I. FILE NAME WAS WPXD-LATCHING-DUCT-2 H. REVISED CHART AND NOTES	SS-15247	HIW	HIW			
-	-----	--	--	G. REV'D WEIGHT: WAS .070 LB/FT .104 G/MM	-----	--	--			LATCHING DUCT (LD5) CUSTOMER DRAWING
11	1-20-97	JBA	CEF	F. REV'D STATIC LOAD: WAS .46. E. REV'D DUCT TO SHOW NEW DESIGN.	SS-15247	CEF	CEF			
-	-----	--	--	D. OMIT LATCHING CLIP LC5-A FROM DWG. REFER TO 34348-1 FOR LATCH CLIP DWG.	-----	--	--			
10	4-24-92	DEW	CEF	C. REV'D NOTE 1 AND OMIT COLOR FROM DWG. B. ADDED THCKNESS DIMENSION .043.	SS-15247	CEF				UNLESS OTHERWISE SPECIFIED, DIMENSIONAL TOLERANCES ARE: (.X) ± (.XXX) ± .010(.3) (.XX) ± .03(.8) ANGLES ±
9	11-25-87	LDB	WJB	A. ADDED PARTS LD5E1-A & LD5L16-A.	SS-15247					UNLESS OTHERWISE SPECIFIED, ALL DIMENSIONS ARE GIVEN IN INCHES, THIRD ANGLE PROJECTION.
8	2-12-87	RN		REVISED AND REDRAWN	SS-15247					DRAWN BY RS
REV	DATE	BY	CHK	DESCRIPTION	ECN	CHK	CUST	SUP		MAT'L: RIGID PVC (POLYVINYL CHLORIDE)
										SCALE NONE
										DRAWING NO. SS-15247
										DWG SIZE A