



Chipsmall Limited consists of a professional team with an average of over 10 year of expertise in the distribution of electronic components. Based in Hongkong, we have already established firm and mutual-benefit business relationships with customers from,Europe,America and south Asia,supplying obsolete and hard-to-find components to meet their specific needs.

With the principle of "Quality Parts,Customers Priority,Honest Operation,and Considerate Service",our business mainly focus on the distribution of electronic components. Line cards we deal with include Microchip,ALPS,ROHM,Xilinx,Pulse,ON,Everlight and Freescale. Main products comprise IC,Modules,Potentiometer,IC Socket,Relay,Connector.Our parts cover such applications as commercial,industrial, and automotives areas.

We are looking forward to setting up business relationship with you and hope to provide you with the best service and solution. Let us make a better world for our industry!



Contact us

Tel: +86-755-8981 8866 Fax: +86-755-8427 6832

Email & Skype: info@chipsmall.com Web: www.chipsmall.com

Address: A1208, Overseas Decoration Building, #122 Zhenhua RD., Futian, Shenzhen, China



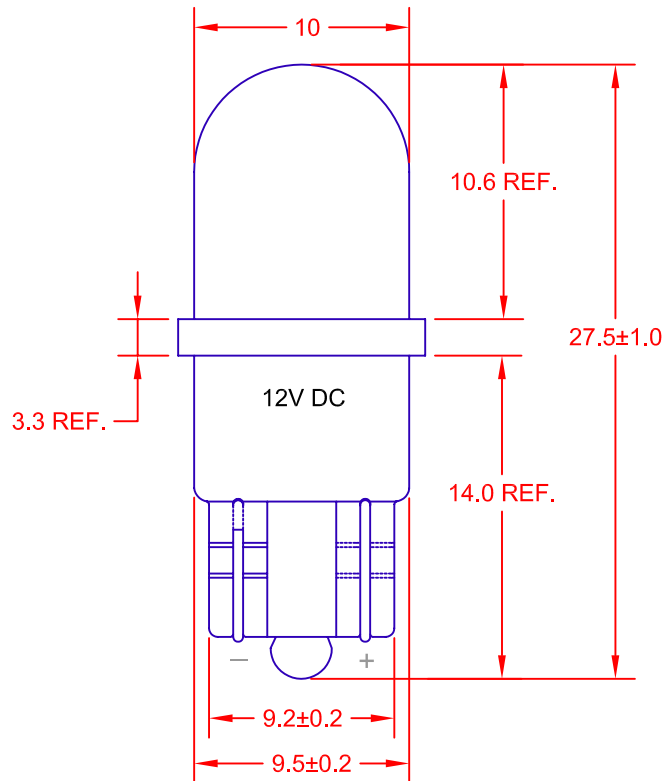

NOTES:

1. LED includes integrated diode for reverse voltage protection.
2. LED includes integrated resistor for current limiting.

Operating Temperature Range	-30°C to +85°C
Storage Temperature Range	-40°C to +100°C

TYPICAL ELECTRICAL & OPTICAL OPERATING CHARACTERISTICS

(Ta = 25 degree C)

PART NUMBER	EMITTING COLOR	AMPERAGE mA	VOLTAGE Vdc	LUMENS	μW/cm ²	DOMINANT WAVELENGTH	VIEWING ANGLE DEGREES
LE-0503-03R	RED	15mA	12.0	0.70	—	630nm	20
LE-0503-03Y	YELLOW	15mA	12.0	0.70	—	595nm	20
LE-0503-03G	GREEN	15mA	12.0	2.00	—	525nm	20
LE-0503-03B	BLUE	15mA	12.0	0.70	—	470nm	20
LE-0503-03W	9000°K WHITE	15mA	12.0	2.50	—	x = 0.30 y = 0.29	20
LE-0503-03UV	ULTRA VIOLET	15mA	12.0	—	235	405	20

<p>METRIC DIMENSIONS ARE IN MILLIMETERS TOLERANCE UNLESS OTHERWISE SPECIFIED 1 PL +/- 0.2 2 PL +/- 0.20 ANGLE +/- 0</p>	<p>JKL COMPONENTS CORPORATION</p> <p>TITLE T-3 1/4 WEDGE BASE LED</p>		<p>SIZE A FSCM NO. 55335</p>		<p>DRAWING NO. LE-0503-03</p>		
			<p>SCALE NONE</p>		<p>RELEASED DATE 7/03/06</p>		<p>REVISION DATE 6/16/10</p>
<p>REV. NO. DESCRIPTION/ECO NUMBER</p>		<p>APPVD DATE</p>		<p>MANUAL REVISIONS NOT PERMITTED</p>		<p>REV. NO. E SHEET 1 OF 1</p>	

E	ADD 9000° WHITE	6/16/10
D	CHANGE MOL TO 27.5 ± 1.0	1/22/09
C	CHANGE CHARTS	8/25/08
B	ADDITIONAL ELECT INFO & CHNG DIMS	8/11/08
A	CHNG. LUMENS & ADD NOTES 1 & 2	9/14/06
	ENGR RELEASE & CANCEL PL-0503-03-1 TO -6	3/3/05