



Chipsmall Limited consists of a professional team with an average of over 10 year of expertise in the distribution of electronic components. Based in Hongkong, we have already established firm and mutual-benefit business relationships with customers from,Europe,America and south Asia,supplying obsolete and hard-to-find components to meet their specific needs.

With the principle of “Quality Parts,Customers Priority,Honest Operation,and Considerate Service”,our business mainly focus on the distribution of electronic components. Line cards we deal with include Microchip,ALPS,ROHM,Xilinx,Pulse,ON,Everlight and Freescale. Main products comprise IC,Modules,Potentiometer,IC Socket,Relay,Connector.Our parts cover such applications as commercial,industrial, and automotives areas.

We are looking forward to setting up business relationship with you and hope to provide you with the best service and solution. Let us make a better world for our industry!



Contact us

Tel: +86-755-8981 8866 Fax: +86-755-8427 6832

Email & Skype: info@chipsmall.com Web: www.chipsmall.com

Address: A1208, Overseas Decoration Building, #122 Zhenhua RD., Futian, Shenzhen, China



THIS DRAWING IS A CONTROLLED DOCUMENT FOR SOURIAU USA, INC. CONTACT THE DOCUMENT CONTROL CENTER FOR THE LATEST REVISION.

C

B

THE INFORMATION CONTAINED IN THIS DRAWING IS CONFIDENTIAL AND MAY NOT BE DISCLOSED WITHOUT WRITTEN CONSENT FROM SOURIAU USA, INC.

4 3 2 1

DWG. NO.
SC52453

PLATING TABLE	
CATALOG NUMBER	PLATE PER SOURIAU SPEC F450
LRM16W - 2F51	TYPE 51 GOLD OVER SILVER
LRM16W - 2F74	TYPE 74 - RHODIUM OVER SILVER
LRM16W - 2DB6	TYPE DB6-HARD GOLD OVER SOFT GOLD OVER COPPER
LRM16W - 2DE5	TYPE DE5 GOLD OVER COPPER
LRM16W - 2F63	TYPE F63 GOLD OVER SILVER
LRM16W - 2D29	TYPE D29-HARD GOLD OVER SILVER

NOTES:
 COLOR CODE:
 1 BLUE DENOTES #16 SIZE WIRE BARREL.
 2 RED DENOTES #20 SIZE MATING END.
 MATERIAL:
 BRASS
 FINISH:
 SEE TABLE

D

C

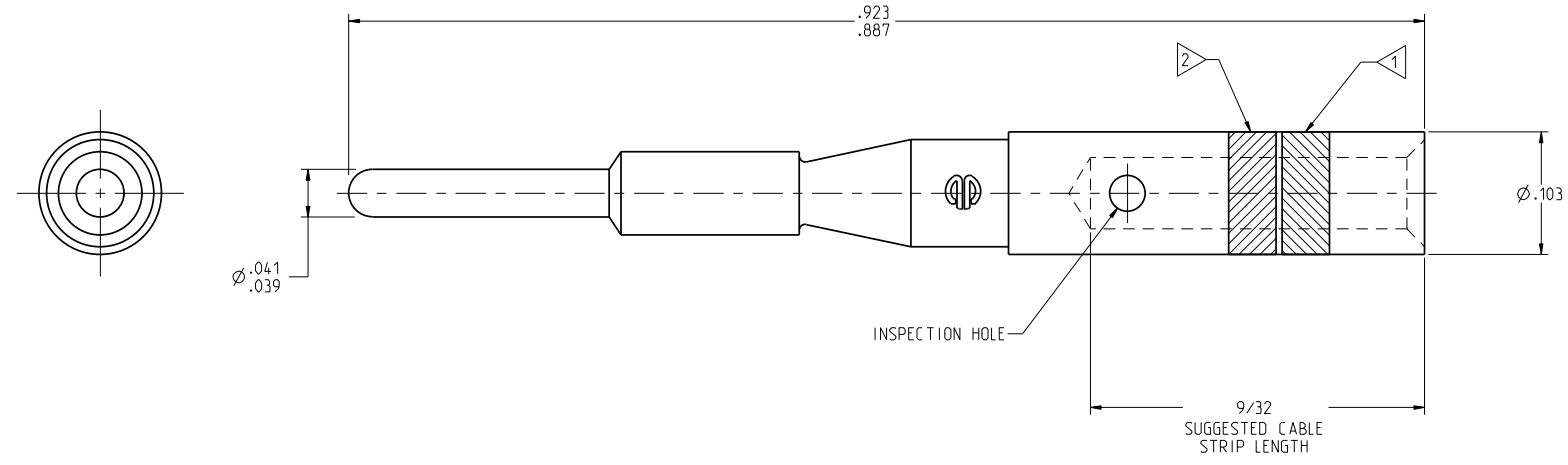

ACCOMMODATES	CRIMPING TOOL	EXTRACTION TOOL
#16, 18, 20 PER MIL-W-16878 TYPE E MIL-W-5086 MIL-W-27300	M10S TOOL S-7-1 DIE SET SL-44 POSITIONER	RX20-24

P	REVISED PER ECN10186	GRB 01-18-07	FLR 01-18-07
13	ADDED SPACE BETWEEN ADJACENT COLOR BAND (ECN 161)	ZD 10-08-81	DN 10-08-81
12	LRM16W-2F72-F72 RHODIUM NICKEL OVER GOLD REMOVED FROM PLATING TABLE (ECB 3613)	LH 06-10-76	SFP 09-03-76
11	LRM16W-2F72 ADDED (ECB2379)	MRP 09-03-76	SFP 09-03-76
10	S-7-1 DIE SET WAS S-7 DIE SET (ECB 2355)	MRT 04-07-76	DL 04-07-76
9	LRM16W-2D29 ADDED (ECB2246)	HE DL 08-07-75	DL 08-07-75
8	F63 PLATING ADDED (ECB 1987)	HC 06-27-73	DE 006-27-73
7	DES PLATING ADDED (ECB 1695)	RWV 05-30-72	RWV 05-30-72
6	ADDED COLOR CODE (ECB1061)	PJB RWV 03-10-70	RWV 03-10-70
5	ADDED TYPE DB4 TO PLATING TABLE (ECB1014)	JC 16-11-69	RVV 16-11-69
4	ADDED TYPE F74 TO PLATING (EC338500)	RLC 09-29-66	RLC 09-29-66
3	USED IN SMOOTH BANTAM NOTE ADDED	SM AFR 10-06-64	AFR 10-06-64
2	MS3190, MS3192, REMOVED (EC28252)	TMM 06-19-63	TMM 06-19-63
1	TABLE ADDED (EC27717)	TMM 03-29-63	WNT 03-29-63
REV	ECN NUMBER	BY DATE	CHKD DATE

B

REFERENCE : FD52452

LINEAR MEASURE:	<input type="checkbox"/> INCH <input type="checkbox"/> INCH (mm)
THIRD ANGLE PROJECTION	
TOLERANCES UNLESS OTHERWISE SPECIFIED	
No. OF PLACES	INCH (mm)
ONE PLACE	±.1 (±.3)
TWO PLACES	±.02 (±0.5)
THREE PLACES	±.010 (±0.25)
ANGLES ±1°	

DRAWING TITLE
SMOOTH CONTACT HYFEN PIN

CAT NO. **LRM16W-2 (SEE TABLE)**

CAGE NO: 09922 SIZE: C

CUSTOMER

www.souriau.com

INTERPRET THIS DRAWING IN ACCORDANCE WITH ASME Y14.5M - 1994.

DRAWN:	GRB	01-18-07
CHKD:	FLR	01-18-07
DSGN:	GRB	01-18-07
MFG:	RR	01-18-07
QC:	DK	01-18-07
DRAWING SCALE: 10:1		
DRAWING NO.	REV	
SC52453	P	
1 OF 1		

A

4

3

2

1

PRO-E