



Chipsmall Limited consists of a professional team with an average of over 10 year of expertise in the distribution of electronic components. Based in Hongkong, we have already established firm and mutual-benefit business relationships with customers from,Europe,America and south Asia,supplying obsolete and hard-to-find components to meet their specific needs.

With the principle of “Quality Parts,Customers Priority,Honest Operation,and Considerate Service”,our business mainly focus on the distribution of electronic components. Line cards we deal with include Microchip,ALPS,ROHM,Xilinx,Pulse,ON,Everlight and Freescale. Main products comprise IC,Modules,Potentiometer,IC Socket,Relay,Connector.Our parts cover such applications as commercial,industrial, and automotives areas.

We are looking forward to setting up business relationship with you and hope to provide you with the best service and solution. Let us make a better world for our industry!



## Contact us

Tel: +86-755-8981 8866 Fax: +86-755-8427 6832

Email & Skype: info@chipsmall.com Web: www.chipsmall.com

Address: A1208, Overseas Decoration Building, #122 Zhenhua RD., Futian, Shenzhen, China



**Tyco / Electronics**  
**Raychem Circuit Protection**  
 308 Constitution Drive  
 Menlo Park, CA 94025-1164  
 Phone: 800-227-4856  
 Fax: 800-227-4866

**PolySwitch®**  
**PTC Devices**  
 Overcurrent Protection Device

**PRODUCT: LTP260**

DOCUMENT: SCD 23012  
 PCN: 054466  
 REV LETTER: F  
 REV DATE: MAY 25, 2005  
 PAGE NO.: 1 OF 1

**Specification Status: Released**

**Electrical Rating**

**Voltage: 24V MAX**  
**Current: 100A MAX**

**Leads:**

Nickel: 0.125 mm nom

**Tape:**

Polyester

**Marking:**

- Manufacturer's Mark
- XX L26 — Part Identification
- — Lot Identification

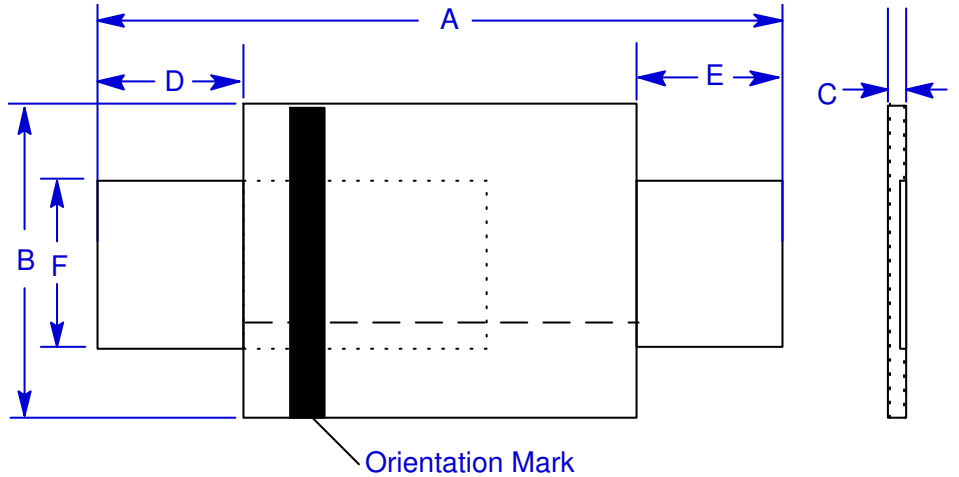

**TABLE I. DIMENSIONS:**

	A		B		C		D		E		F		G	
	MIN	MAX	MIN	MAX	MIN	MAX	MIN	MAX	MIN	MAX	MIN	MAX	MIN	MAX
mm:	24.0	26.0	10.8	11.9	0.6	1.0	5.0	7.0	5.0	7.0	5.9	6.1	--	--
in*:	(0.94)	(1.02)	(0.43)	(0.47)	(0.02)	(0.04)	(0.20)	(0.28)	(0.20)	(0.28)	(0.23)	(0.24)	--	--

\*Rounded off approximation

**TABLE II. PERFORMANCE RATINGS:**

I HOLD	CURRENT TRIP LIMITS								TIME TO TRIP		REFERENCE RESISTANCE		ONE-HOUR POST-TRIP RESISTANCE		TRIPPED-STATE POWER DISSIPATION
	AMPS AT 0°C		AMPS AT 20°C		AMPS AT 60°C		AMPS AT 80°C		SECONDS AT 20°C, 13 A		OHMS AT 20°C		OHMS AT 20°C		
HOLD	HOLD	TRIP	HOLD	TRIP	HOLD	TRIP	HOLD	TRIP	TYP	MAX	MIN	MAX	TYP	MAX	WATTS AT 20°C, 24V MAX
2.6	3.1	6.2	2.6	5.2	1.4	2.8	0.8	1.6	2	5	0.025	0.042	0.055	0.076	2.3

**Reference Documents:**

PS300

**Precedence:**

This specification takes precedence over documents referenced herein.

**Effectivity:**

Reference documents shall be the issue in effect on the date of invitation for bid.

**CAUTION:**

Operation beyond the rated voltage or current may result in rupture, electrical arcing or flame.