



Chipsmall Limited consists of a professional team with an average of over 10 year of expertise in the distribution of electronic components. Based in Hongkong, we have already established firm and mutual-benefit business relationships with customers from,Europe,America and south Asia,supplying obsolete and hard-to-find components to meet their specific needs.

With the principle of “Quality Parts,Customers Priority,Honest Operation,and Considerate Service”,our business mainly focus on the distribution of electronic components. Line cards we deal with include Microchip,ALPS,ROHM,Xilinx,Pulse,ON,Everlight and Freescale. Main products comprise IC,Modules,Potentiometer,IC Socket,Relay,Connector.Our parts cover such applications as commercial,industrial, and automotives areas.

We are looking forward to setting up business relationship with you and hope to provide you with the best service and solution. Let us make a better world for our industry!



Contact us

Tel: +86-755-8981 8866 Fax: +86-755-8427 6832

Email & Skype: info@chipsmall.com Web: www.chipsmall.com

Address: A1208, Overseas Decoration Building, #122 Zhenhua RD., Futian, Shenzhen, China



Tyco / Electronics
Raychem Circuit Protection
 308 Constitution Drive
 Menlo Park, CA 94025-1164
 Phone: 800-227-4856
 Fax: 800-227-4866

PolySwitch®
PTC Devices
 Overcurrent Protection Device

PRODUCT: LTP300

DOCUMENT: SCD 22716
 PCN: 755724
 REV LETTER: G
 REV DATE: APRIL 9, 2001
 PAGE NO.: 1 OF 1

Specification Status: Released

Electrical Rating
Voltage: 24V MAX
Current: 100A MAX

Leads:
 Nickel: 0.125 mm nom.

Tape:
 Polyester

Marking:
 _____ Manufacturer's Mark
 ✕ L30 _____ Part Identification
 □ □ □ □ _____ Lot Identification

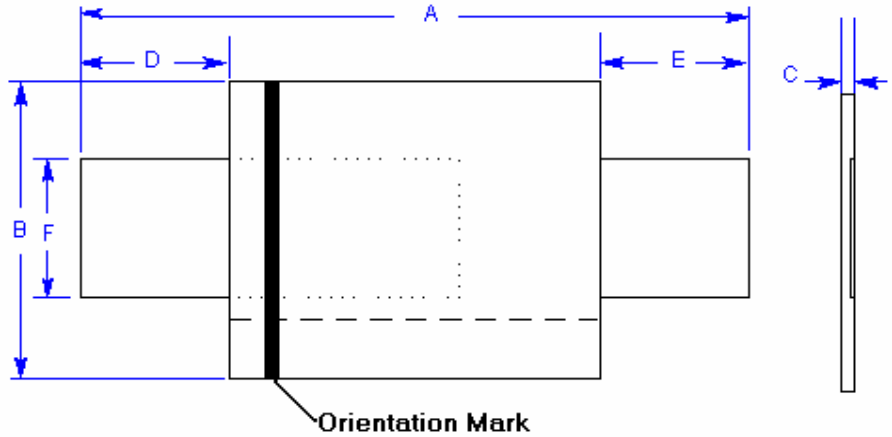

TABLE I. DIMENSIONS:

	A		B		C		D		E		F	
	MIN	MAX	MIN	MAX	MIN	MAX	MIN	MAX	MIN	MAX	MIN	MAX
mm:	28.4	31.8	13.0	13.5	0.5	1.1	6.3	8.9	6.3	8.9	6.0	6.6
in*:	(1.12)	(1.25)	(0.51)	(0.53)	(0.02)	(0.04)	(0.25)	(0.35)	(0.25)	(0.35)	(0.24)	(0.26)

*Rounded off approximation

TABLE II. PERFORMANCE RATINGS:

I HOLD	CURRENT TRIP LIMITS								TIME TO TRIP		REFERENCE RESISTANCE		ONE-HOUR POST-TRIP RESISTANCE		TRIPPED-STATE POWER DISSIPATION	
	AMPS AT 0°C		AMPS AT 20°C		AMPS AT 60°C		AMPS AT 80°C		SECONDS AT 20°C, 15 A		OHMS AT 20°C		OHMS AT 20°C		WATTS AT 20°C, 24V	
HOLD	HOLD	TRIP	HOLD	TRIP	HOLD	TRIP	HOLD	TRIP	TYP	MAX	MIN	MAX	TYP	MAX	TYP	MAX
3.0	3.7	7.7	3.0	6.3	1.6	3.8	0.9	2.1	2.0	4.0	0.015	0.031	0.040	0.055	1.7	2.0

Reference Documents: PS300
 Precedence: This specification takes precedence over documents referenced herein.
 Effectivity: Reference documents shall be the issue in effect on the date of invitation for bid.
 CAUTION: Operation beyond the rated voltage or current may result in rupture, electrical arcing or flame.