



Chipsmall Limited consists of a professional team with an average of over 10 year of expertise in the distribution of electronic components. Based in Hongkong, we have already established firm and mutual-benefit business relationships with customers from,Europe,America and south Asia,supplying obsolete and hard-to-find components to meet their specific needs.

With the principle of “Quality Parts,Customers Priority,Honest Operation,and Considerate Service”,our business mainly focus on the distribution of electronic components. Line cards we deal with include Microchip,ALPS,ROHM,Xilinx,Pulse,ON,Everlight and Freescale. Main products comprise IC,Modules,Potentiometer,IC Socket,Relay,Connector.Our parts cover such applications as commercial,industrial, and automotives areas.

We are looking forward to setting up business relationship with you and hope to provide you with the best service and solution. Let us make a better world for our industry!



Contact us

Tel: +86-755-8981 8866 Fax: +86-755-8427 6832

Email & Skype: info@chipsmall.com Web: www.chipsmall.com

Address: A1208, Overseas Decoration Building, #122 Zhenhua RD., Futian, Shenzhen, China



DESCRIPTION

The LY-25 series proximity sensor has been designed for screw mounting. The sensor should be used on a fixed surface with actuating magnet on moving surface.



FEATURES

- No standby power drain
- Simple installation and adjustments
- UL approval

APPLICATIONS

- Door switch
- Machine tool safety
- Security system

SPECIFICATIONS

Parameters	Unit	
Material		ABS
Dimensions		
Length	inches [mm]	0.29 [7.5]
Width	inches [mm]	0.49 [12.5]
Height	inches [mm]	0.69 [17.5]
Body Color		Black
Wire Length	inches [mm]	11.81 [300]
Wire Color		Black
Wire AWG	AWG	24
Specifications		
Contact Ratings		
Switching Voltage	VDC	200
Switching Current	A	0.5
Carry Current	A	1.5
Contact Rating	VA	10
Contact Resistance	Max. Ohms	0.10
Contact Material		Ru
Electrical Ratings		
Insulation Resistance	Ohms	1 x 10 ¹¹
Operate Time	ms	0.5
Release Time	ms	0.2
Contact Life	Ops	1 x 10 ⁹
Environmental Ratings		
Operating Temperature	°C	-20 to +85
Storage Temperature	°C	-20 to +85
Vibration Resistance	Gs	20
Shock Resistance	Gs	30
Weight (sensor)	g	3.9
Weight (magnet)	g	8.4



MECHANICAL DIMENSIONS

Dimensions in mm

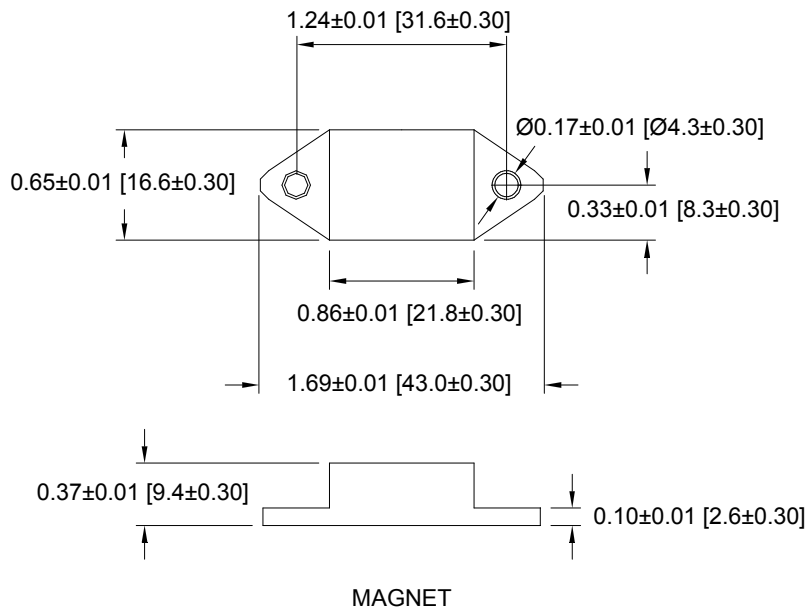
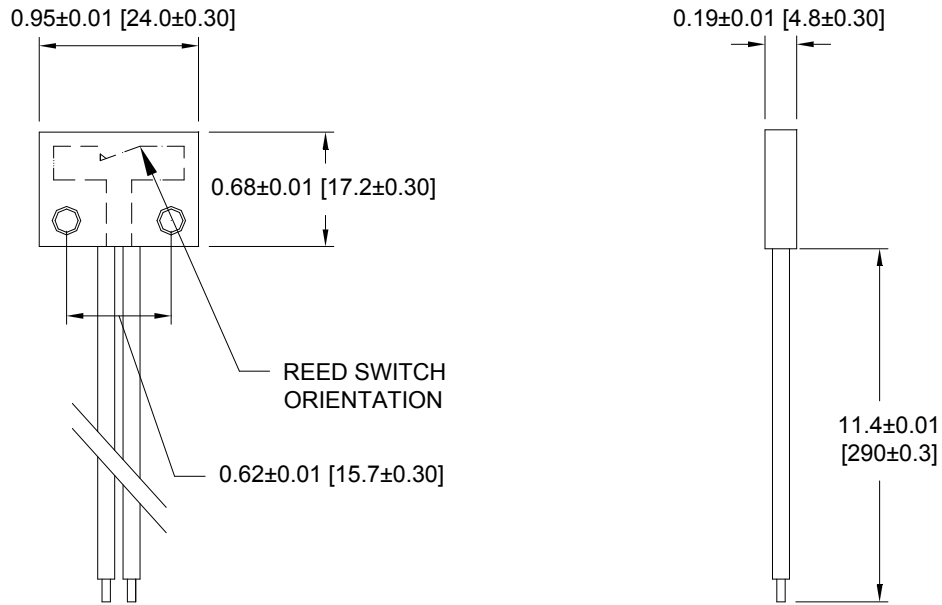

USA 1.866.SRC.8668 EUROPE 44.1225.421999 FAR EAST 866.2.2698.8422

WWW.SRCDEVICES.COM

