



Chipsmall Limited consists of a professional team with an average of over 10 year of expertise in the distribution of electronic components. Based in Hongkong, we have already established firm and mutual-benefit business relationships with customers from,Europe,America and south Asia,supplying obsolete and hard-to-find components to meet their specific needs.

With the principle of “Quality Parts,Customers Priority,Honest Operation,and Considerate Service”,our business mainly focus on the distribution of electronic components. Line cards we deal with include Microchip,ALPS,ROHM,Xilinx,Pulse,ON,Everlight and Freescale. Main products comprise IC,Modules,Potentiometer,IC Socket,Relay,Connector.Our parts cover such applications as commercial,industrial, and automotives areas.

We are looking forward to setting up business relationship with you and hope to provide you with the best service and solution. Let us make a better world for our industry!



Contact us

Tel: +86-755-8981 8866 Fax: +86-755-8427 6832

Email & Skype: info@chipsmall.com Web: www.chipsmall.com

Address: A1208, Overseas Decoration Building, #122 Zhenhua RD., Futian, Shenzhen, China



Customer Information Sheet

DRAWING No.: MI35X-XX

SHEET 2 OF 2

IF IN DOUBT - ASK

©

NOT TO SCALE

THIRD ANGLE PROJECTION

ALL DIMENSIONS IN mm

Ø SPECIFICATIONS:

MATERIALS:

MOULDING = PA66 UL94V-2

CONTACT = PHOSPHOR BRONZE

FINISH:

MI352-XX = 0.76µ GOLD OVER 1.2-2.5µ NICKEL

MI353-XX = 5µ 100% TIN OVER 1.2-2.5µ NICKEL

ELECTRICAL:

CURRENT RATING = 5 AMPS

VOLTAGE RATING = 1,500 VRMS

CONTACT RESISTANCE = 5mΩ MAX (GOLD)

MECHANICAL:

INSERTION FORCE = 22.2N MAX (Ø2.03mm PROBE)

WITHDRAWAL FORCE = 2.2N MIN (Ø2.03mm PROBE)

DURABILITY - 100 CYCLES

HARWIN PART No.	COLOUR	FINISH
MI352-94	WHITE	GOLD
MI352-98	BLACK	GOLD
MI352-99	RED	GOLD
MI353-94	WHITE	TIN
MI353-98	BLACK	TIN
MI353-99	RED	TIN

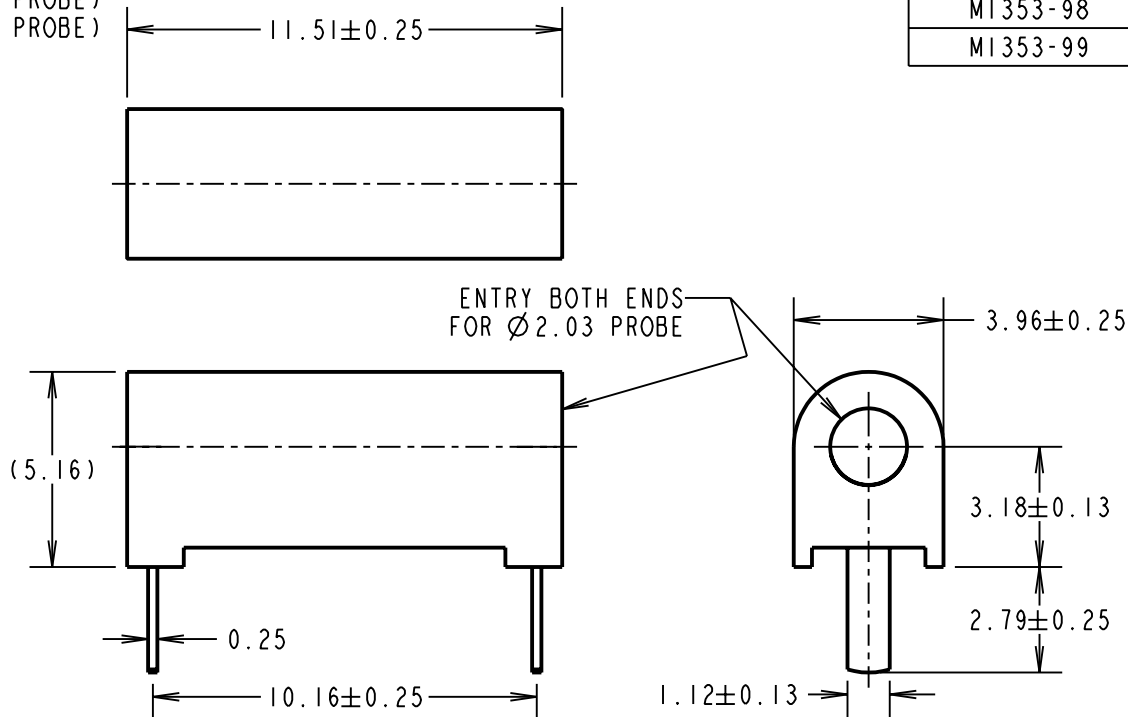

RA	4	25.11.09	10577
NAME	ISS.	DATE	C/NOTE
APPROVED:		R. ADDE	
CHECKED:		M.G. PLESTED	
DRAWN:		R. ADDE	
CUSTOMER REF.:			
ASSEMBLY DRG:			

HARWIN

HARWIN USA
TEL: 603 893 5376
FAX: 603 893 5396
mis@harwin.com

HARWIN Europe (UK)
TEL: 023 9231 4545
FAX: 023 9231 4590
mis@harwin.co.uk

HARWIN Asia
TEL: +65 6 779 4909
FAX: +65 6 779 3868
mis@harwin.com.sg

THIS DRAWING AND ANY INFORMATION OR DESCRIPTIVE MATTER SET OUT HEREON ARE CONFIDENTIAL AND COPYRIGHT PROPERTY OF THE HARWIN GROUP AND MUST NOT BE DISCLOSED, LOANED, COPIED OR USED FOR MANUFACTURING, TENDERING OR FOR ANY OTHER PURPOSE WITHOUT THEIR WRITTEN PERMISSION.

TOLERANCES

X. = ±1mm
X.X = ±0.25mm
X.XX = ±0.10mm
X.XXX = ±0.01mm

ANGLES = ±5°

UNLESS STATED

MATERIAL:

SEE ABOVE

FINISH: SEE ABOVE

S/AREA: mm²

TITLE:

P.C. MOUNTED TEST JACK

DRAWING NUMBER:

MI35X-XX

SHT
2 OF 2