



Chipsmall Limited consists of a professional team with an average of over 10 year of expertise in the distribution of electronic components. Based in Hongkong, we have already established firm and mutual-benefit business relationships with customers from,Europe,America and south Asia,supplying obsolete and hard-to-find components to meet their specific needs.

With the principle of “Quality Parts,Customers Priority,Honest Operation,and Considerate Service”,our business mainly focus on the distribution of electronic components. Line cards we deal with include Microchip,ALPS,ROHM,Xilinx,Pulse,ON,Everlight and Freescale. Main products comprise IC,Modules,Potentiometer,IC Socket,Relay,Connector.Our parts cover such applications as commercial,industrial, and automotives areas.

We are looking forward to setting up business relationship with you and hope to provide you with the best service and solution. Let us make a better world for our industry!



## Contact us

Tel: +86-755-8981 8866 Fax: +86-755-8427 6832

Email & Skype: info@chipsmall.com Web: www.chipsmall.com

Address: A1208, Overseas Decoration Building, #122 Zhenhua RD., Futian, Shenzhen, China



# MAC15SD, MAC15SM, MAC15SN

Preferred Device

## Sensitive Gate Triacs

### Silicon Bidirectional Thyristors

Designed for industrial and consumer applications for full wave control of AC loads such as appliance controls, heater controls, motor controls, and other power switching applications.

#### Features

- Sensitive Gate allows Triggering by Microcontrollers and other Logic Circuits
- High Immunity to  $dv/dt$  – 25 V/ $\mu$ s minimum at 110°C
- High Commutating  $di/dt$  – 8.0 A/ms minimum at 110°C
- Maximum Values of  $I_{GT}$ ,  $V_{GT}$  and  $I_H$  Specified for Ease of Design
- On-State Current Rating of 15 Amperes RMS at 70°C
- High Surge Current Capability – 120 Amperes
- Blocking Voltage to 800 Volts
- Rugged, Economical TO–220AB Package
- Uniform Gate Trigger Currents in Three Quadrants, Q1, Q2, and Q3
- Pb–Free Packages are Available\*

#### MAXIMUM RATINGS ( $T_J = 25^\circ\text{C}$ unless otherwise noted)

Rating	Symbol	Value	Unit
Peak Repetitive Off-State Voltage (Note 1) ( $T_J = -40$ to $110^\circ\text{C}$ , Sine Wave, 50 to 60 Hz, Gate Open)	$V_{DRM}$ , $V_{RRM}$	400 600 800	V
On-State RMS Current (Full Cycle Sine Wave, 60Hz, $T_J = 70^\circ\text{C}$ )	$I_{T(RMS)}$	15	A
Peak Non-repetitive Surge Current (One Full Cycle Sine Wave, 60 Hz, $T_J = 110^\circ\text{C}$ )	$I_{TSM}$	120	A
Circuit Fusing Consideration ( $t = 8.3$ ms)	$I^2t$	60	$\text{A}^2\text{s}$
Peak Gate Power (Pulse Width $\leq 1.0$ $\mu$ s, $T_C = 70^\circ\text{C}$ )	$P_{GM}$	20	W
Average Gate Power ( $t = 8.3$ ms, $T_C = 70^\circ\text{C}$ )	$P_{G(AV)}$	0.5	W
Operating Junction Temperature Range	$T_J$	-40 to +110	$^\circ\text{C}$
Storage Temperature Range	$T_{stg}$	-40 to +150	$^\circ\text{C}$

Maximum ratings are those values beyond which device damage can occur. Maximum ratings applied to the device are individual stress limit values (not normal operating conditions) and are not valid simultaneously. If these limits are exceeded, device functional operation is not implied, damage may occur and reliability may be affected.

1.  $V_{DRM}$  and  $V_{RRM}$  for all types can be applied on a continuous basis. Blocking voltages shall not be tested with a constant current source such that the voltage ratings of the devices are exceeded.

\*For additional information on our Pb–Free strategy and soldering details, please download the ON Semiconductor Soldering and Mounting Techniques Reference Manual, SOLDERRM/D.



ON Semiconductor®

<http://onsemi.com>

**TRIACS**  
**15 AMPERES RMS**  
**400 thru 800 VOLTS**

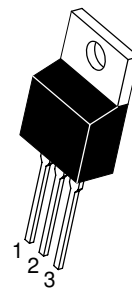
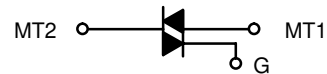

**TO–220AB**  
**CASE 221A–09**  
**STYLE 4**

#### MARKING DIAGRAM



x = D, M, or N  
A = Assembly Location  
Y = Year  
WW = Work Week  
G = Pb–Free Package

#### PIN ASSIGNMENT

1	Main Terminal 1
2	Main Terminal 2
3	Gate
4	Main Terminal 2

#### ORDERING INFORMATION

Device	Package	Shipping
MAC15SD	TO–220AB	50 Units / Rail
MAC15SDG	TO–220AB (Pb–Free)	50 Units / Rail
MAC15SM	TO–220AB	50 Units / Rail
MAC15SMG	TO–220AB (Pb–Free)	50 Units / Rail
MAC15SN	TO–220AB	50 Units / Rail
MAC15SNG	TO–220AB (Pb–Free)	50 Units / Rail

**Preferred** devices are recommended choices for future use and best overall value.

# MAC15SD, MAC15SM, MAC15SN

## THERMAL CHARACTERISTICS

Characteristic	Symbol	Value	Unit
Thermal Resistance, Junction-to-Case Junction-to-Ambient	$R_{\theta JC}$ $R_{\theta JA}$	2.0 62.5	$^{\circ}\text{C}/\text{W}$
Maximum Lead Temperature for Soldering Purposes 1/8" from Case for 10 Seconds	$T_L$	260	$^{\circ}\text{C}$

## ELECTRICAL CHARACTERISTICS ( $T_J = 25^{\circ}\text{C}$ unless otherwise noted; Electricals apply in both directions)

Characteristic	Symbol	Min	Typ	Max	Unit
----------------	--------	-----	-----	-----	------

### OFF CHARACTERISTICS

Peak Repetitive Blocking Current ( $V_D = \text{Rated } V_{DRM}$ ; $V_{RRM}$ : Gate Open)	$I_{DRM}$ , $I_{RRM}$	- -	- -	0.01 2.0	mA
					$T_J = 25^{\circ}\text{C}$ $T_J = 110^{\circ}\text{C}$

### ON CHARACTERISTICS

Peak On-State Voltage (Note 2) ( $I_{TM} = \pm 21\text{A}$ )	$V_{TM}$	-	-	1.8	V
Gate Trigger Current (Continuous dc) ( $V_D = 12\text{V}$ , $R_L = 100\Omega$ ) MT2(+), G(+) MT2(+), G(-) MT2(-), G(-)	$I_{GT}$	- - -	2.0 3.0 3.0	5.0 5.0 5.0	mA
Hold Current ( $V_D = 12\text{V}$ , Gate Open, Initiating Current = $\pm 150\text{mA}$ )	$I_H$	-	3.0	10	mA
Latching Current ( $V_D = 24\text{V}$ , $I_G = 5\text{mA}$ ) MT2(+), G(+) MT2(+), G(-) MT2(-), G(-)	$I_L$	- - -	5.0 10 5.0	15 20 15	mA
Gate Trigger Voltage (Continuous dc) ( $V_D = 12\text{V}$ , $R_L = 100\Omega$ ) MT2(+), G(+) MT2(+), G(-) MT2(-), G(-)	$V_{GT}$	0.45 0.45 0.45	0.62 0.60 0.65	1.5 1.5 1.5	V

### DYNAMIC CHARACTERISTICS

Rate of Change of Commutating Current ( $V_D = 400\text{V}$ , $I_{TM} = 3.5\text{A}$ , Commutating $dv/dt = 10\text{V}/\mu\text{sec}$ , Gate Open, $T_J = 110^{\circ}\text{C}$ , $f = 500\text{Hz}$ , Snubber: $C_S = 0.01\mu\text{F}$ , $R_S = 15\Omega$ , see Figure 15)	$(di/dt)_c$	8.0	10	-	A/ms
Critical Rate of Rise of Off-State Voltage ( $V_D = \text{Rate } V_{DRM}$ , Exponential Waveform, $R_{GK} = 510\Omega$ , $T_J = 110^{\circ}\text{C}$ )	$dv/dt$	25	75	-	V/ $\mu\text{s}$

2. Pulse Test: Pulse Width  $\leq 2.0\text{ms}$ , Duty Cycle  $\leq 2\%$ .

# MAC15SD, MAC15SM, MAC15SN

## Voltage Current Characteristic of Triacs (Bidirectional Device)

Symbol	Parameter
$V_{DRM}$	Peak Repetitive Forward Off State Voltage
$I_{DRM}$	Peak Forward Blocking Current
$V_{RRM}$	Peak Repetitive Reverse Off State Voltage
$I_{RRM}$	Peak Reverse Blocking Current
$V_{TM}$	Maximum On State Voltage
$I_H$	Holding Current

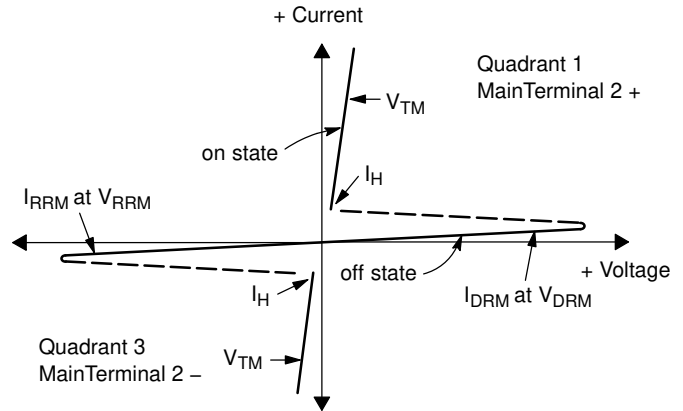

## Quadrant Definitions for a Triac

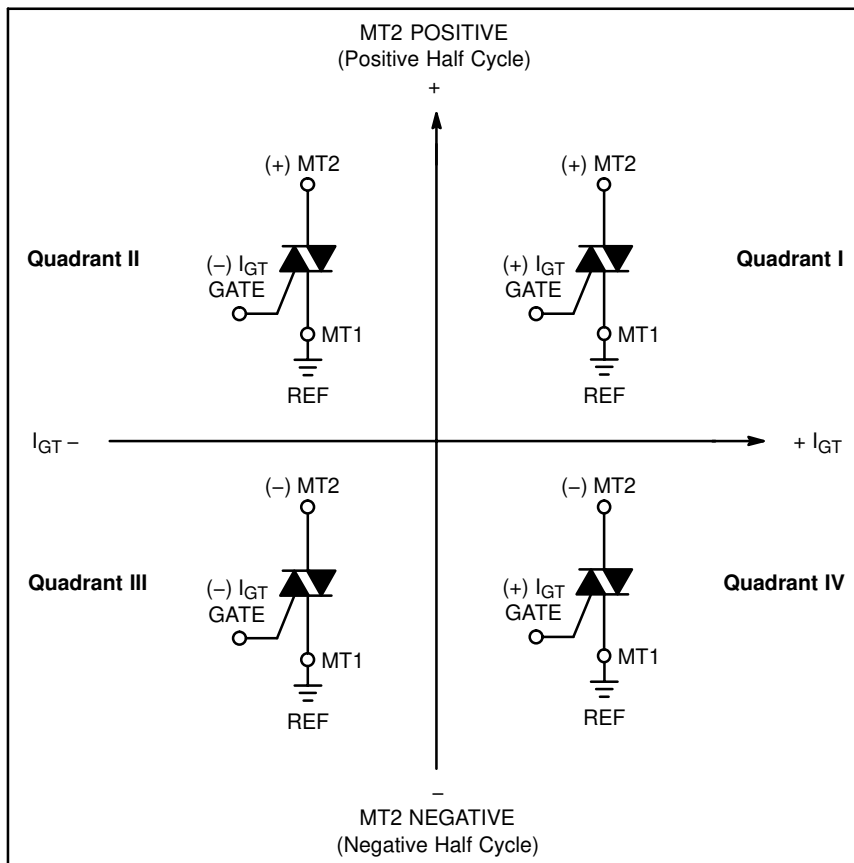

All polarities are referenced to MT1.  
With in-phase signals (using standard AC lines) quadrants I and III are used.

# MAC15SD, MAC15SM, MAC15SN

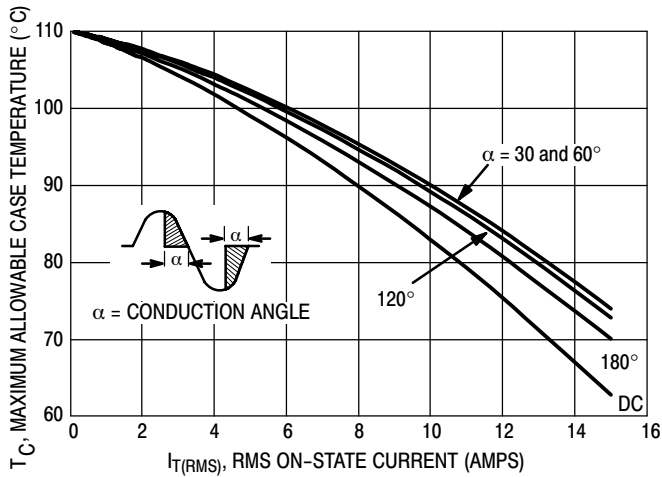

Figure 1. RMS Current Derating

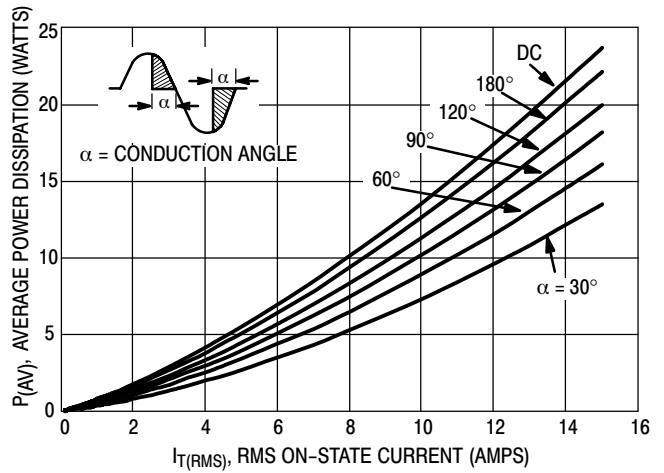

Figure 2. Maximum On-State Power Dissipation

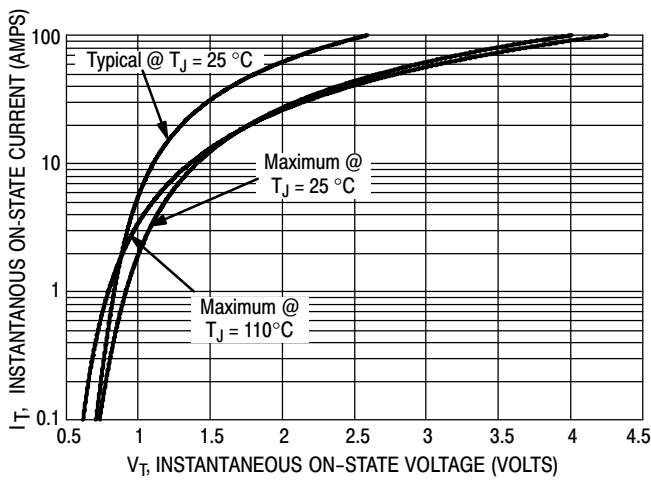

Figure 3. On-State Characteristics

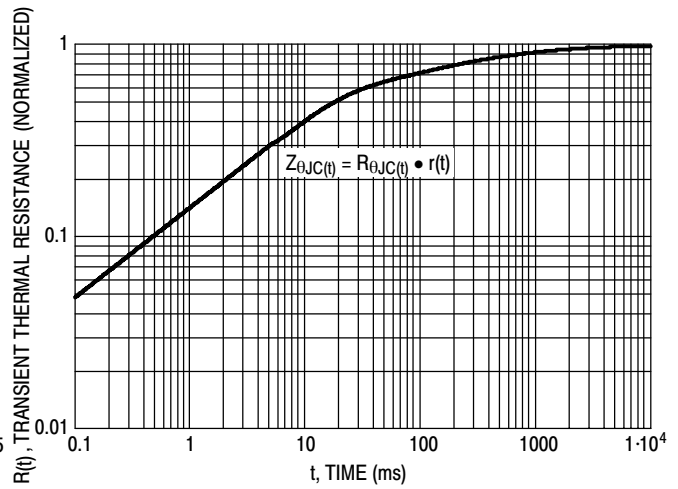

Figure 4. Transient Thermal Response

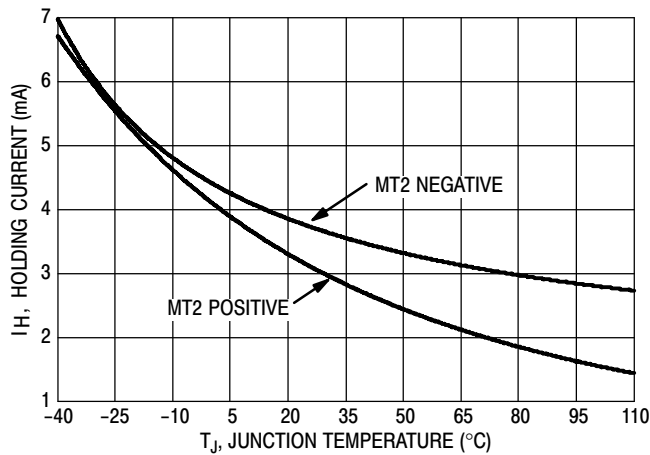

Figure 5. Typical Holding Current Versus Junction Temperature

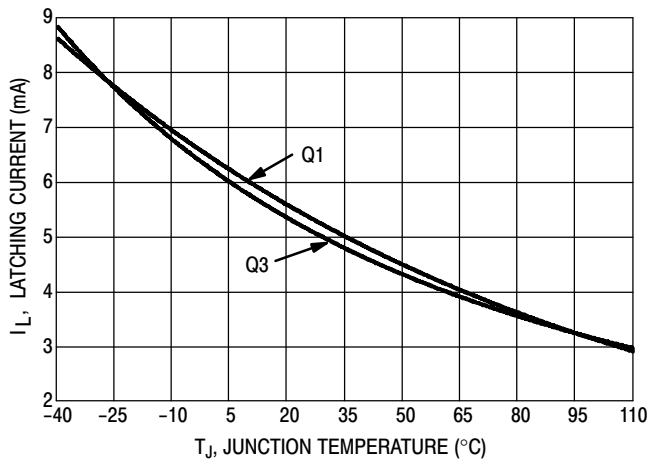
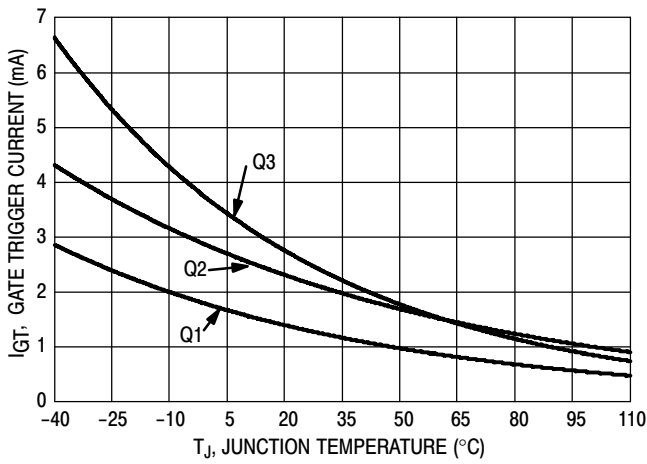
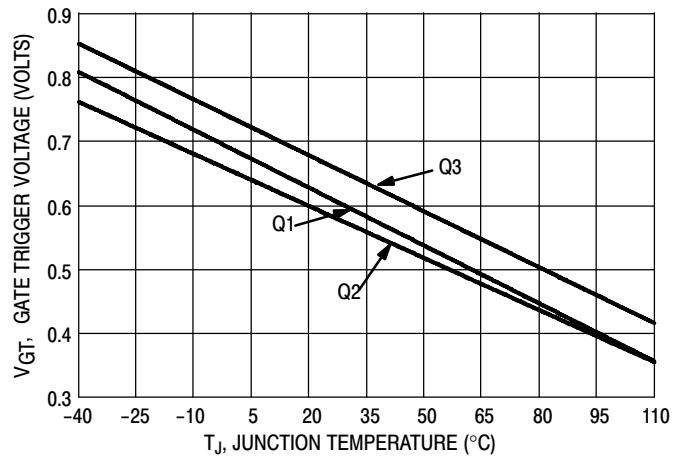

Figure 6. Typical Latching Current Versus Junction Temperature

# MAC15SD, MAC15SM, MAC15SN



**Figure 7. Typical Gate Trigger Current Versus Junction Temperature**



**Figure 8. Typical Gate Trigger Voltage Versus Junction Temperature**

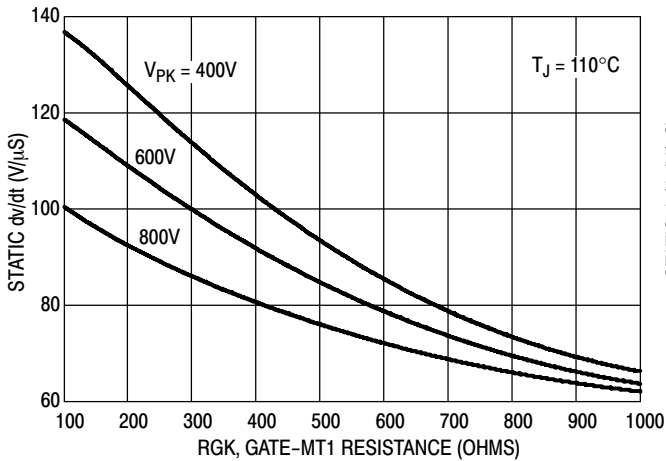

**Figure 9. Typical Exponential Static dv/dt Versus Gate-MT1 Resistance, MT2(+)**

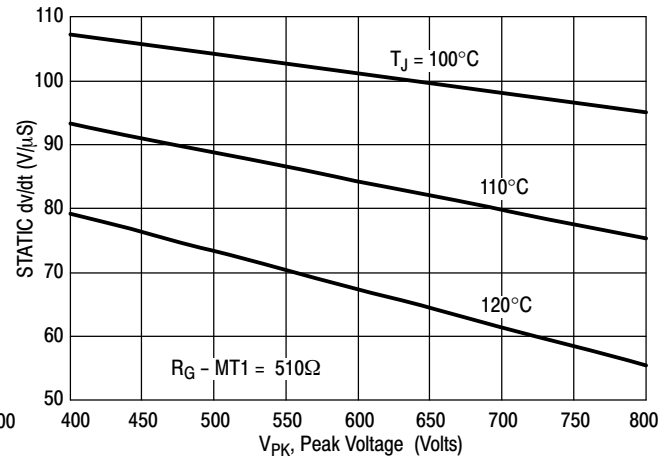

**Figure 10. Typical Exponential Static dv/dt Versus Peak Voltage, MT2(+)**

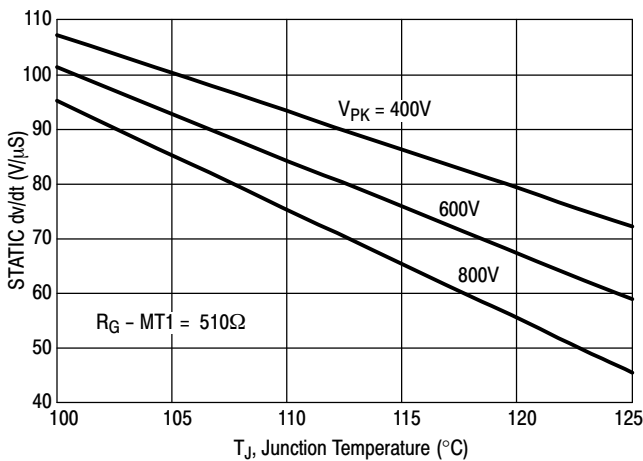

**Figure 11. Typical Exponential Static dv/dt Versus Junction Temperature, MT2(+)**

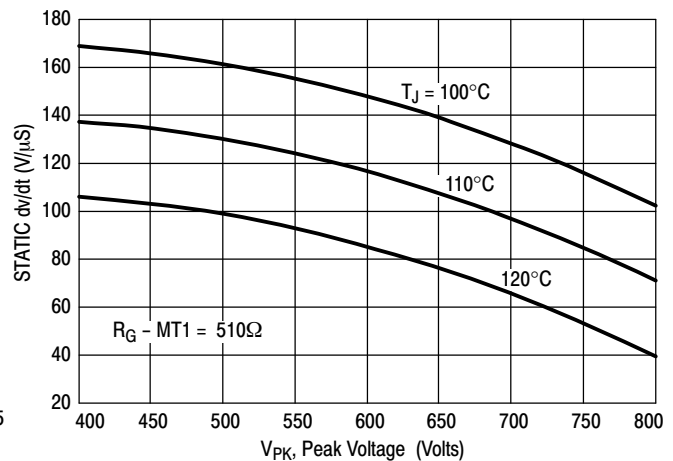

**Figure 12. Typical Exponential Static dv/dt Versus Peak Voltage, MT2(-)**

# MAC15SD, MAC15SM, MAC15SN

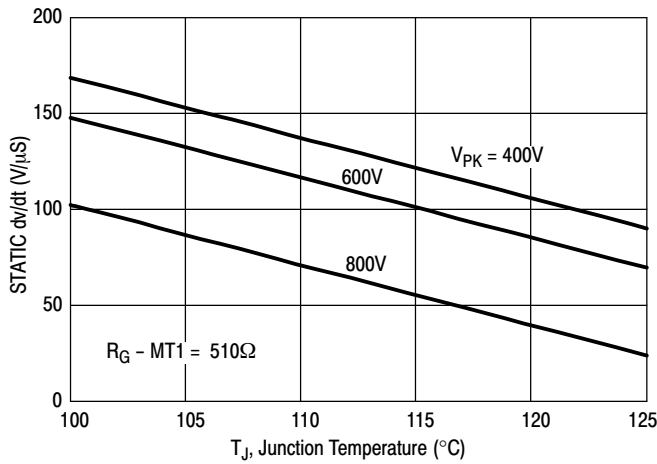

Figure 13. Typical Exponential Static dv/dt Versus Junction Temperature, MT2(-)

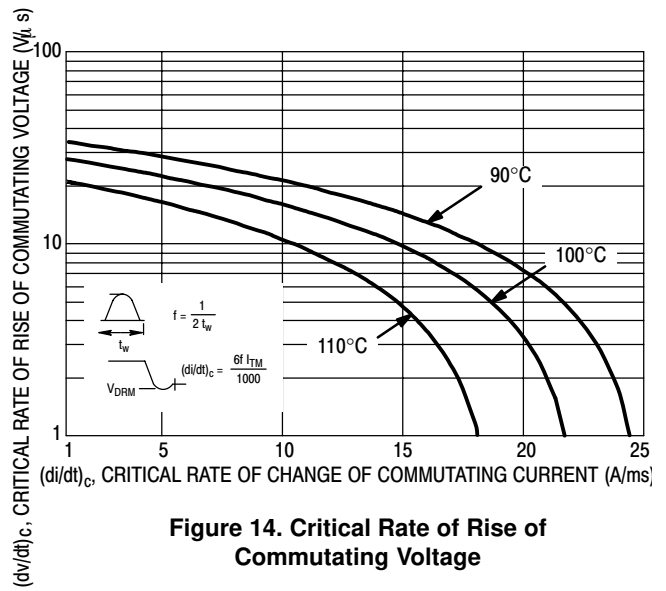
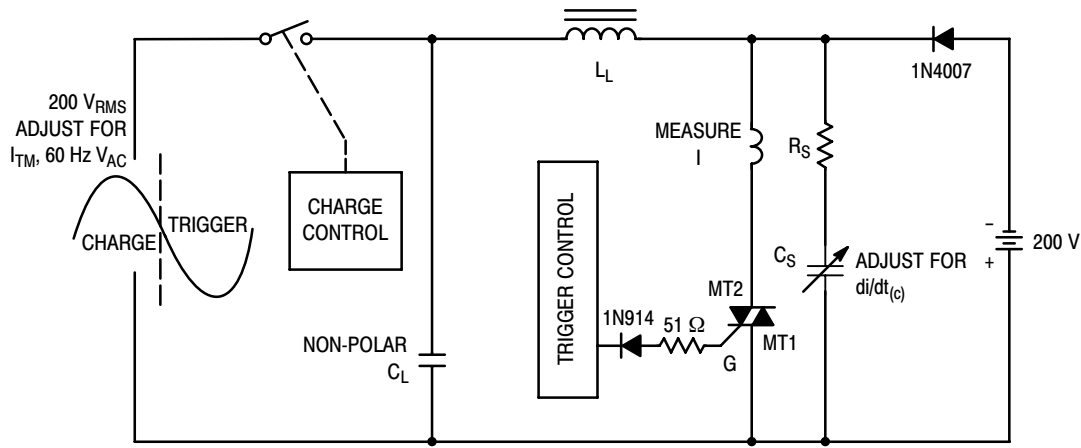

Figure 14. Critical Rate of Rise of Commutating Voltage



Note: Component values are for verification of rated (di/dt)<sub>c</sub>. See AN1048 for additional information.

Figure 15. Simplified Test Circuit to Measure the Critical Rate of Rise of Commutating Current (di/dt)<sub>c</sub>

# MAC15SD, MAC15SM, MAC15SN

## PACKAGE DIMENSIONS

TO-220AB  
CASE 221A-09  
ISSUE AA

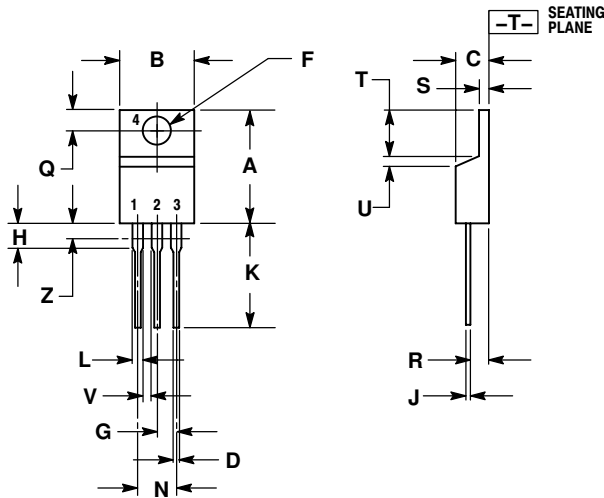

NOTES:

1. DIMENSIONING AND TOLERANCING PER ANSI Y14.5M, 1982.
2. CONTROLLING DIMENSION: INCH.
3. DIMENSION Z DEFINES A ZONE WHERE ALL BODY AND LEAD IRREGULARITIES ARE ALLOWED.

DIM	INCHES		MILLIMETERS	
	MIN	MAX	MIN	MAX
A	0.570	0.620	14.48	15.75
B	0.380	0.405	9.66	10.28
C	0.160	0.190	4.07	4.82
D	0.025	0.035	0.64	0.88
F	0.142	0.147	3.61	3.73
G	0.095	0.105	2.42	2.66
H	0.110	0.155	2.80	3.93
J	0.018	0.025	0.46	0.64
K	0.500	0.562	12.70	14.27
L	0.045	0.060	1.15	1.52
N	0.190	0.210	4.83	5.33
Q	0.100	0.120	2.54	3.04
R	0.080	0.110	2.04	2.79
S	0.045	0.055	1.15	1.39
T	0.235	0.255	5.97	6.47
U	0.000	0.050	0.00	1.27
V	0.045	---	1.15	---
Z	---	0.080	---	2.04

STYLE 4:

- PIN 1. MAIN TERMINAL 1
2. MAIN TERMINAL 2
3. GATE
4. MAIN TERMINAL 2

ON Semiconductor and are registered trademarks of Semiconductor Components Industries, LLC (SCILLC). SCILLC reserves the right to make changes without further notice to any products herein. SCILLC makes no warranty, representation or guarantee regarding the suitability of its products for any particular purpose, nor does SCILLC assume any liability arising out of the application or use of any product or circuit, and specifically disclaims any and all liability, including without limitation special, consequential or incidental damages. "Typical" parameters which may be provided in SCILLC data sheets and/or specifications can and do vary in different applications and actual performance may vary over time. All operating parameters, including "Typicals" must be validated for each customer application by customer's technical experts. SCILLC does not convey any license under its patent rights nor the rights of others. SCILLC products are not designed, intended, or authorized for use as components in systems intended for surgical implant into the body, or other applications intended to support or sustain life, or for any other application in which the failure of the SCILLC product could create a situation where personal injury or death may occur. Should Buyer purchase or use SCILLC products for any such unintended or unauthorized application, Buyer shall indemnify and hold SCILLC and its officers, employees, subsidiaries, affiliates, and distributors harmless against all claims, costs, damages, and expenses, and reasonable attorney fees arising out of, directly or indirectly, any claim of personal injury or death associated with such unintended or unauthorized use, even if such claim alleges that SCILLC was negligent regarding the design or manufacture of the part. SCILLC is an Equal Opportunity/Affirmative Action Employer. This literature is subject to all applicable copyright laws and is not for resale in any manner.

### PUBLICATION ORDERING INFORMATION

**LITERATURE FULFILLMENT:**

Literature Distribution Center for ON Semiconductor  
P.O. Box 61312, Phoenix, Arizona 85082-1312 USA  
Phone: 480-829-7710 or 800-344-3860 Toll Free USA/Canada  
Fax: 480-829-7709 or 800-344-3867 Toll Free USA/Canada  
Email: orderlit@onsemi.com

**N. American Technical Support:** 800-282-9855 Toll Free  
USA/Canada

**Japan:** ON Semiconductor, Japan Customer Focus Center  
2-9-1 Kamimeguro, Meguro-ku, Tokyo, Japan 153-0051  
Phone: 81-3-5773-3850

**ON Semiconductor Website:** <http://onsemi.com>

**Order Literature:** <http://www.onsemi.com/litorder>

For additional information, please contact your local Sales Representative.