



Chipsmall Limited consists of a professional team with an average of over 10 year of expertise in the distribution of electronic components. Based in Hongkong, we have already established firm and mutual-benefit business relationships with customers from,Europe,America and south Asia,supplying obsolete and hard-to-find components to meet their specific needs.

With the principle of "Quality Parts,Customers Priority,Honest Operation,and Considerate Service",our business mainly focus on the distribution of electronic components. Line cards we deal with include Microchip,ALPS,ROHM,Xilinx,Pulse,ON,Everlight and Freescale. Main products comprise IC,Modules,Potentiometer,IC Socket,Relay,Connector.Our parts cover such applications as commercial,industrial, and automotives areas.

We are looking forward to setting up business relationship with you and hope to provide you with the best service and solution. Let us make a better world for our industry!



Contact us

Tel: +86-755-8981 8866 Fax: +86-755-8427 6832

Email & Skype: info@chipsmall.com Web: www.chipsmall.com

Address: A1208, Overseas Decoration Building, #122 Zhenhua RD., Futian, Shenzhen, China





Micro Commercial Components



Micro Commercial Components
20736 Marilla Street Chatsworth
CA 91311
Phone: (818) 701-4933
Fax: (818) 701-4939

MBR2020CT THRU MBR20100CT

20 Amp Schottky Barrier Rectifier 20 to 100 Volts

Features

- Meatl of Silicon Rectifier, Majority Conduction
- Guard ring for transient protection
- High Current Capability, High Efficiency
- Low Forward Voltage Drop
- Marking : type number
- Halogen free available upon request by adding suffix "-HF"
- Lead Free Finish/RoHS Compliant(Note 1) ("P" Suffix designates RoHS Compliant. See ordering information)
- Epoxy meets UL 94 V-0 flammability rating
- Moisture Sensitivity Level 1

Maximum Ratings

- Mounting Torque: 5 in-lbs Maximum
- Operating Temperature: -55°C to +150°C
- Storage Temperature: -55°C to +150°C

| MCC Catalog Number | Maximum Recurrent Peak Reverse Voltage | Maximum RMS Voltage | Maximum DC Blocking Voltage |
|--------------------|--|---------------------|-----------------------------|
| MBR2020CT | 20V | 14V | 20V |
| MBR2030CT | 30V | 21V | 30V |
| MBR2035CT | 35V | 24.5V | 35V |
| MBR2040CT | 40V | 28V | 40V |
| MBR2045CT | 45V | 31.5V | 45V |
| MBR2060CT | 60V | 42V | 60V |
| MBR2080CT | 80V | 56V | 80V |
| MBR20100CT | 100V | 70V | 100V |

Electrical Characteristics @ 25°C Unless Otherwise Specified

| | | | |
|---|-------------|--|--|
| Average Forward Current | $I_{F(AV)}$ | 20 A | $T_A = 120^\circ\text{C}$ |
| Peak Forward Surge Current | I_{FSM} | 150A | 8.3ms, half sine |
| Maximum Instantaneous Forward Voltage | V_F | .70V .80V .85V .84V .95V .95V .72V .85V .85V | $I_{FM} = 10A;$ $T_A = 25^\circ\text{C} *$ $I_{FM} = 20A;$ $T_A = 25^\circ\text{C} *$ $I_{FM} = 20A;$ $T_A = 125^\circ\text{C} *$ |
| 2020CT-2045CT | | | |
| 2060CT | | | |
| 2080CT-20100CT | | | |
| Maximum DC Reverse Current At Rated DC Blocking Voltage | I_R | 0.1mA 0.15mA 50mA 150mA | $T_A = 25^\circ\text{C}$ $T_A = 125^\circ\text{C}$ |
| 2020CT~2045CT | | | |
| 2060CT~20100CT | | | |
| 2020CT~2045CT | | | |

*Pulse Test: Pulse Width 300µsec, Duty Cycle 2%

Notes:1.High Temperature Solder Exemption Applied, see EU Directive Annex 7.

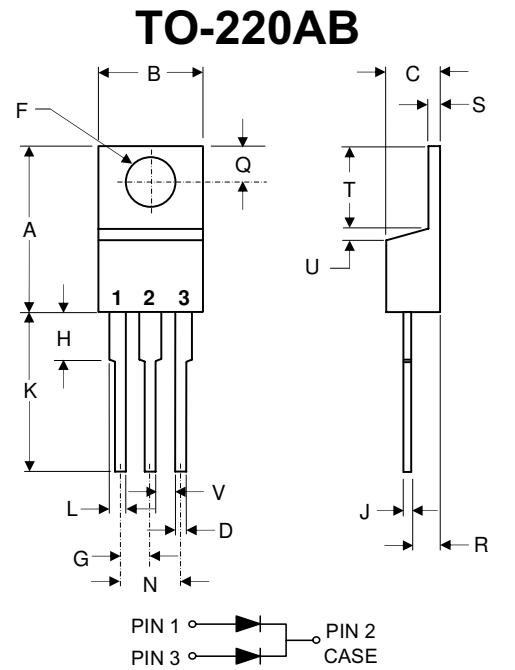

| DIM | DIMENSIONS | | | | NOTE |
|-----|------------|-------|-------|-------|------|
| | INCHES | | MM | | |
| A | .560 | .625 | 14.22 | 15.88 | |
| B | .380 | .420 | 9.65 | 10.67 | |
| C | .140 | .190 | 3.56 | 4.82 | |
| D | .020 | .045 | 0.51 | 1.14 | |
| F | .139 | .161 | 3.53 | 4.09 | ∅ |
| G | .190 | .110 | 2.29 | 2.79 | |
| H | --- | .250 | --- | 6.35 | |
| J | .012 | .025 | 0.30 | 0.64 | |
| K | .500 | .580 | 12.70 | 14.73 | |
| L | .045 | .060 | 1.14 | 1.52 | |
| N | .190 | .210 | 4.83 | 5.33 | |
| Q | .100 | .135 | 2.54 | 3.43 | |
| R | .080 | .115 | 2.04 | 2.92 | |
| S | .045 | .055 | 1.14 | 1.39 | |
| T | .230 | .270 | 5.84 | 6.86 | |
| U | ----- | .050 | ----- | 1.27 | |
| V | .045 | ----- | 1.15 | ----- | |

MBR2020CT thru MBR20100CT

Figure 1
Typical Forward Characteristics

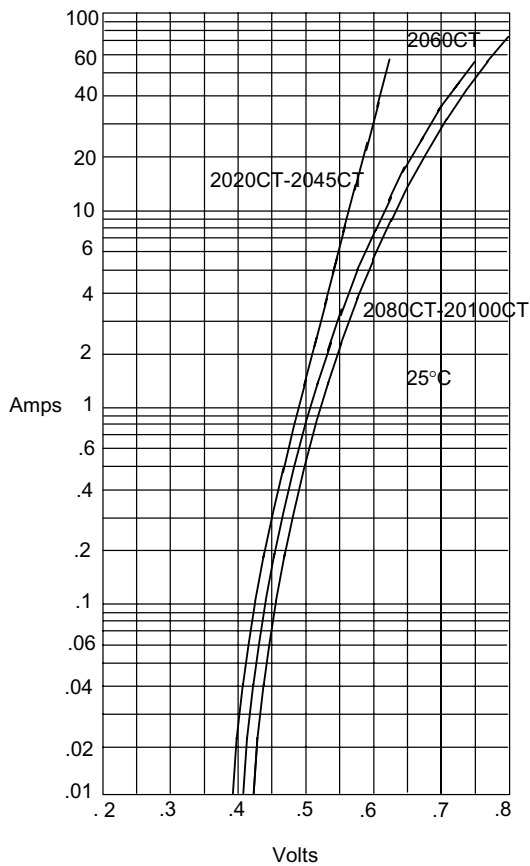

Instantaneous Forward Current - Amperes *versus*
Instantaneous Forward Voltage - Volts

Figure 2
Micro Commercial Components
Typical Reverse Characteristics

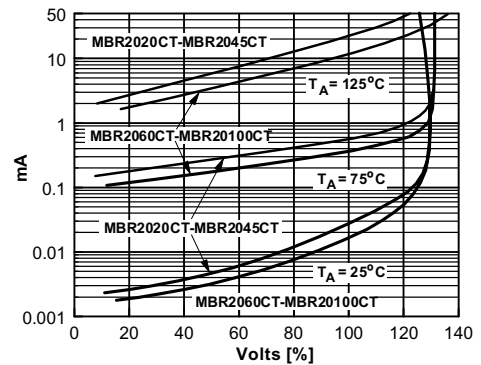

Instantaneous Reverse Leakage Current - mA
Percent Of Rated Peak Reverse Voltage - Volts%

Figure 3
Forward Derating Curve

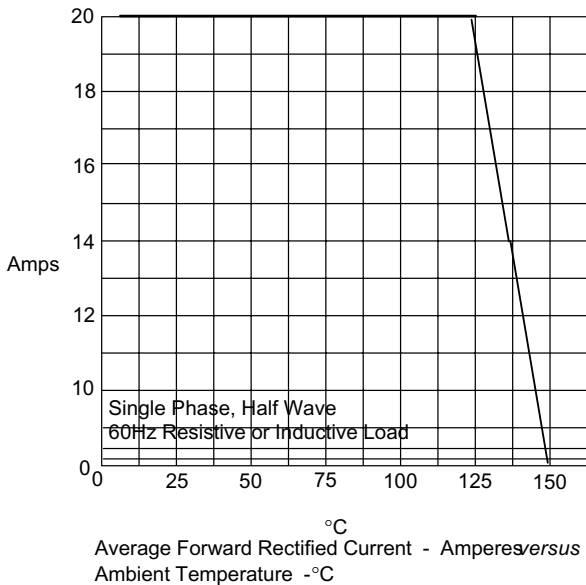

Average Forward Rectified Current - Amperes *versus*
Ambient Temperature - °C

Figure 4
Peak Forward Surge Current

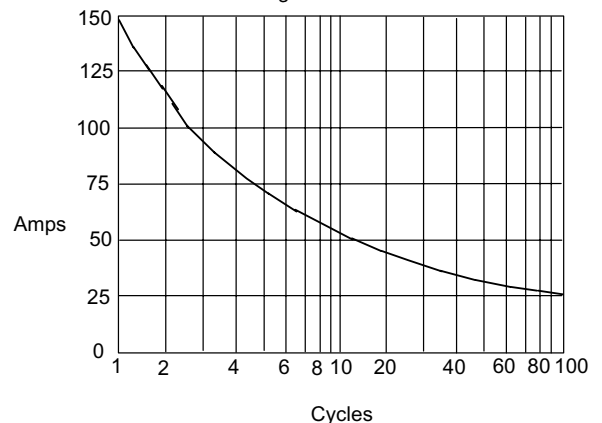

Peak Forward Surge Current - Amperes *versus*
Number Of Cycles At 60Hz - Cycles



Micro Commercial Components

Ordering Information

| | |
|------------------|----------------|
| Device | Packing |
| (Part Number)-BP | Bulk;1Kpcs/Box |

Note : Adding "-HF" suffix for halogen free, eg. Part Number-BP-HF

IMPORTANT NOTICE

Micro Commercial Components Corp. reserves the right to make changes without further notice to any product herein to make corrections, modifications, enhancements, improvements, or other changes. **Micro Commercial Components Corp.** does not assume any liability arising out of the application or use of any product described herein; neither does it convey any license under its patent rights, nor the rights of others. The user of products in such applications shall assume all risks of such use and will agree to hold **Micro Commercial Components Corp.** and all the companies whose products are represented on our website, harmless against all damages.

LIFE SUPPORT

MCC's products are not authorized for use as critical components in life support devices or systems without the express written approval of Micro Commercial Components Corporation.

CUSTOMER AWARENESS

Counterfeiting of semiconductor parts is a growing problem in the industry. Micro Commercial Components (MCC) is taking strong measures to protect ourselves and our customers from the proliferation of counterfeit parts. MCC strongly encourages customers to purchase MCC parts either directly from MCC or from Authorized MCC Distributors who are listed by country on our web page cited below. Products customers buy either from MCC directly or from Authorized MCC Distributors are genuine parts, have full traceability, meet MCC's quality standards for handling and storage. **MCC will not provide any warranty coverage or other assistance for parts bought from Unauthorized Sources.** MCC is committed to combat this global problem and encourage our customers to do their part in stopping this practice by buying direct or from authorized distributors.

www.mccsemi.com