



Chipsmall Limited consists of a professional team with an average of over 10 year of expertise in the distribution of electronic components. Based in Hongkong, we have already established firm and mutual-benefit business relationships with customers from,Europe,America and south Asia,supplying obsolete and hard-to-find components to meet their specific needs.

With the principle of “Quality Parts,Customers Priority,Honest Operation,and Considerate Service”,our business mainly focus on the distribution of electronic components. Line cards we deal with include Microchip,ALPS,ROHM,Xilinx,Pulse,ON,Everlight and Freescale. Main products comprise IC,Modules,Potentiometer,IC Socket,Relay,Connector.Our parts cover such applications as commercial,industrial, and automotives areas.

We are looking forward to setting up business relationship with you and hope to provide you with the best service and solution. Let us make a better world for our industry!



## Contact us

Tel: +86-755-8981 8866 Fax: +86-755-8427 6832

Email & Skype: info@chipsmall.com Web: www.chipsmall.com

Address: A1208, Overseas Decoration Building, #122 Zhenhua RD., Futian, Shenzhen, China



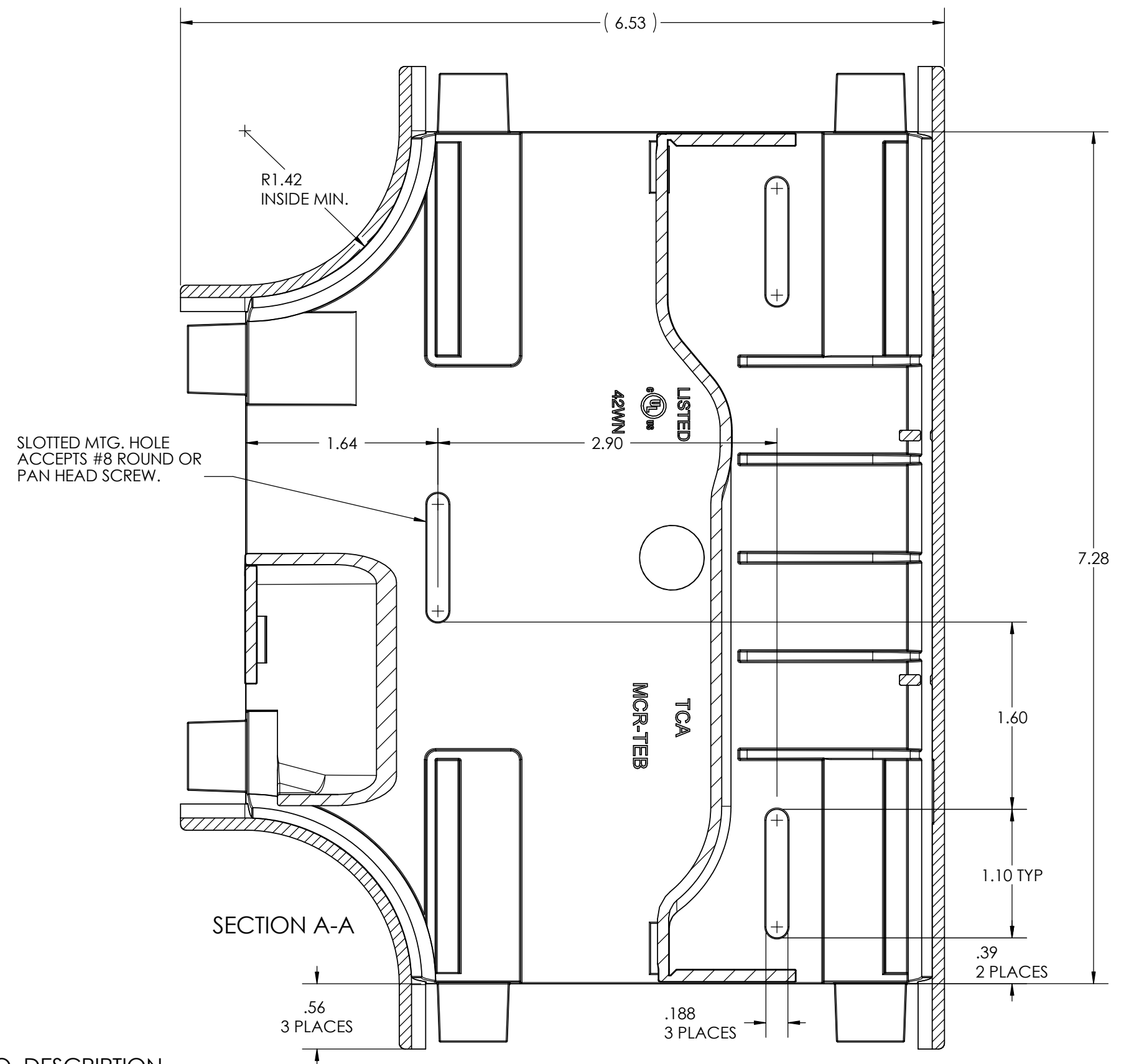
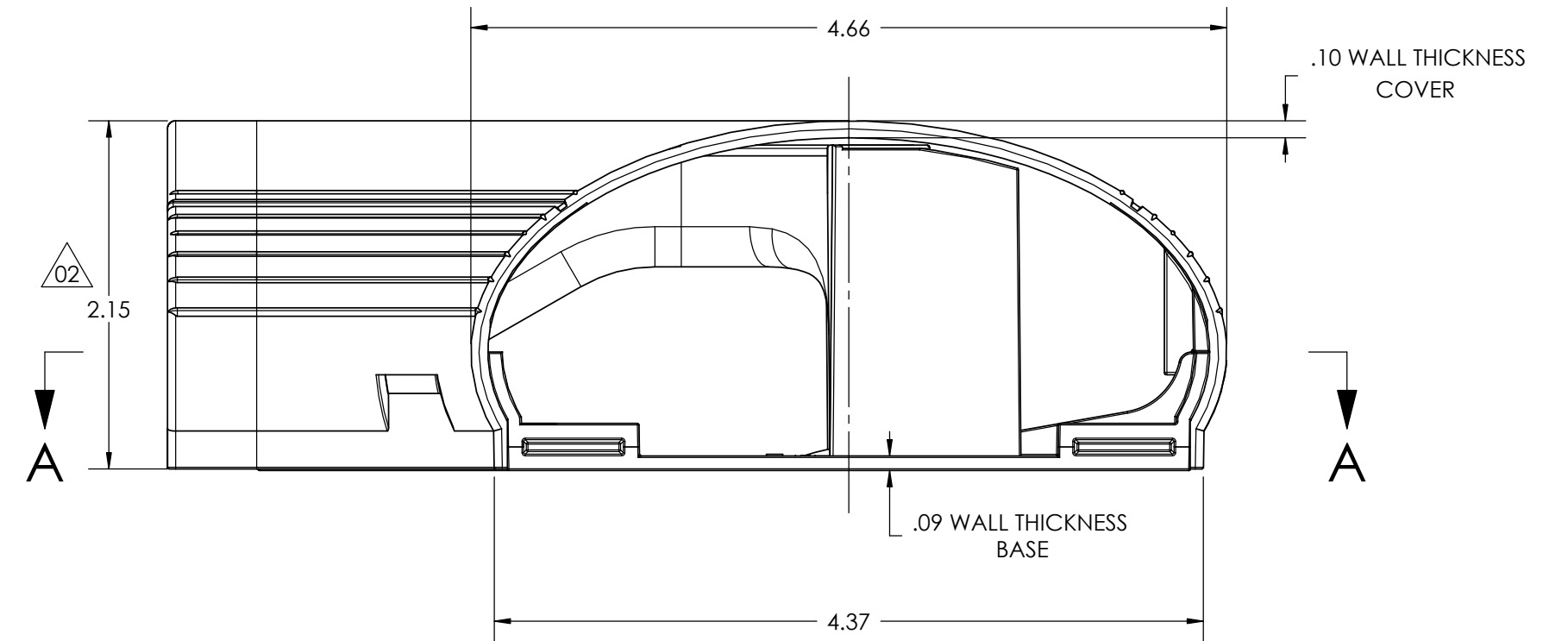
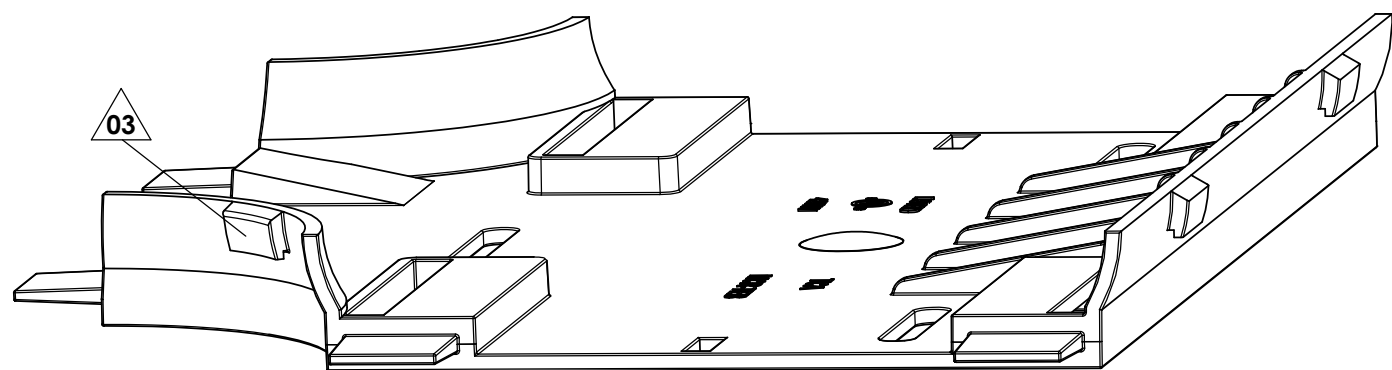
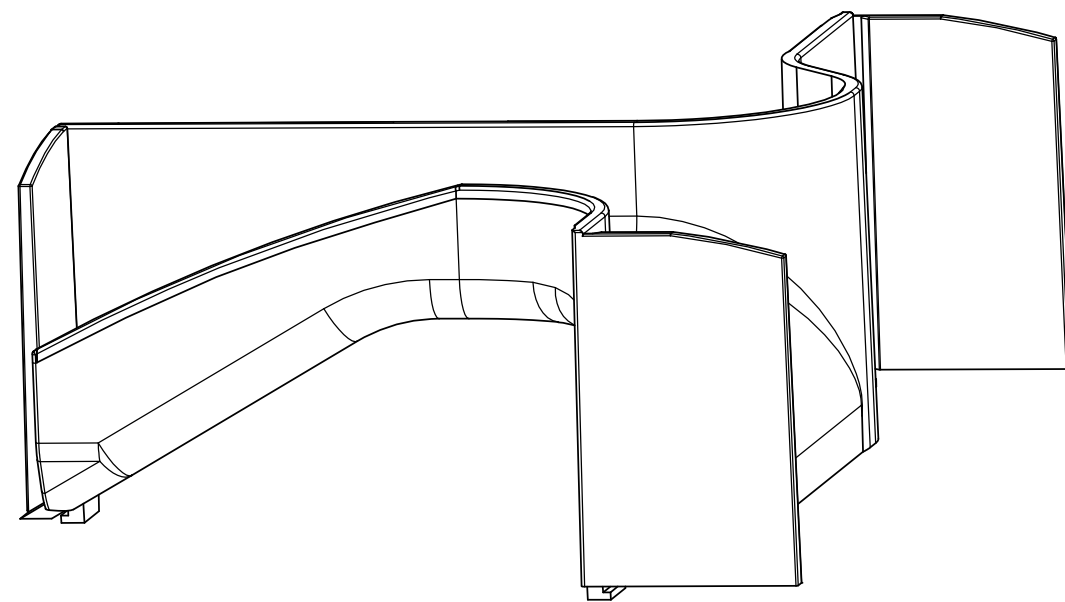
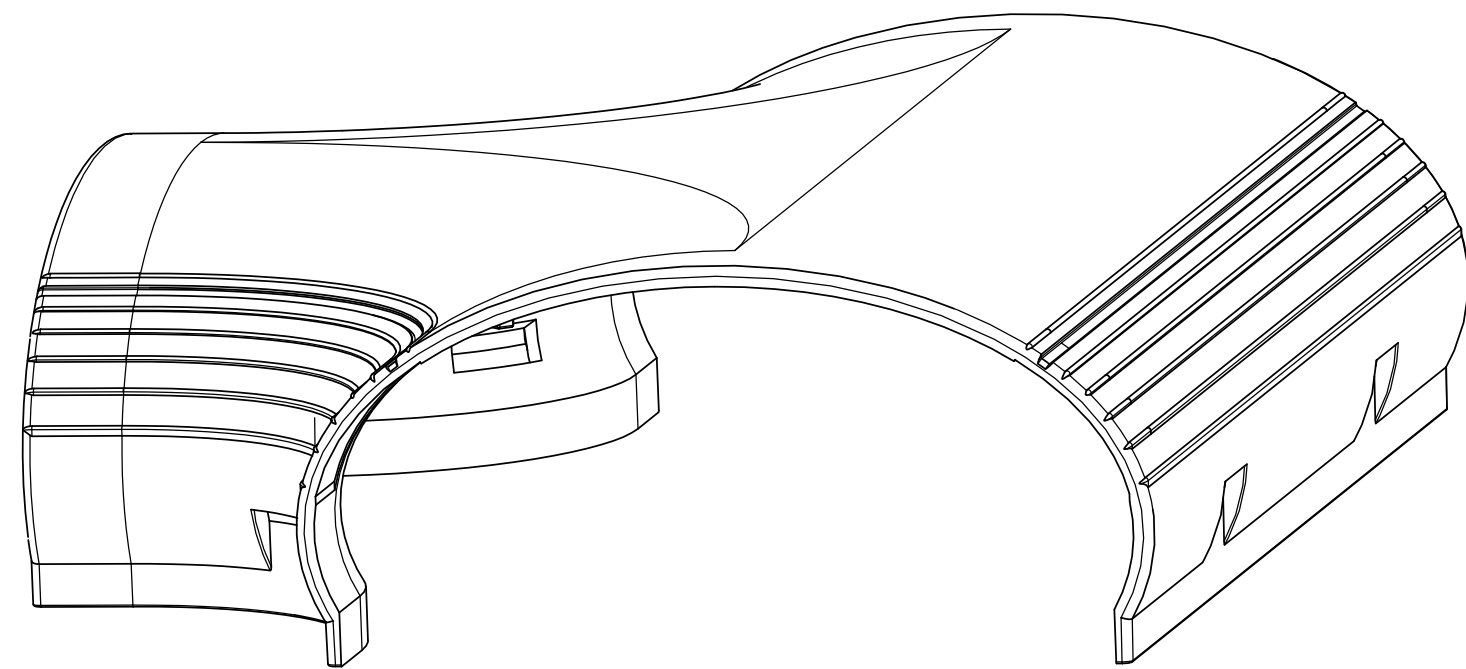
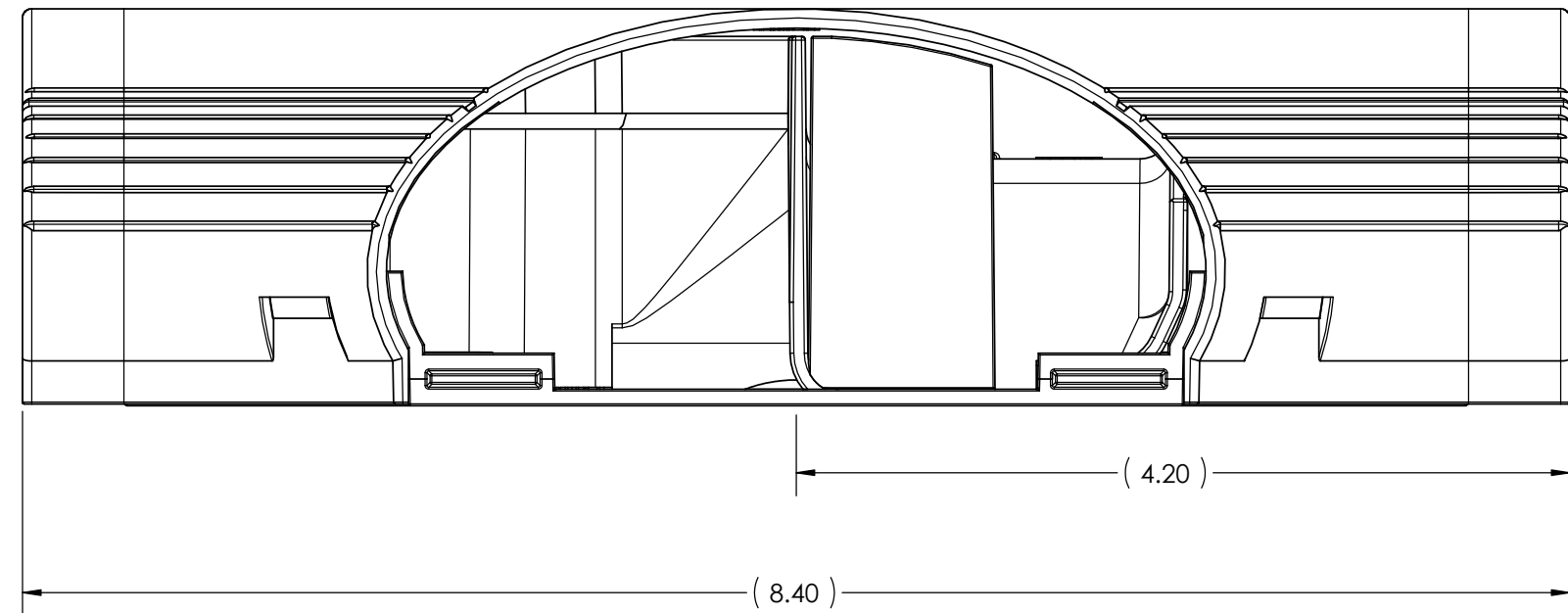

PART NO. DESCRIPTION  
MCR\_-TE

COLOR: CONTACT FACTORY FOR AVAILABLE COLORS.

REDUCED  
NO SCALE

**HellermannTyton**  
ALL PROPRIETARY RIGHTS IN THE SUBJECT MATTER SHOWN ON THIS DRAWING ARE EXCLUSIVE PROPERTY OF HELLERMANN TYTON

name	date	city, state

**NOTES**

- THIS ASSEMBLY ACCEPTS (3) MCR RACEWAYS.
- ALL DUPLICATE FIGURES ARE SYMETRICAL ABOUT  $\phi$ .

<b>REVISION</b>	level	<b>03</b>
	by	KAC
	date	06/21/2006
	ECN #	010451
	part level	-

<b>TOLERANCES</b>	.XXXX	= ±.0005
	.XXX	= ±.005
	.XX	= ±.01
	.X	= ±.03
	∠	= ±0.5°
unless otherwise specified		
units	inches	

<b>PART</b>	number	MCR_TE	phase	Production
	name	MULTI-CHANNEL RACEWAY TEE		
	material	HIPS HIGH IMPACT POLYSTYRENE		

<b>DRAWING</b>	formal version N	C	SW 2006	scale	1:1
	computer file name	DT2013108CST_03			
	drawn	M.E.F.	checked	KAC	approved
	date	12/02/1998	checked	06/21/2006	approved
	type	Customer	sheet 1 of 1		
number	<b>DT2013108CST</b>				