



Chipsmall Limited consists of a professional team with an average of over 10 year of expertise in the distribution of electronic components. Based in Hongkong, we have already established firm and mutual-benefit business relationships with customers from,Europe,America and south Asia,supplying obsolete and hard-to-find components to meet their specific needs.

With the principle of "Quality Parts,Customers Priority,Honest Operation,and Considerate Service",our business mainly focus on the distribution of electronic components. Line cards we deal with include Microchip,ALPS,ROHM,Xilinx,Pulse,ON,Everlight and Freescale. Main products comprise IC,Modules,Potentiometer,IC Socket,Relay,Connector.Our parts cover such applications as commercial,industrial, and automotives areas.

We are looking forward to setting up business relationship with you and hope to provide you with the best service and solution. Let us make a better world for our industry!



## Contact us

Tel: +86-755-8981 8866 Fax: +86-755-8427 6832

Email & Skype: [info@chipsmall.com](mailto:info@chipsmall.com) Web: [www.chipsmall.com](http://www.chipsmall.com)

Address: A1208, Overseas Decoration Building, #122 Zhenhua RD., Futian, Shenzhen, China



PART  
NAME

FUTURA CABINET

PART  
No.

MD-1960 THRU MD-1962

**MATERIAL:**

BODY, BOTTOM & REAR PANEL \_\_\_\_ 20 GA. STEEL  
 FRONT PANEL \_\_\_\_ 18 GA. STEEL

**FINISH:**

BODY, BOTTOM & REAR PANEL \_\_\_\_ ROYAL BLUE TEXTURED  
 FRONT PANEL \_\_\_\_ WHITE TEXTURED  
 RUBBER FEET \_\_\_\_ GRAY

BOTTOM AND REAR PANEL ASSEMBLED WITH #6 x 1/4 LG. SELF TAPPING SCREWS.

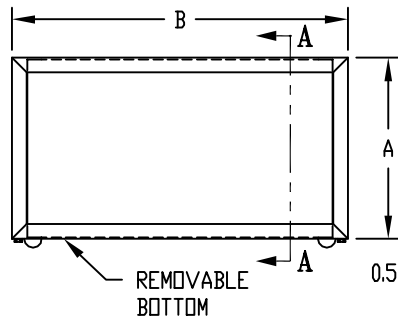

FRONT VIEW

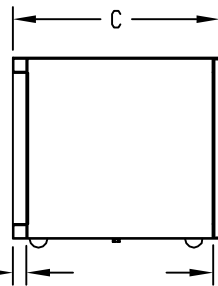

SECTION "A-A"

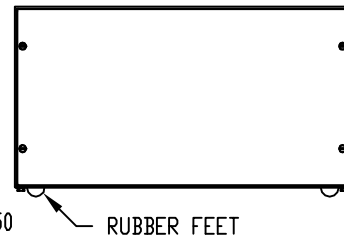

REAR VIEW

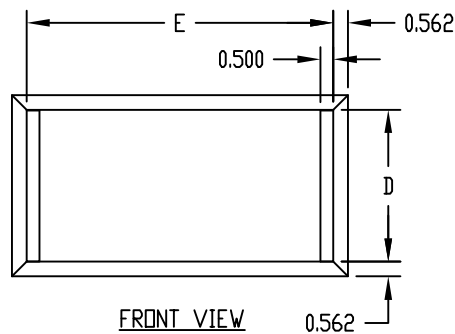
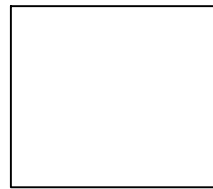
FRONT VIEW  
(LESS FRONT PANEL)

SIDE VIEW

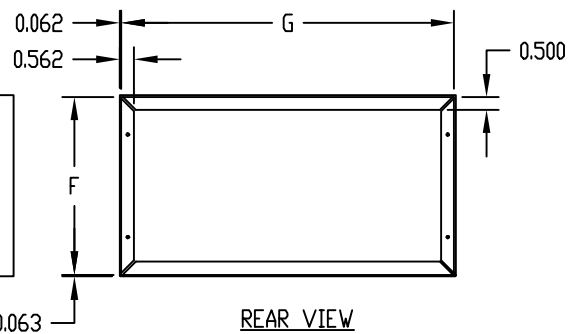
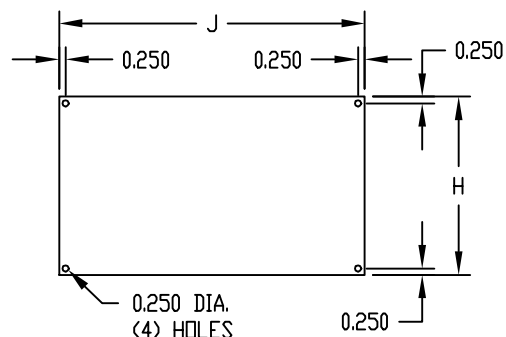
REAR VIEW  
(LESS REAR PANEL)

FRONT PANEL  
 (HOLES IN PANEL ARE FOR HANGING  
 DURING THE FINISHING OPERATION)

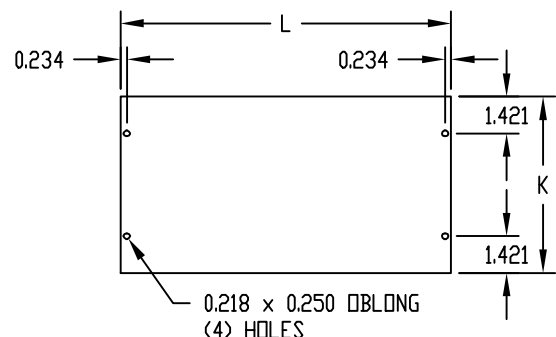

REAR PANEL

PART No.	OVERALL			PANEL SPACE				PANELS			
				FRONT		REAR		FRONT		REAR	
	A	B	C	D	E	F	G	H	J	K	L
MD-1960	7.000	13.000	8.000	5.875	11.875	6.875	12.875	6.890	11.812	6.812	12.781
MD-1961	8.000	14.000	9.000	6.875	12.875	7.875	13.875	7.890	12.812	7.812	13.781
MD-1962	8.000	16.000	9.000	6.875	14.875	7.875	15.875	7.890	14.812	7.812	15.781