



Chipsmall Limited consists of a professional team with an average of over 10 year of expertise in the distribution of electronic components. Based in Hongkong, we have already established firm and mutual-benefit business relationships with customers from,Europe,America and south Asia,supplying obsolete and hard-to-find components to meet their specific needs.

With the principle of “Quality Parts,Customers Priority,Honest Operation,and Considerate Service”,our business mainly focus on the distribution of electronic components. Line cards we deal with include Microchip,ALPS,ROHM,Xilinx,Pulse,ON,Everlight and Freescale. Main products comprise IC,Modules,Potentiometer,IC Socket,Relay,Connector.Our parts cover such applications as commercial,industrial, and automotives areas.

We are looking forward to setting up business relationship with you and hope to provide you with the best service and solution. Let us make a better world for our industry!



Contact us

Tel: +86-755-8981 8866 Fax: +86-755-8427 6832

Email & Skype: info@chipsmall.com Web: www.chipsmall.com

Address: A1208, Overseas Decoration Building, #122 Zhenhua RD., Futian, Shenzhen, China





110-240 V MICRODRIVERS



FEATURES / BENEFITS

- ▲ Energy efficient switch mode power electronics
- ▲ Short and open circuit protected
- ▲ Small compact size
- ▲ Rugged design with terminal cover & cable grip
- ▲ Over-voltage protection
- ▲ Resetting thermal shutdown safety feature
- ▲ UL recognized component
- ▲ Meets lighting approbation requirements (CE & ENEC)

OPERATING CONDITIONS

- ▲ Operating Ambient Temperature: -20°C to +45°C (-4°F to +113°F)
- ▲ Ambient Storage Temperature: -20°C to +80°C (-4°F to +176°F)
- ▲ Maximum Case Temperature: <+85°C (185°F)
- ▲ Input Voltage 110-240Vac 50 / 60 Hz
- ▲ V_{out} : MDU4 = 4-15VDC, MDU9 = 4-32VDC

APPLICATIONS

- ▲ Architectural lighting
- ▲ Cove & cornice lighting
- ▲ Display case lighting
- ▲ Signage
- ▲ Reading lamps
- ▲ Marker & orientation lights
- ▲ Landscape lighting
- ▲ Refrigeration lighting

PART NUMBERS

Part Number	Description	LED Configuration
MDU4-SC-35	MicroDriver 4 SC	1-4 1 Watt LEDs
MDU9-SC-3570	MicroDriver 9 SC	1-9 1 Watt LEDs <u>or</u> 1-4 3 Watt LEDs

Dialight reserves the right to make changes at any time in order to supply the best product possible.

Dialight Corporation

1501 Route 34 South • Farmingdale, NJ 07727 USA

Tel: (1) 732-919-3119 • Fax: (1) 732-751-5778 • www.dialight.com



MEDEXLUMMD_C

MECHANICAL DRAWING

PHYSICAL ASSEMBLY

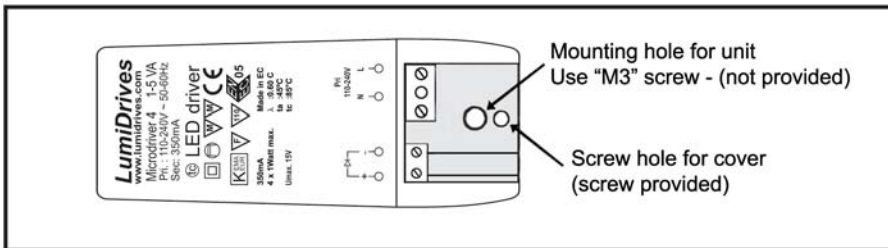

Easily removable cover

MDU4-SC-35 - 1 x 4 LEDs (350mA)

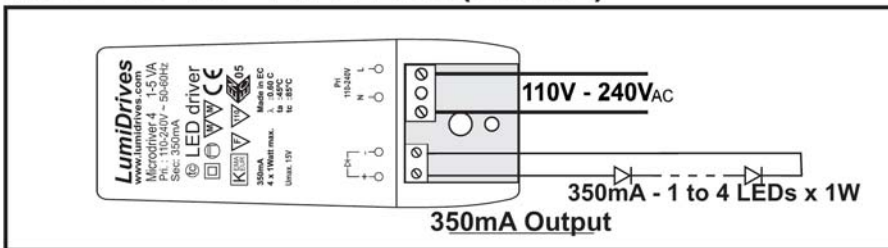

Input and output screw terminations

MDU9-SC-35/70 - 1 x 9 LEDs (350mA)

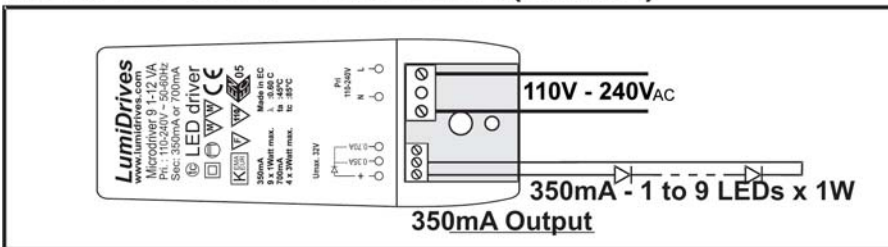

MDU9-SC-35/70 1 x 4 LEDs (700mA)

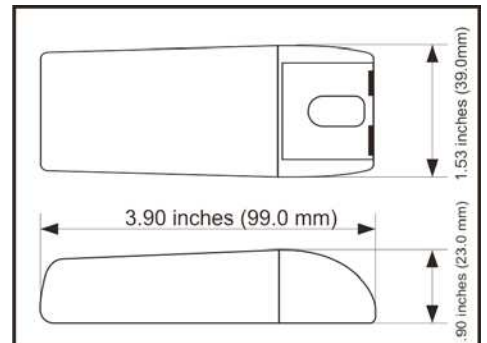
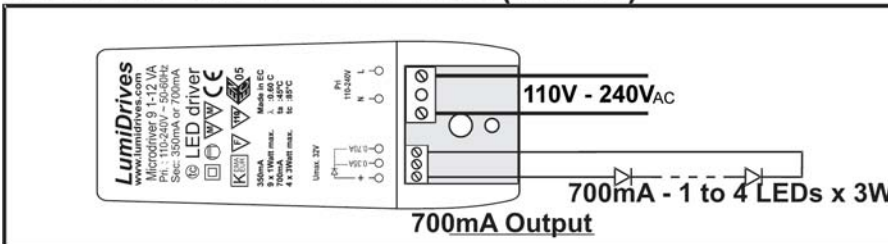

Dialight reserves the right to make changes at any time in order to supply the best product possible.

Dialight Corporation

1501 Route 34 South • Farmingdale, NJ 07727 USA
Tel: (1) 732-919-3119 • Fax: (1) 732-751-5778 • www.dialight.com



MEDEXLUMMD_C