



Chipsmall Limited consists of a professional team with an average of over 10 year of expertise in the distribution of electronic components. Based in Hongkong, we have already established firm and mutual-benefit business relationships with customers from,Europe,America and south Asia,supplying obsolete and hard-to-find components to meet their specific needs.

With the principle of “Quality Parts,Customers Priority,Honest Operation,and Considerate Service”,our business mainly focus on the distribution of electronic components. Line cards we deal with include Microchip,ALPS,ROHM,Xilinx,Pulse,ON,Everlight and Freescale. Main products comprise IC,Modules,Potentiometer,IC Socket,Relay,Connector.Our parts cover such applications as commercial,industrial, and automotives areas.

We are looking forward to setting up business relationship with you and hope to provide you with the best service and solution. Let us make a better world for our industry!



Contact us

Tel: +86-755-8981 8866 Fax: +86-755-8427 6832

Email & Skype: info@chipsmall.com Web: www.chipsmall.com

Address: A1208, Overseas Decoration Building, #122 Zhenhua RD., Futian, Shenzhen, China



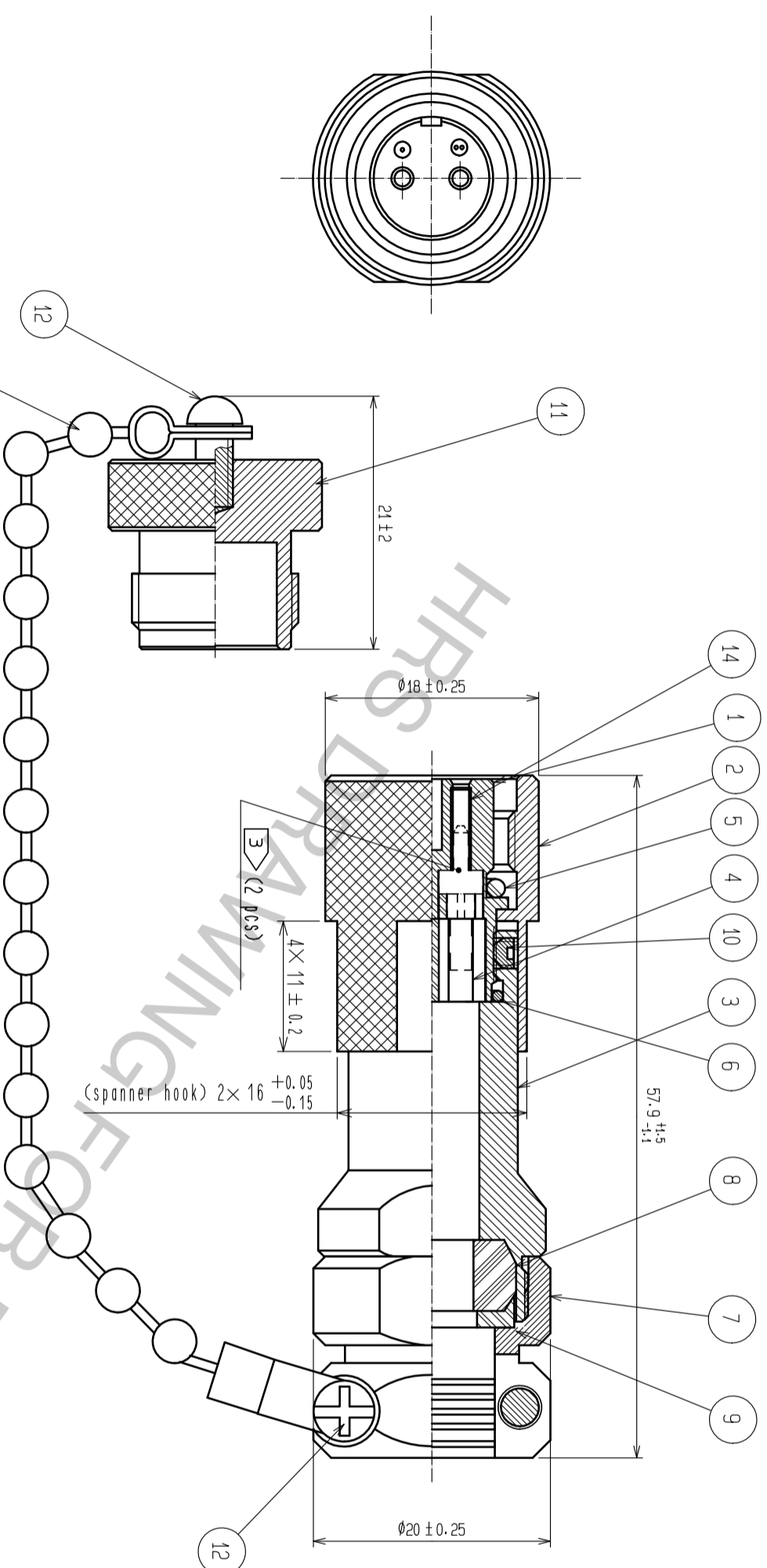

NOTE 1. The procedure of cable assemblies would be confirm to the ETAD-K0189.

2. When this plug is mated with a MF10S receptacle, the clamp torque of the part No. ③ should be 1.5 to 3 N.m. Following MF10-T1 can be used as simple substitution of a torque wrench.

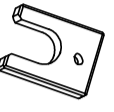
EXCLUSIVE PLASTIC SPANNER	PART NO.	CODE NO.
	MF10-T1	CL709-0205-B

③ The ferrule parts are not contained. Please use the 'MU simplex simplified plug' chosen from the Table 1 according to the outer diameter of the optical fiber.

Table 1. MU simplex simplified plug (without hood) ③

Part No.	HRS CL No.	Ferrule Inner dia.
HMUA-FK-A125(C01)	CL710-0099-2-01	φ 0.125 ^{+0.001} ₀
HMUA-FK-A1255(C01)	CL710-0107-9-01	φ 0.1255 ^{+0.001} ₀
HMUA-FK-A126(C01)	CL710-0100-0-01	φ 0.126 ^{+0.001} ₀

NO.	MATERIAL	FINISH . REMARKS	NO.	MATERIAL	FINISH . REMARKS
7	BRASS	CHROME PLATING	14	ZIRCONIA	
6	SYNTHETIC RUBBER		13	STAINLESS STEEL	
5	SYNTHETIC RUBBER		12	STAINLESS STEEL	NYELOCK
4	SYNTHETIC RESIN		11	ALUMINIUM ALLOY	ANODIC OXIDE COATING
3	ALUMINIUM ALLOY	ANODIC OXIDE COATING	10	STAINLESS STEEL	
2	BRASS	CHROME PLATING	9	SYNTHETIC RESIN	
1	ZINC DIECAST	CHROME PLATING	8	SYNTHETIC RUBBER	

UNITS	SCALE	COUNT	DESCRIPTION OF REVISIONS	DESIGNED	CHECKED	DATE
mm	2 : 1					

APPROVED	MT. SHIBUTANI	18.03.16	DRAWING	EDC-175688-31-00
CHECKED	.FS. YOSHIDA	18.03.16	PART	MF10S-WP7C01-0200(31)
DESIGNED	.SI. MATSUMOTO	18.03.15	NO.	
DRAWN	.SR. TOYOKAWA	18.03.15	CODE	CL709-0203-2-31