

Chipsmall Limited consists of a professional team with an average of over 10 year of expertise in the distribution of electronic components. Based in Hongkong, we have already established firm and mutual-benefit business relationships with customers from,Europe,America and south Asia,supplying obsolete and hard-to-find components to meet their specific needs.

With the principle of “Quality Parts,Customers Priority,Honest Operation,and Considerate Service”,our business mainly focus on the distribution of electronic components. Line cards we deal with include Microchip,ALPS,ROHM,Xilinx,Pulse,ON,Everlight and Freescale. Main products comprise IC,Modules,Potentiometer,IC Socket,Relay,Connector.Our parts cover such applications as commercial,industrial, and automotives areas.

We are looking forward to setting up business relationship with you and hope to provide you with the best service and solution. Let us make a better world for our industry!



Contact us

Tel: +86-755-8981 8866 Fax: +86-755-8427 6832

Email & Skype: info@chipsmall.com Web: www.chipsmall.com

Address: A1208, Overseas Decoration Building, #122 Zhenhua RD., Futian, Shenzhen, China

THIS DRAWING IS A CONTROLLED DOCUMENT FOR AMP INC. IT IS SUBJECT TO CHANGE AND THE USER IS ADVISED TO CHECK THE DRAWING BEING CONTACTED FOR THE LATEST REVISION.

THIS INFORMATION IS CONFIDENTIAL AND IS DISCLOSED TO YOU ON THE CONDITION THAT YOU WILL NOT DISCLOSE OR REPRODUCE IT WITHOUT WRITTEN AUTHORIZATION FROM AMP INCORPORATED, HARRISBURG, PA.

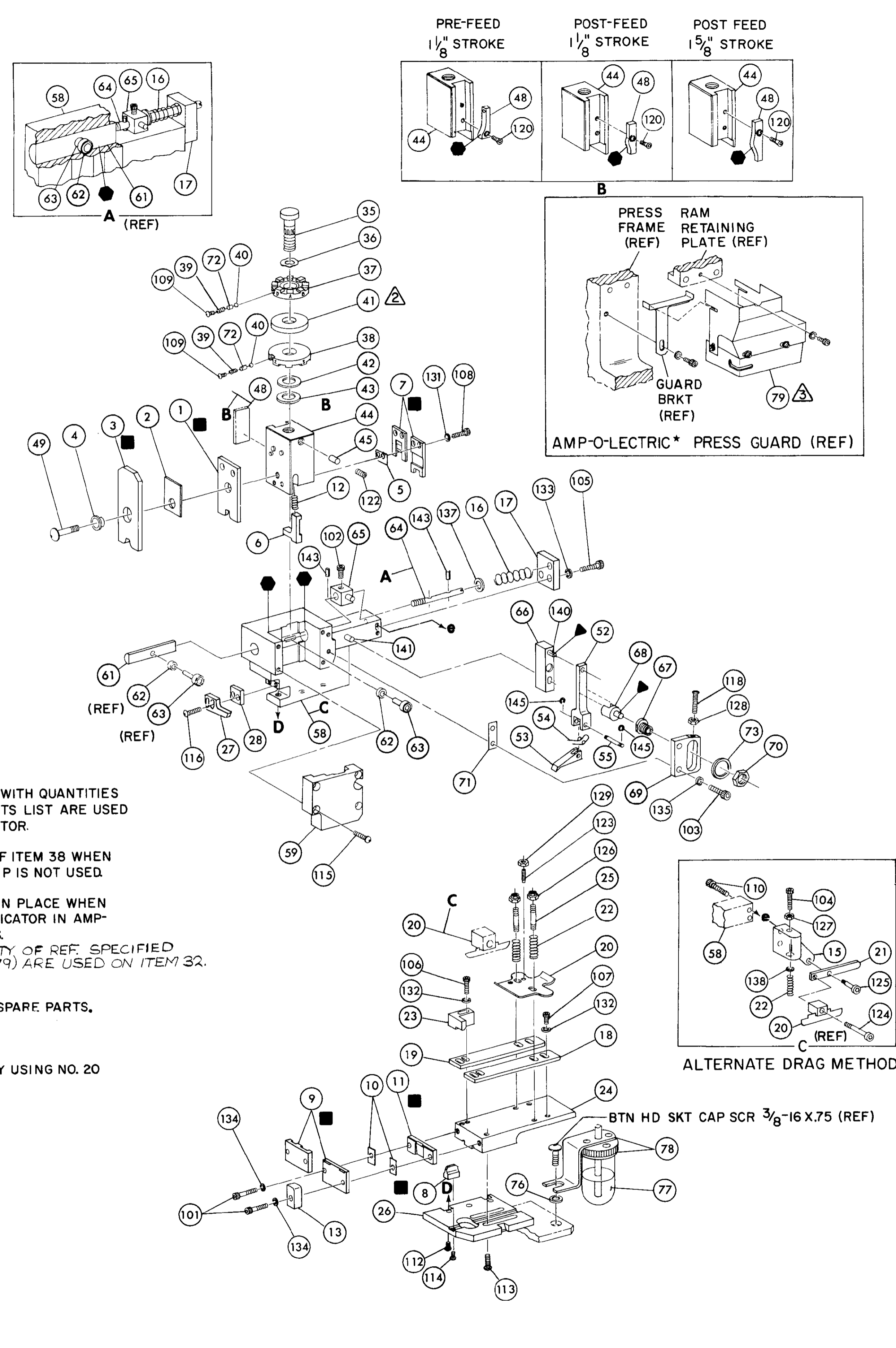

- NOTES:**
- 1. ONLY THE ITEMS WITH QUANTITIES SPECIFIED ON PARTS LIST ARE USED ON THIS APPLICATOR.
 - 2. USED IN PLACE OF ITEM 38 WHEN INSULATION CRIMP IS NOT USED.
 - 3. GUARD MUST BE IN PLACE WHEN OPERATING APPLICATOR IN AMP-O-LECTRIC PRESS.
 - 4. PARTS WITH QTY OF REF. SPECIFIED (EXCEPT ITEM 79) ARE USED ON ITEM 32.
- KEY:**
- RECOMMENDED SPARE PARTS.
 - ▲ LUBRICATE DAILY USING NO. 20 MACHINE OIL.
 - GREASE LIGHTLY.

| REF. | QTY | PART NO | DESCRIPTION | ITEM NO |
|------|-----|----------------|--|---------|
| REF. | 145 | 21045-3 | RING, RETAINING 'C' (.187 DIA) FEED PIN | 59 |
| REF. | 144 | 454220-1 | CAP, RAM | 58 |
| REF. | 143 | 5-21028-1 | PIN, SLOT SPG (.12 DIA X .50) FD ADJ ROD | 57 |
| REF. | 142 | | | 56 |
| REF. | 141 | 1-21030-7 | PIN, DOWEL (.187 DIA X 1.50) HOUSING | 55 |
| REF. | 140 | 1-21030-1 | PIN, DOWEL (.187 DIA X .50) LEVER | 54 |
| REF. | 139 | REF. 240624-1 | PIN, FEED FINGER | 53 |
| REF. | 138 | REF. 691499-1 | SPRING, FEED FINGER | 52 |
| REF. | 137 | REF. 240635-1 | FINGER, FEED | 51 |
| REF. | 136 | REF. 240634-1 | LEVER, TERMINAL | 50 |
| REF. | 135 | 7-21002-9 | WASHER, LOCK (NO 6) DRAG SPRING | 49 |
| REF. | 134 | 1 690602-5 | WASHER, LOCK (NO 10) FEED ADJ PLATE | 48 |
| REF. | 133 | | WASHER, LOCK (NO 10) SHEAR PLATES | 47 |
| REF. | 132 | | WASHER, LOCK (NO 10) FEED ROD GUIDE | 46 |
| REF. | 131 | 1 690191-1 | WASHER, LOCK (NO 8) STRIP GUIDE | 45 |
| REF. | 130 | 1 455674-1 | WASHER, LOCK (NO 8) SHEAR BLADE | 44 |
| REF. | 129 | 1 690125-1 | PLUG, NYLON | 43 |
| REF. | 128 | 1 690124-1 | RAM | 42 |
| REF. | 127 | | WASHER, LAMINATED | 41 |
| REF. | 126 | 2 23241-6 | WASHER, RAM | 40 |
| REF. | 125 | 2 690170-1 | SPACER, DISC | 39 |
| REF. | 124 | 1 690142-1 | BALL, STEEL | 38 |
| REF. | 123 | 1 9-690692-9 | SPRING, COMPRESSION | 37 |
| REF. | 122 | 1 22480-5 | DISC, INSULATION | 36 |
| REF. | 121 | 1 690212-1 | DISC, WIRE | 35 |
| REF. | 120 | | WASHER, SPRING | 34 |
| REF. | 119 | | POST, RAM | 33 |
| REF. | 118 | 1 458980-1 | SCR, BTN HD SKT CAP (6-32 X .38) CAM | 32 |
| REF. | 117 | | SCR, RD HD MACH (6-32 X 1.50) FEED ADJ | 31 |
| REF. | 116 | 2 2-21002-2 | SCR, BTN HD SKT CAP (8-32 X .50) STRIPPER | 30 |
| REF. | 115 | 2 2-21002-9 | SCR, BTN HD SKT CAP (10-32 X .75) HSG CAP | 29 |
| REF. | 114 | 1 22733-8 | SCR, BTN HD SKT CAP (8-32 X .38) (LOC-WEL) ANVIL | 28 |
| REF. | 113 | 4 3-21002-3 | SCR, BTN HD SKT CAP (1/4-20 X .50) STR GDE PL | 27 |
| REF. | 112 | 2 2-22733-9 | SCR, BTN HD SKT CAP (1/4-20 X .75) BASE PL | 26 |
| REF. | 111 | | SCR, SKT HD CAP (6-32 X 1.00) DRAG ADAPTOR | 25 |
| REF. | 110 | 2 2-21000-4 | SCR, SKT HD CAP (6-32 X .25) (LOC-WEL) CP DISC | 24 |
| REF. | 109 | 2 23030-1 | SCR, SKT HD CAP (6-32 X .25) (LOC-WEL) CP DISC | 23 |
| REF. | 108 | 2 2-21000-6 | SCR, SKT HD CAP (8-32 X .38) SHEAR BLADE | 22 |
| REF. | 107 | 3 7-21000-4 | SCR, SKT HD CAP (8-32 X .31) STRIP GUIDE | 21 |
| REF. | 106 | 2 2-21000-8 | SCR, SKT HD CAP (8-32 X .62) STRIP GUIDE | 20 |
| REF. | 105 | REF. 3-21000-7 | SCR, SKT HD CAP (10-32 X .75) FD ROD GUIDE | 19 |
| REF. | 104 | REF. 3-21000-9 | SCR, SKT HD CAP (10-32 X 1.00) DRAG SPRING | 18 |
| REF. | 103 | REF. 3-21000-6 | SCR, SKT HD CAP (10-32 X .62) FD ADJ PLATE | 17 |
| REF. | 102 | REF. 3-21000-4 | SCR, SKT HD CAP (10-32 X .38) PIVOT BLK | 16 |
| REF. | 101 | REF. 3-21000-8 | SCR, SKT HD CAP (10-32 X .88) SHEAR PLATE | 15 |
| REF. | 79 | 455745-1 | GUARD, WINDOW | 14 |
| REF. | 78 | 465184-9 | LUBRICATOR ASSY | 13 |
| REF. | 77 | 455985-1 | OIL, LUBRICATING | 12 |
| REF. | 76 | 454406-1 | SPACER, LUB BRACKET | 11 |
| REF. | 75 | | | 10 |
| REF. | 74 | 1 3-690482-4 | SPACER, HOLD DOWN | 9 |
| REF. | 73 | 1 7-240655-8 | SPRING, HOLD DOWN | 8 |
| REF. | 72 | 1 690474-6 | PLATE, REAR SHEAR | 7 |
| REF. | 71 | 1 1-455892-9 | SPACER, SHEAR PLATE | 6 |
| REF. | 70 | 1 4-240641-8 | SPACER, TUBULAR | 5 |
| REF. | 69 | 1 238009-1 | SPACER, INSULATION | 4 |
| REF. | 68 | 1 1-456134-4 | CRIMPER, INSULATION | 3 |
| REF. | 67 | 1 455888-7 | SPACER, INSULATION | 2 |
| REF. | 66 | 1 1-456404-8 | CRIMPER, WIRE | 1 |

| QTY | PART NO | DESCRIPTION | ITEM NO |
|------|---------|--------------|---------------------|
| REF. | 79 | 455745-1 | GUARD, WINDOW |
| REF. | 78 | 465184-9 | LUBRICATOR ASSY |
| REF. | 77 | 455985-1 | OIL, LUBRICATING |
| REF. | 76 | 454406-1 | SPACER, LUB BRACKET |
| REF. | 75 | | |
| REF. | 74 | 1 3-690482-4 | SPACER, HOLD DOWN |
| REF. | 73 | 1 7-240655-8 | SPRING, HOLD DOWN |
| REF. | 72 | 1 690474-6 | PLATE, REAR SHEAR |
| REF. | 71 | 1 1-455892-9 | SPACER, SHEAR PLATE |
| REF. | 70 | 1 4-240641-8 | SPACER, TUBULAR |
| REF. | 69 | 1 238009-1 | SPACER, INSULATION |
| REF. | 68 | 1 1-456134-4 | CRIMPER, INSULATION |
| REF. | 67 | 1 455888-7 | SPACER, INSULATION |
| REF. | 66 | 1 1-456404-8 | CRIMPER, WIRE |
| REF. | 65 | | |
| REF. | 64 | | |
| REF. | 63 | | |
| REF. | 62 | | |
| REF. | 61 | | |
| REF. | 60 | | |

| CRIMPING DATA | | | | APPLICATOR WILL APPLY | |
|---------------|--------------|-----------|-------------------|-----------------------|-------|
| PAD LTR | CRIMP HEIGHT | WIRE SIZE | WIRE STRIP LENGTH | | |
| A | .053 | 18 | | | 36068 |
| B | .047 | 20 | | | 62886 |
| C | .044 | 22 | | | 63021 |
| D | NOT USED | | | | |

| CRIMP | SIZE | TYPE | FEED | APPL INST |
|------------------|------|------|-----------|-----------|
| WIRE | .070 | "F" | | |
| INSUL | .140 | "F" | .705 | A1 8039 |
| WIRE RANGE | 18 | | | |
| INSULATION RANGE | | | .090-.130 | |
| PRESS NO | | | | 565435-5 |

| | | | |
|------------------------------|----------------|-------------------|-----|
| REMARKS | | NO | REV |
| APPL USED ON MACHINE PART NO | | TO APPLY TERMINAL | |
| CUSTOMER NAME | MACH SERIAL NO | DISTRIBUTION | |
| ADDRESS | APPL SERIAL NO | ORIGINAL | |
| CITY | PURCHASE ORDER | CUSTOMER COPY | |
| | ENG APP | FIELD ENG COPY | |

| | | | | |
|----|--------------------|-----|-------|------------------|
| E1 | 015A-0485-99 | TM | 12-90 | SET UP PAGE 10-1 |
| E | 0150-6815-96 | WBS | 12-90 | 458638-1 593A |
| D | EN 1161355 | WBS | 11-85 | DR 9/27/97 AP |
| C | REV PER ECU R-5503 | WBS | 11-84 | DR 9/27/97 AP |
| B | REV PER ECU R-3858 | WBS | 11-84 | DR 9/27/97 AP |
| A | REV PER ECU R-3499 | WBS | 11-80 | DR 9/27/97 AP |
| A | REV PER ECU R-3341 | WBS | 11-80 | DR 9/27/97 AP |