



Chipsmall Limited consists of a professional team with an average of over 10 year of expertise in the distribution of electronic components. Based in Hongkong, we have already established firm and mutual-benefit business relationships with customers from,Europe,America and south Asia,supplying obsolete and hard-to-find components to meet their specific needs.

With the principle of “Quality Parts,Customers Priority,Honest Operation,and Considerate Service”,our business mainly focus on the distribution of electronic components. Line cards we deal with include Microchip,ALPS,ROHM,Xilinx,Pulse,ON,Everlight and Freescale. Main products comprise IC,Modules,Potentiometer,IC Socket,Relay,Connector.Our parts cover such applications as commercial,industrial, and automotives areas.

We are looking forward to setting up business relationship with you and hope to provide you with the best service and solution. Let us make a better world for our industry!



Contact us

Tel: +86-755-8981 8866 Fax: +86-755-8427 6832

Email & Skype: info@chipsmall.com Web: www.chipsmall.com

Address: A1208, Overseas Decoration Building, #122 Zhenhua RD., Futian, Shenzhen, China



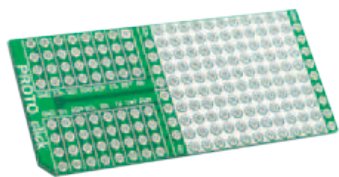

PROTO **click™**

1. Introduction

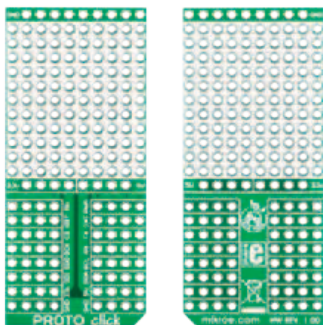

PROTO click™ is an accessory board in **mikroBUS™** form factor. It features 10x11 prototyping area as well as additional power pads. It can be used to assemble custom electronics thus creating a custom click™ board. PROTO click™ contains **mikroBUS™** I²C (SDA, SCL), SPI (MISO, MOSI, SCK, CS), UART (TX, RX), PWM, INT, AN and RST lines from the target board microcontroller. The board provides 3.3 V and 5 V power supply.

2. Soldering the headers

Before using your click™ board, make sure to solder 1x8 male headers to both left and right side of the board. Two 1x8 male headers are included with the board in the package.

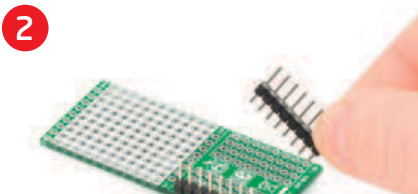

Turn the board upside down so that bottom side is facing you upwards. Place shorter pins of the header into the appropriate soldering pads.

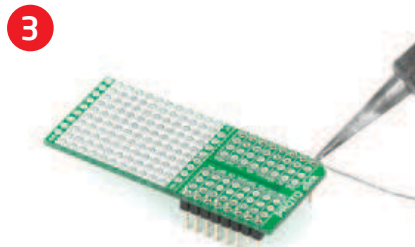

Turn the board upward again. Make sure to align the headers so that they are perpendicular to the board, then solder the pins carefully.

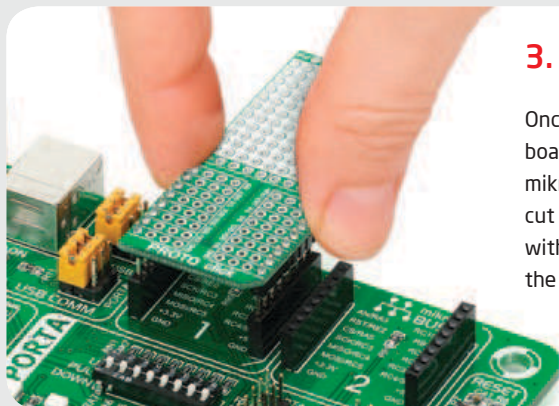

3. Plugging the board in

Once you have soldered the headers your board is ready to be placed into desired mikroBUS™ socket. Make sure to align the cut in the lower-right part of the board with the markings on the silkscreen at the mikroBUS™ socket. If all of the pins are aligned correctly, push the board all the way into the socket.

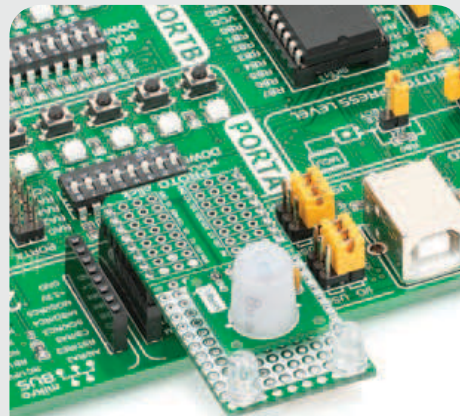

4. Application and features

PROTO click™ board is a cheap and effective solution for creating click board of your own design. Add sensors, drivers, passive components and make the click board which suits your project needs. You can use it with all your favorite development boards with mikroBUS™ sockets.

click™
BOARD
www.mikroe.com



PROTO click Manual
ver. 1.00



5. PROTO click™ Board Schematic

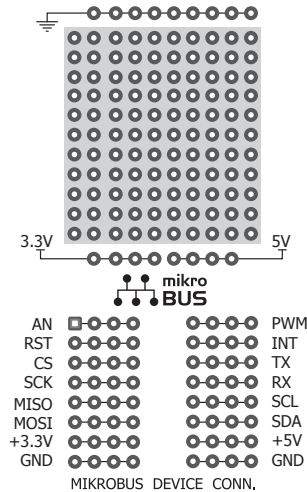

6. Board Dimensions

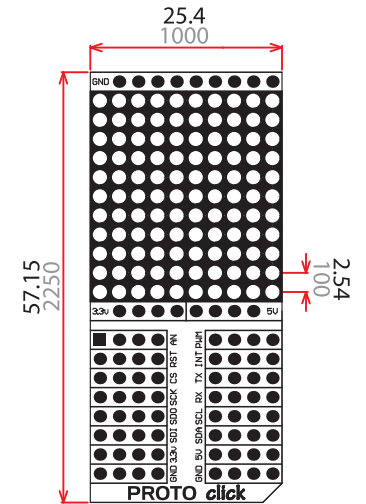

Legend

- mm
- mils

7. Support

MikroElektronika offers **Free Tech Support** (www.mikroe.com/support) until the end of product lifetime, so if something goes wrong, we are ready and willing to help!