



Chipsmall Limited consists of a professional team with an average of over 10 year of expertise in the distribution of electronic components. Based in Hongkong, we have already established firm and mutual-benefit business relationships with customers from,Europe,America and south Asia,supplying obsolete and hard-to-find components to meet their specific needs.

With the principle of “Quality Parts,Customers Priority,Honest Operation,and Considerate Service”,our business mainly focus on the distribution of electronic components. Line cards we deal with include Microchip,ALPS,ROHM,Xilinx,Pulse,ON,Everlight and Freescale. Main products comprise IC,Modules,Potentiometer,IC Socket,Relay,Connector.Our parts cover such applications as commercial,industrial, and automotives areas.

We are looking forward to setting up business relationship with you and hope to provide you with the best service and solution. Let us make a better world for our industry!



Contact us

Tel: +86-755-8981 8866 Fax: +86-755-8427 6832

Email & Skype: info@chipsmall.com Web: www.chipsmall.com

Address: A1208, Overseas Decoration Building, #122 Zhenhua RD., Futian, Shenzhen, China



C&K MIL Series 1-4 Pole Miniature Right

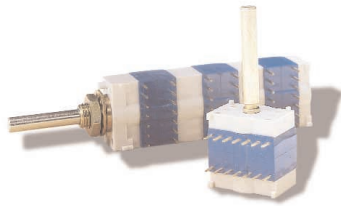

Features/Benefits

- Bushing option for panel mounting
- 1 to 4 poles per bank and up to 5 banks per switch
- Totally sealed (insert molded contacts and terminals)
- Low profile – 12 mm above PCB

Typical Applications

- Telecom switching equipment
- Military communications
- Instrumentation
- Medical monitors

Specifications

CONTACT RATING: Switch: 20 mA, 1 VA max. resistive load
Carry: 1 AMP.
ELECTRICAL LIFE: 20,000 operations.
OPERATING TORQUE: < 6 Ncm.
STOP STRENGTH: > 50 Ncm.
CONTACT RESISTANCE: < 40 mΩ
INSULATION RESISTANCE: 10⁹ Ω
DIELECTRIC STRENGTH: 500 V rms
OPERATING TEMPERATURE: -40°C to + 85°C
STORAGE TEMPERATURE: -55°C to + 85°C

NOTE: Specifications and materials listed above are for switches with standard options. For information on specific and custom switches, consult Customer Service Center.

Materials

HOUSING: Thermoplastic (nylon) and thermoset (diallyl phthalate)
ACTUATOR: Steel
MOVABLE CONTACTS: Brass, gold plated.
ROTOR: Thermoset (polysulfone)
O-RING: Silicone
STATIONARY CONTACTS & TERMINALS: Brass, gold plated.
TERMINAL SEAL: Totally sealed (insert molded).
BUSHING: Brass
STOP PIN: Stainless steel
HARDWARE: Nut: Brass, nickel plated. Washer: Brass, nickel plated.
Gasket: Neopren.

Build-A-Switch

To order, simply select desired option from each category and place in the appropriate box. Available options are shown and described on pages K-23 thru K-25. For additional options not shown in catalog, consult Customer Service Center.



Designation

MIL

Number of Banks

- 1 (STD.) 1 Bank
- 2 2 Banks
- 3 3 Banks
- 4 4 Banks
- 5 5 Banks

Switch Function

- 112S (STD.) SP, 30° Index, 12 pos. no stop
- 102B02 SP, 30° Index, 2 pos.
- 103B03 SP, 30° Index, 3 pos.
- 104B04 SP, 30° Index, 4 pos.
- 105B05 SP, 30° Index, 5 pos.
- 106B06 SP, 30° Index, 6 pos.
- 107B07 SP, 30° Index, 7 pos.
- 108B08 SP, 30° Index, 8 pos.
- 109B09 SP, 30° Index, 9 pos.
- 110B10 SP, 30° Index, 10 pos.
- 111B11 SP, 30° Index, 11 pos.
- 112B12 (STD.) SP, 30° Index, 12 pos.
- 206S (STD.) DP, 30° Index, 6 pos. no stop
- 202B02 DP, 30° Index, 2 pos.
- 203B03 DP, 30° Index, 3 pos.
- 204B04 DP, 30° Index, 4 pos.
- 205B05 DP, 30° Index, 5 pos.
- 206B06 (STD.) DP, 30° Index, 6 pos.
- 303S 3P, 30° Index, 3 pos. no stop
- 302B02 3P, 30° Index, 2 pos.
- 303B03 3P, 30° Index, 3 pos.
- 402S 4P, 30° Index, 2 pos. no stop
- 402B02 4P, 30° Index, 2 pos.

Switching Mode

- N (STD.) Non-shorting BBM (break-before-make)
- C Shorting, MBB (make-before-break)

Mounting Style

- SD (STD.) Without panel mount
- AD (STD.) With panel mount

Actuator Option

- (NONE) (STD.) 4 mm diameter shaft
- M10X3 4 mm shaft with flat
- F2X1 4 mm shaft with screwdriver slot

Actuator Option Angle*

- (NONE) (STD.)
- K0 0° angle
- K30 30° angle
- K60 60° angle
- K90 90° angle
- K120 120° angle
- K180 180° angle
- K270 270° angle

Actuator Option Length**

- 25 (STD.) 25 mm standard shaft

* Other angles available by request
** Other lengths available by request.

C&K MIL Series 1-4 Pole Miniature Right

DESIGNATION



MIL

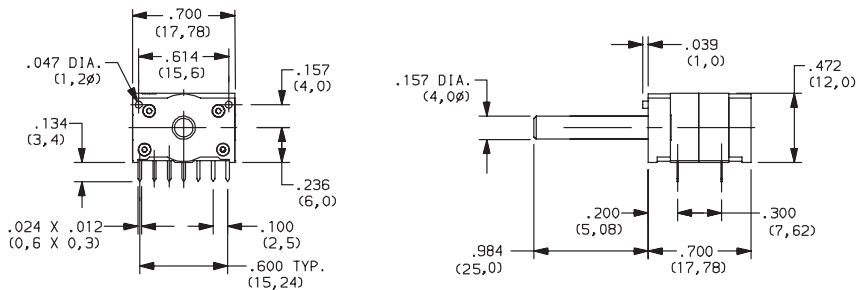

NUMBER OF BANKS



OPTION CODE	DIM. 'L'	WITH BUSHING DIM. 'L'
1	.770 (17,78)	.897 (22,78)
2	1.400 (35,56)	1.597 (40,56)
3	2.100 (53,34)	2.297 (58,34)
4	2.800 (71,12)	3.00 (76,12)
5	3.500 (88,90)	3.697 (93,90)

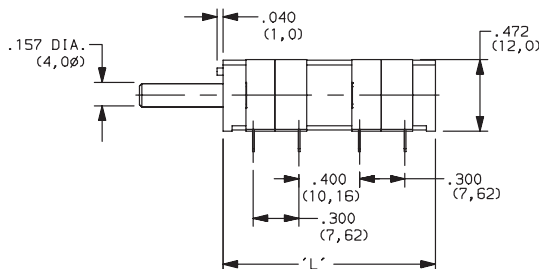

SWITCH FUNCTION



30° INDEXING		
NO. POLES	MODEL NO.	SWITCH FUNCTION
SP	112S	12 Position No Stops
	102B02	2 Positions
	103B03	3 Positions
	104B04	4 Positions
	105B05	5 Positions
	106B06	6 Positions
	107B07	7 Positions
	108B08	8 Positions
	109B09	9 Positions
	110B10	10 Positions
	111B11	11 Positions
	112B12	12 Positions

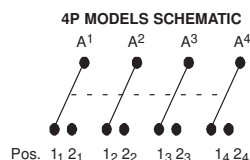
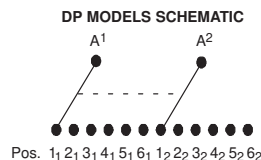
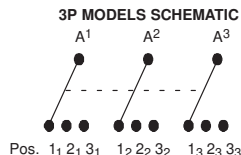
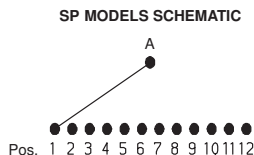

30° INDEXING		
NO. POLES	MODEL NO.	SWITCH FUNCTION
DP	206S	4 Position No Stops
	202B02	2 Positions
	203B03	3 Positions
	204B04	4 Positions
	205B05	5 Positions
	206B06	6 Positions
3P	303S	3 Positions No Stop
	302B02	2 Positions
	303B03	3 Positions
4P	402S	2 Positions No Stop
	402B02	2 Positions

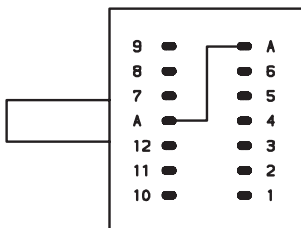

1 POLE
2 - 12 POSITIONS

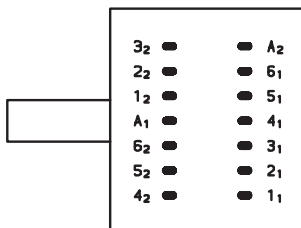

2 POLES
2 - 6 POSITIONS

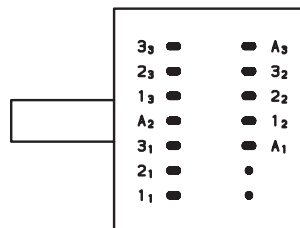

3 POLES
2 - 3 POSITIONS

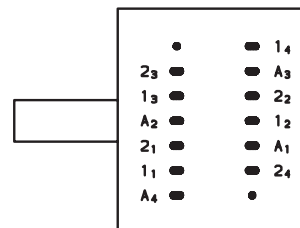

4 CIRCUITS
2 POSITIONS



Third Angle
Projection

C&K MIL Series 1-4 Pole Miniature Right

SWITCHING MODE

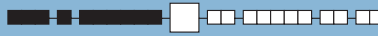

- N** (STD.) NON-SHORTING, BBM (break-before-make)
- C** SHORTING, MBB (make-before-break)

MOUNTING STYLE



SD WITHOUT

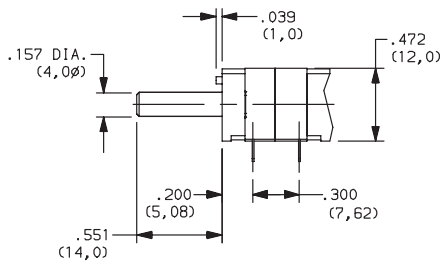

AD WITH PANEL MOUNT

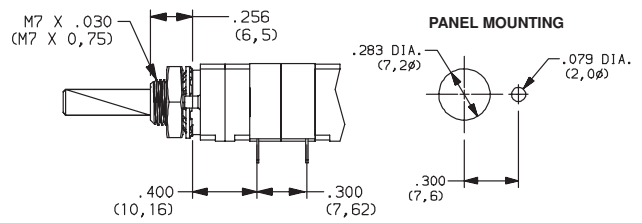

ACTUATOR OPTION



(NONE) (STD.) .157 DIA. (4,0)

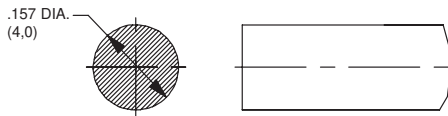

F2X1 SCREWCRIEVER SLOT

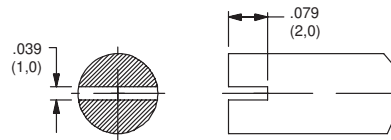

M10X3 FLAT

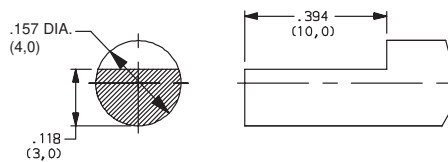

Third Angle
Projection

Dimensions are shown: IN (mm)
Dimensions subject to change

C&K MIL Series 1-4 Pole Miniature Right

ACTUATOR OPTION ANGLE



(NONE) (STD.)

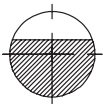

K0 (STD.) 0 ANGLE

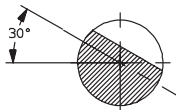

K30 30°

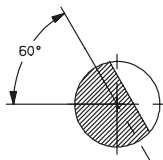

K60 60°

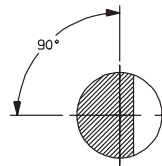

K90 90°

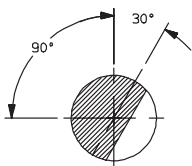

K120 120°

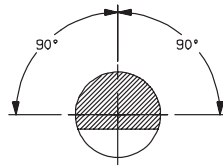

K180 210°

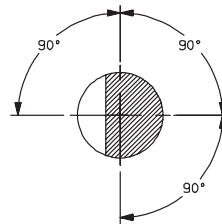

K270 300°



K0 (STD.) 0 ANGLE

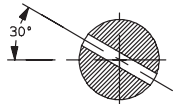

K30 30°

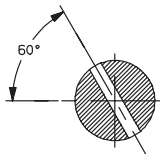

K60 60°

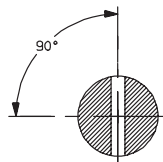

K90 90°

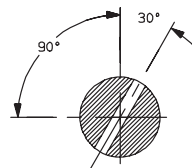

K120 120°



K

Rotary

ACTUATOR LENGTH



25 0,25 mm (.984) STANDARD SHAFT

Other lengths available by request.