



Chipsmall Limited consists of a professional team with an average of over 10 year of expertise in the distribution of electronic components. Based in Hongkong, we have already established firm and mutual-benefit business relationships with customers from,Europe,America and south Asia,supplying obsolete and hard-to-find components to meet their specific needs.

With the principle of "Quality Parts,Customers Priority,Honest Operation,and Considerate Service",our business mainly focus on the distribution of electronic components. Line cards we deal with include Microchip,ALPS,ROHM,Xilinx,Pulse,ON,Everlight and Freescale. Main products comprise IC,Modules,Potentiometer,IC Socket,Relay,Connector.Our parts cover such applications as commercial,industrial, and automotives areas.

We are looking forward to setting up business relationship with you and hope to provide you with the best service and solution. Let us make a better world for our industry!



Contact us

Tel: +86-755-8981 8866 Fax: +86-755-8427 6832

Email & Skype: info@chipsmall.com Web: www.chipsmall.com

Address: A1208, Overseas Decoration Building, #122 Zhenhua RD., Futian, Shenzhen, China



MK04 Kit

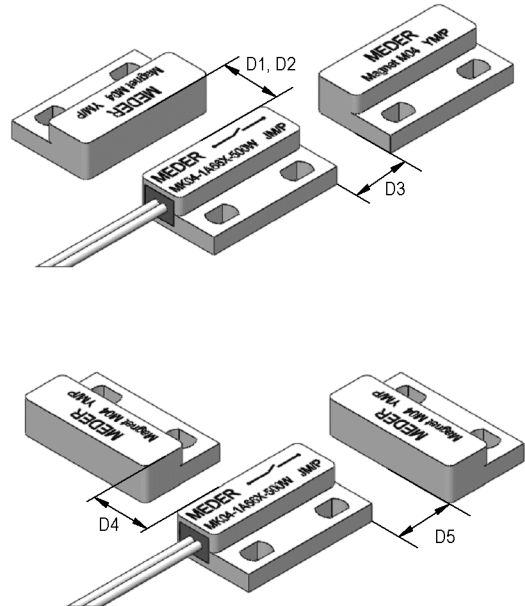
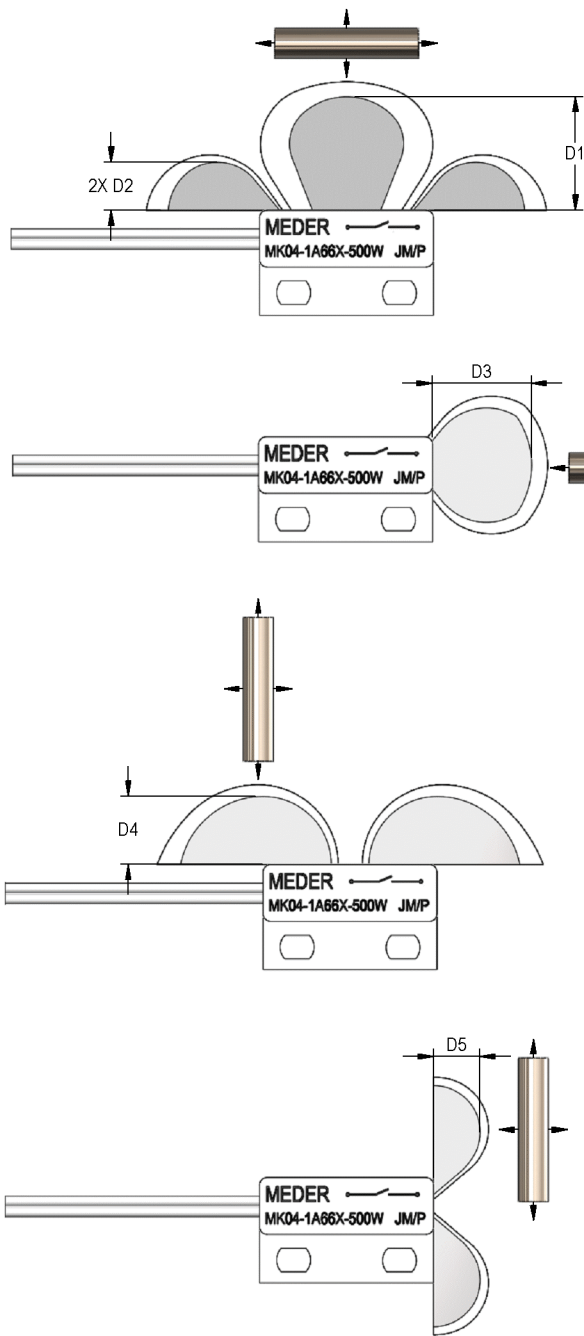

Sensor Dimensions

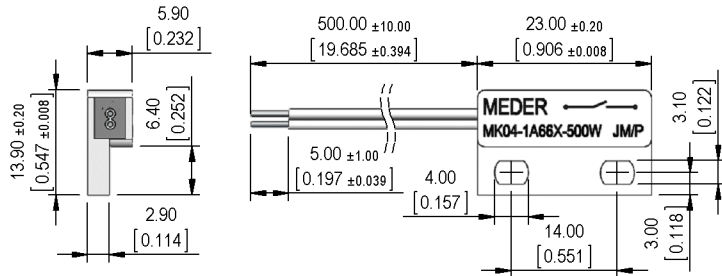

Magnet Dimensions

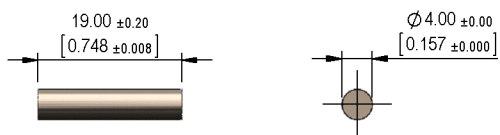

Description	Part Number	Magnetic Sensitivity	Position and Movement Max. Pull-In Distance in mm					Position and Movement Max. Drop-Out Distance in mm					Included in the Kit
		mT	D1	D2	D3	D4	D5	D1	D2	D3	D4	D5	Qty
MK04-1A66B-500W	2242661054	> 1.70	15	6.5	9.3	8.5	8.5	17.5	8	11.4	10.1	10.1	1
MK04-1A66C-500W	2243711054	> 2.30	13	4.4	7.4	7.2	7.2	16.5	6.5	9.9	9.5	9.5	1
MK04-1A66D-500W	2244711054	> 2.70	11	4	5.7	6.5	6.5	14.5	5.5	8.5	9	9	1
M04 Magnet	2500000004	-	-	-	-	-	-	-	-	-	-	-	1

All distance data above is valid for the following magnets:
 4003004003 / 4x19 mm Cylindrical AlNiCo 500 Magnet
 2500000004 / M04 Magnet

Dimensions mm (inches)
 Tolerances acc. to DIN ISO 2768-m
 Toleranzen gem. DIN ISO 2768-m



Products for tomorrow...

Europe: +49 / 7731 8399 0 | Email: info@meder.com
USA: +1 / 508 295 0771 | Email: salesusa@meder.com
Asia: +852 / 2955 1682 | Email: salesasia@meder.com

Item No.:
2240000000
Item:
MK04-KIT

Magnetic properties	Conditions	Min	Typ	Max	Unit
Pull-In	at 20 °C	23		66	AT
Test equipment		KMS-14			

Special Product Data	Conditions	Min	Typ	Max	Unit
Contact - form		A - NO			
Contact rating	Any DC combination of V & A not to exceed their individual max.'s			10	W
Switching voltage	DC or Peak AC			180	V
Carry current	DC or Peak AC			1.25	A
Switching current	DC or Peak AC			0.5	A
Sensor-resistance	measured with 40% overdrive			280	mOhm
Housing material		PBT glass fibre reinforced			
Case color		white			
Sealing compound		Polyurethane			

Environmental data	Conditions	Min	Typ	Max	Unit
Shock	1/2 sine, duration 11 ms, in 3 axis			50	g
Vibration	from 10 - 2000 Hz			20	g
Operating temperature	cable not moved	-30		70	°C
Operating temperature	cable moved	-5		70	°C
Storage temperature		-30		70	°C

Cable specification	Conditions	Min	Typ	Max	Unit
Cable type		flat cable			
Cable material		PVC			
Cross section		0,14 sq-mm			

General data	Conditions	Min	Typ	Max	Unit
Tightening torque	Screw M3 ISO 1207 Disk ISO 7089			0.5	Nm
Mounting advice		over 5m cable, a resistor is recommended.			

Modifications in the sense of technical progress are reserved

Designed at: 04/06/11 Designed by: MAPODACA

Approval at: 05/03/11 Approval by: TLANE

Last Change at: Last Change by:

Approval at: Approval by:

Rev. No.: 01