



Chipsmall Limited consists of a professional team with an average of over 10 year of expertise in the distribution of electronic components. Based in Hongkong, we have already established firm and mutual-benefit business relationships with customers from,Europe,America and south Asia,supplying obsolete and hard-to-find components to meet their specific needs.

With the principle of “Quality Parts,Customers Priority,Honest Operation,and Considerate Service”,our business mainly focus on the distribution of electronic components. Line cards we deal with include Microchip,ALPS,ROHM,Xilinx,Pulse,ON,Everlight and Freescale. Main products comprise IC,Modules,Potentiometer,IC Socket,Relay,Connector.Our parts cover such applications as commercial,industrial, and automotives areas.

We are looking forward to setting up business relationship with you and hope to provide you with the best service and solution. Let us make a better world for our industry!



Contact us

Tel: +86-755-8981 8866 Fax: +86-755-8427 6832

Email & Skype: info@chipsmall.com Web: www.chipsmall.com

Address: A1208, Overseas Decoration Building, #122 Zhenhua RD., Futian, Shenzhen, China



THIS COPY IS PROVIDED ON A RESTRICTED BASIS AND IS NOT TO BE USED IN ANY WAY DETRIMENTAL TO THE INTERESTS OF PANDUIT CORP.

PANDUIT PART NO.	MAX BUNDLE DIA.	PACKAGE QTY	LENGTH "L" ±.3 [7]
MLT2.7WS-LP	2.7" [69]	50	10.2" [259]
MLT4WS-LP	4" [102]	50	14.3" [362]
MLT6WS-LP	6" [152]	50	20.5" [521]
MLT8WS-LP	8" [203]	50	20.8" [679]
MLT4WS-TL	4" [102]	250	14.3" [362]

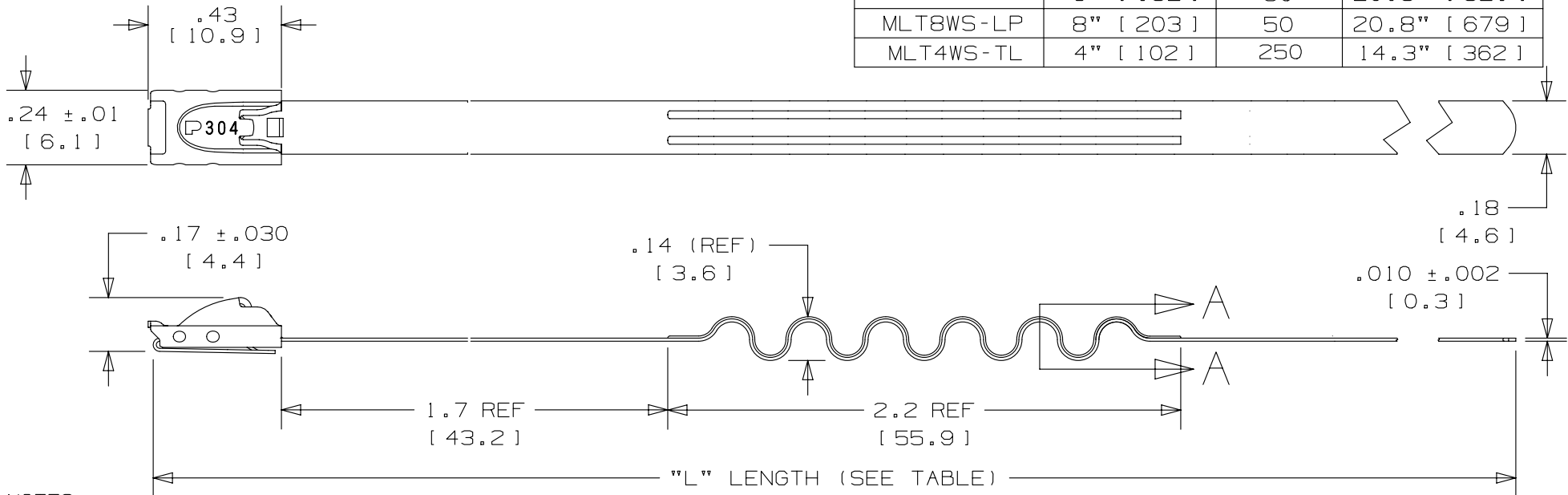

- NOTES:
1. APPLICATION TOOLS - GS4MT,PPTMT,ST2MT,ST3MT,HTMT
 2. MINIMUM LOOP TENSILE STRENGTH - 200 LBS (890 NEWTONS) WHEN TESTED ON A 3" MANDREL. PART NO. MLT2.7WS-LP TESTED ON A 1 1/2" MANDREL.
 3. BRACKETS [] DENOTE DIMENSIONS IN MILLIMETERS, AND ARE SHOWN FOR REFERENCE ONLY
 4. TOLERANCES:
 .XXX = ±.010 [.25] .XX = ±.02 [.5]
 .X = ±.03 [.8] ANGLES = ±2°
 5. MATERIAL: 304 STAINLESS STEEL

FULLY ROUNDED EDGES ALONG STRAP BODY

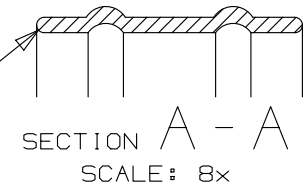

REV	DATE	BY	CHK	APR	DESCRIPTION	ECN
10A	3/13	JAMB	MIM	RGRO	UPDATE DRAWING TO NEW GLOBAL PANDUIT TITLE BLOCK WITH PANDUIT LOGO	SSECN01037
09A	1/13	JAMB	RGRO	---	ADDED PART NUMBER MLT4WS-TL TO DRAWING	-----
08A	2/12	MIM	RGRO	---	NOTE #3 METRIC DIMENSIONS NOTED AS BEING SHOWN FOR REFERENCE ONLY	-----

TITLE	
WAVE-TY STANDARD SERIES 304 STAINLESS STEEL CUSTOMER DRAWING	
ITEM REVISION NAME	N41124BS/10
DATASET FILE NAME	N41124BS_DC/10A
UNLESS OTHERWISE SPECIFIED, DIMENSIONAL TOLERANCES ARE: IN [mm] .x ± .1 [2.54] .xxx ± .005 [.127] .xx ± .01 [.25] ANGLES ± 5°	
THIRD ANGLE PROJECTION	
DRAWN BY	JAMB
DATE	02/12
CHK	DPN
SCALE	2:1
MATERIAL: 304 STAINLESS STEEL	
DRAWING NUMBER: N41124BS_DC	
SHT 1 OF 1	
SIZE A	