



Chipsmall Limited consists of a professional team with an average of over 10 year of expertise in the distribution of electronic components. Based in Hongkong, we have already established firm and mutual-benefit business relationships with customers from,Europe,America and south Asia,supplying obsolete and hard-to-find components to meet their specific needs.

With the principle of “Quality Parts,Customers Priority,Honest Operation,and Considerate Service”,our business mainly focus on the distribution of electronic components. Line cards we deal with include Microchip,ALPS,ROHM,Xilinx,Pulse,ON,Everlight and Freescale. Main products comprise IC,Modules,Potentiometer,IC Socket,Relay,Connector.Our parts cover such applications as commercial,industrial, and automotives areas.

We are looking forward to setting up business relationship with you and hope to provide you with the best service and solution. Let us make a better world for our industry!



Contact us

Tel: +86-755-8981 8866 Fax: +86-755-8427 6832

Email & Skype: info@chipsmall.com Web: www.chipsmall.com

Address: A1208, Overseas Decoration Building, #122 Zhenhua RD., Futian, Shenzhen, China



SPECIFICATION

Revised A: 8/Jan./'10 ER A: 17/Jun./'10 LH C: 28/Feb./'12 TK

1. MECHANICAL

>A >C

Manual measurement probe for MM5831-2700, cable plug

Calibration adapter for MM5829-2700 probe

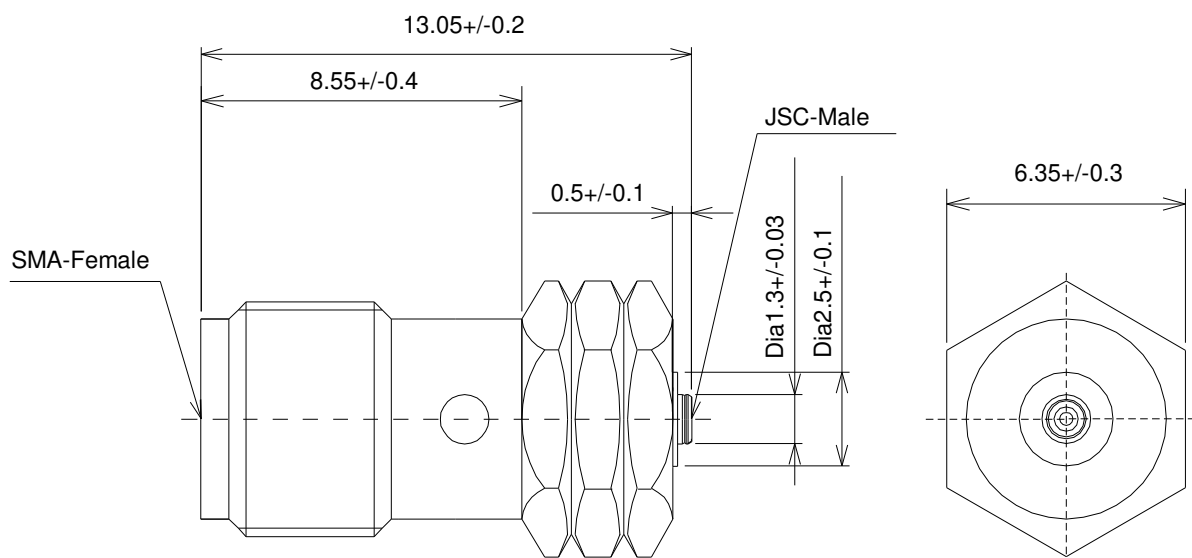

SCALE:FREE

UNIT: mm

2. RATING:

>B >C

Item	Specification
Voltage Rating	30V r.m.s. maximum
Nominal Frequency Range	DC to 12GHz
Nominal Impedance	50Ω
Temperature Rating	-40°C to +85°C
Insulation Resistance	500 MΩ minimum
Withstanding Voltage	AC 200V
Voltage Standing Wave Ratio (V.S.W.R.)	1.3 max. (DC to 3GHz) 1.4 max. (3GHz to 6GHz) 1.5 max. (6GHz to 9GHz) 1.6 max. (9GHz to 12GHz)
Durability	10K