



Chipsmall Limited consists of a professional team with an average of over 10 year of expertise in the distribution of electronic components. Based in Hongkong, we have already established firm and mutual-benefit business relationships with customers from,Europe,America and south Asia,supplying obsolete and hard-to-find components to meet their specific needs.

With the principle of “Quality Parts,Customers Priority,Honest Operation,and Considerate Service”,our business mainly focus on the distribution of electronic components. Line cards we deal with include Microchip,ALPS,ROHM,Xilinx,Pulse,ON,Everlight and Freescale. Main products comprise IC,Modules,Potentiometer,IC Socket,Relay,Connector.Our parts cover such applications as commercial,industrial, and automotives areas.

We are looking forward to setting up business relationship with you and hope to provide you with the best service and solution. Let us make a better world for our industry!



## Contact us

Tel: +86-755-8981 8866 Fax: +86-755-8427 6832

Email & Skype: info@chipsmall.com Web: www.chipsmall.com

Address: A1208, Overseas Decoration Building, #122 Zhenhua RD., Futian, Shenzhen, China



**MOM-32325-000**

**SHT 1.1**

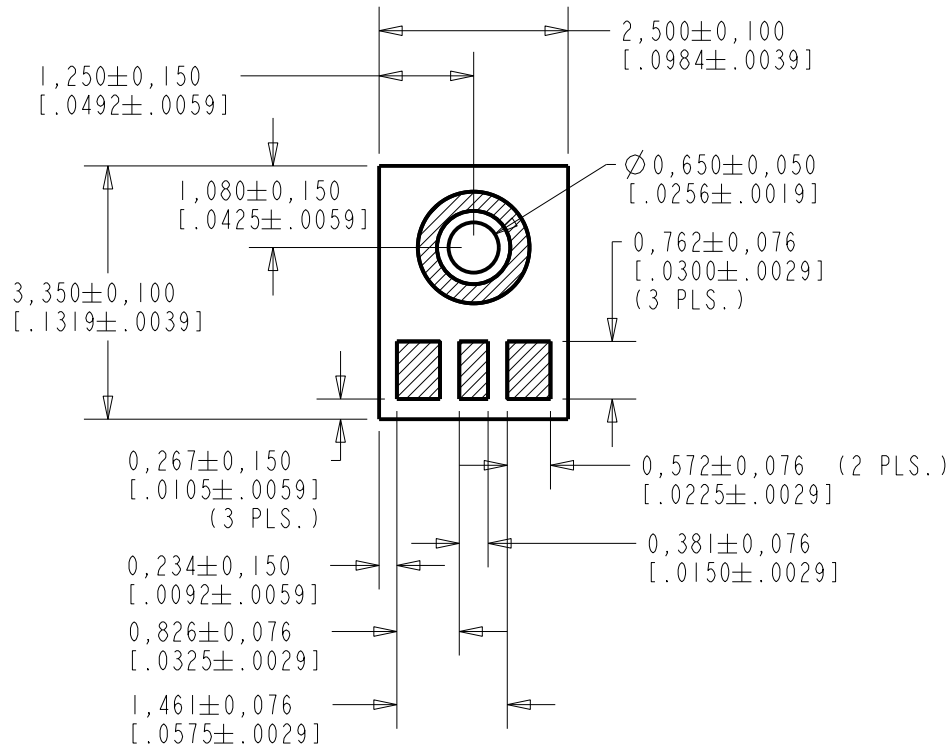

NOTES:

1. DO NOT PULL A VACUUM OR APPLY AIR PRESSURE OVER THE PORT HOLE OF THE MICROPHONE. PULLING A VACUUM OR APPLYING AIR PRESSURE OVER THE PORT HOLE CAN DAMAGE THE DEVICE.
2. DO NOT INSERT ANY OBJECT IN PORT HOLE OF DEVICE AT ANY TIME AS THIS CAN DAMAGE THE DEVICE.
3. RECOMMEND NO MORE THAN 3 REFLOW CYCLES.

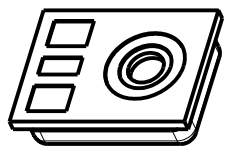

NOMINAL WEIGHT  
.020 GRAMS

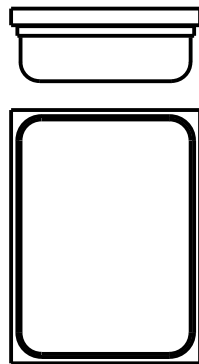

DIMENSIONS IN MILLIMETERS [INCHES]

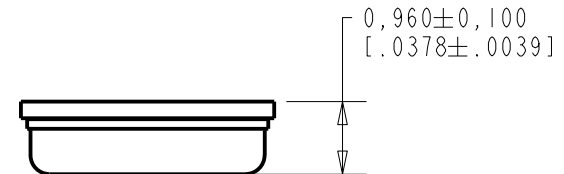

**KNOWLES ELECTRONICS**  
ITASCA, ILLINOIS U.S.A.

Revision	C.O. #	Implementation Date	RELEASE LEVEL	REVISION
A	MI0105812	11-17-14	<b>Active</b>	<b>A</b>
SCALE: 10:1			DR. BY: JL	DATE: 11-17-14
DO NOT SCALE DRAWING			CK. BY: GJP	DATE: 11-20-14
TITLE: MICROPHONE		MOM-32325-000	APP. BY: GJP	DATE: 11-20-14
OUTLINE DRAWING		SHT 1.1		

TYPICAL SENSITIVITY

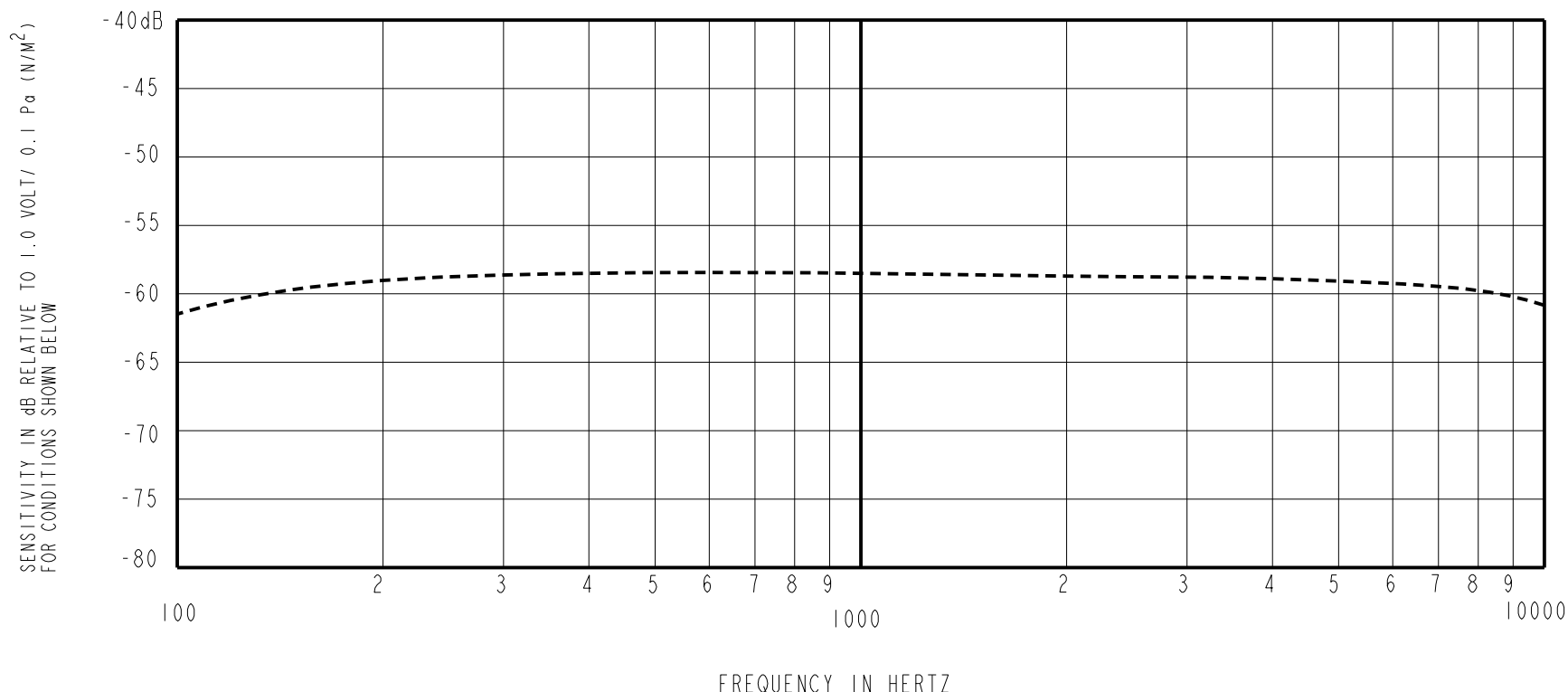

SENSITIVITY MEASURED IN A PRESSURE CAVITY UNDER THE NOMINAL CONDITIONS SHOWN BELOW

POWER REQUIREMENT					
PARAMETER	UNIT	MINIMUM	NOMINAL	MAXIMUM	REMARKS
SUPPLY VOLTAGE RANGE	VDC	0.9	0.9	1.3	OPERATING

PERFORMANCE						
PARAMETERS	UNIT	MINIMUM	NOMINAL	MAXIMUM	REMARKS	
SENSITIVITY	100 Hz	dB	-4.5	-2.5	-0.5	re SENSITIVITY AT 1 kHz
	1000 Hz	dB	-61.5	-58.5	-55.5	dB re 1V/0.1Pa
	10 kHz	dB	-5.0	-2.0	+1.0	re SENSITIVITY AT 1 kHz
CURRENT DRAIN	µA	-	28	39	-	
A-WEIGHTED NOISE	dB SPL	-	26.5	30	INPUT REFERRED NOISE re SENSITIVITY AT 1kHz	
OUTPUT IMPEDANCE	Ohms	3200	4450	5700	-	

- NOTES: 1. REFLOWED CUP CONNECTED TO NEGATIVE TERMINAL.  
 2. PERFORMANCE PARAMETERS ARE VALID AT 0.9 VDC. TYPICAL TEST ENVIRONMENT: 50% RH, 21°C (70°F)  
 3. SETTLE VL SPEC RANGES FROM 0.53 TO 0.67 AT 0.9 VDC BY DESIGN.

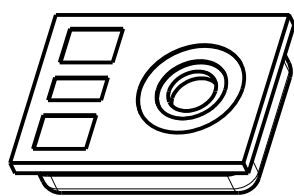

PORT LOCATION: 12JPn

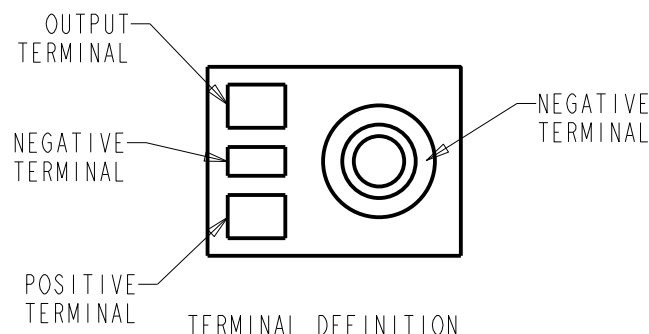

Revision	C.O. #	Implementation Date	RELEASE LEVEL	REVISION
A	MI0105812	11-17-14	Active	A

**KNOWLES ELECTRONICS**  
 ITASCA, ILLINOIS U.S.A.

WHEN TEST LIMITS ARE USED TO ESTABLISH INCOMING INSPECTION ACCEPTANCE/REJECTION CRITERIA, CORRELATION OF TEST EQUIPMENT WITH KNOWLES IS ALSO REQUIRED FOR ELIMINATION OF EQUIPMENT AND TEST METHOD VARIATION

TITLE: **MICROPHONE** **MM-32325-000**  
 PERFORMANCE SPECIFICATION **SHT 2.1**

DR. BY	DATE
JL	11-17-14
CK. BY	DATE
GJP	11-20-14
APP. BY	DATE
GJP	11-20-14

A) 1/3 OCTAVE INPUT REFERRED NOISE

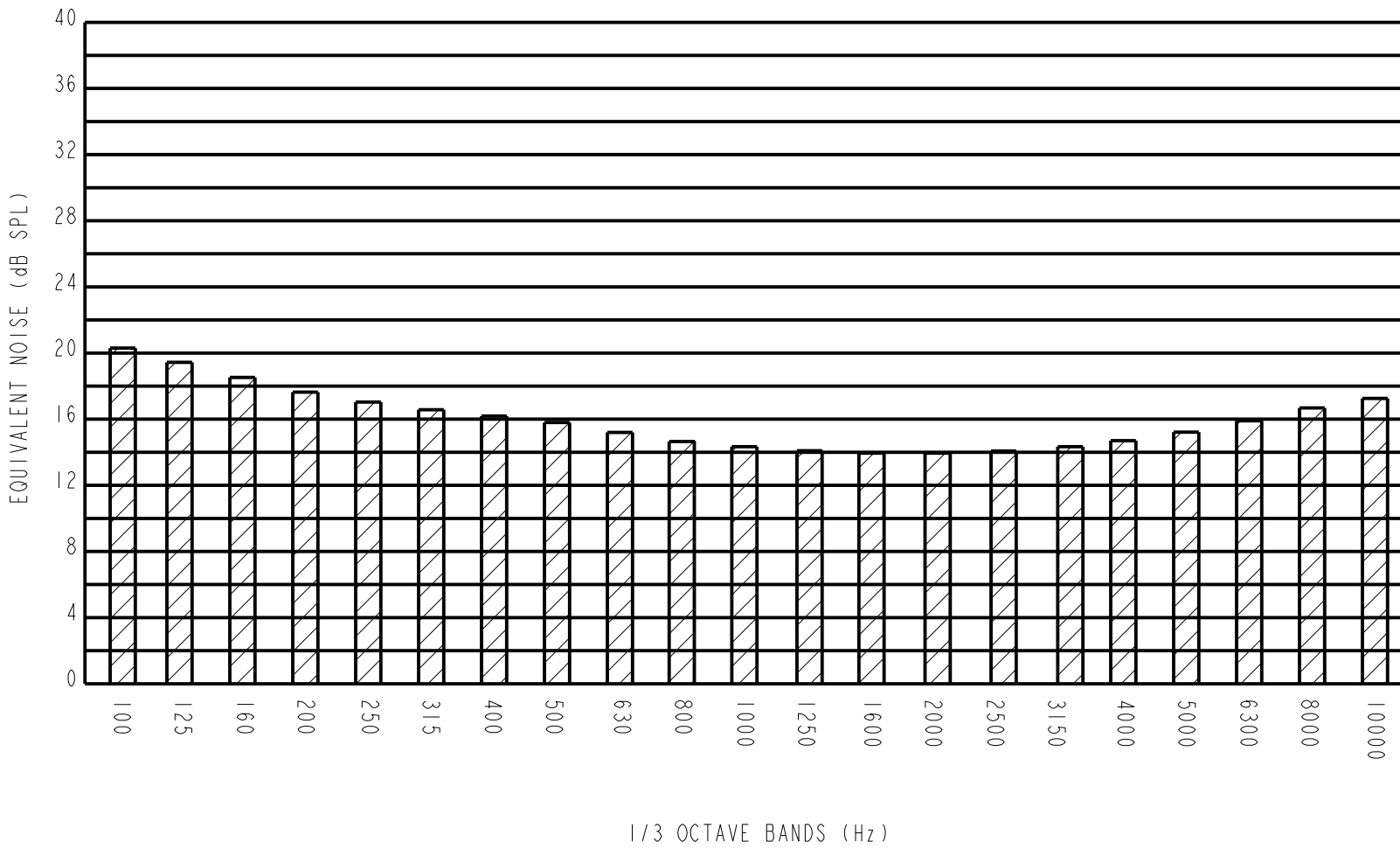

B) PERFORMANCE

PERFORMANCE						
PARAMETERS		UNIT	MINIMUM	TYPICAL	MAXIMUM	REMARKS
POWER SUPPLY REJECTION RATIO (PSRR)	1000 Hz	dB	-	-42	-18	SUPPLY VOLTAGE @ 0.9 VDC
				-	-	SUPPLY VOLTAGE @ 1.3 VDC
INPUT REFERRED VIBRATION SENSITIVITY	1000 Hz	dB SPL	-	54	60	BLOCKED PORT; 1g ACCELERATION
HUMIDITY COEFFICIENT	1000 Hz	dB		0.0		PER %RH
TEMPERATURE RANGE	OPERATION	°C (°F)	0 (32)	-	63 (145)	CELSIUS (FAHRENHEIT)
	STORAGE	°C (°F)	-40 (-40)	-	100 (212)	CELSIUS (FAHRENHEIT)
ESD TOLERANCE	MIL-STD-750 CLASS 2 RATING EOS/ESD-S5.1-1993 CLASS 2 RATING					

Revision	C.O. #	Implementation Date	RELEASE LEVEL	REVISION
A	MI0105812	11-17-14	<b>Active</b>	<b>A</b>

WHEN TEST LIMITS ARE USED TO ESTABLISH INCOMING INSPECTION ACCEPTANCE/REJECTION CRITERIA, CORRELATION OF TEST EQUIPMENT WITH KNOWLES IS ALSO REQUIRED FOR ELIMINATION OF EQUIPMENT AND TEST METHOD VARIATION		DR. BY	DATE
TITLE: <b>MICROPHONE</b> PERFORMANCE SPECIFICATION		JL	11-17-14
		GJP	11-20-14
TITLE: <b>MM-32325-000</b> SHT 2.2		APP. BY	DATE
		GJP	11-20-14

**KNOWLES ELECTRONICS**  
ITASCA, ILLINOIS U.S.A.