



Chipsmall Limited consists of a professional team with an average of over 10 year of expertise in the distribution of electronic components. Based in Hongkong, we have already established firm and mutual-benefit business relationships with customers from,Europe,America and south Asia,supplying obsolete and hard-to-find components to meet their specific needs.

With the principle of “Quality Parts,Customers Priority,Honest Operation,and Considerate Service”,our business mainly focus on the distribution of electronic components. Line cards we deal with include Microchip,ALPS,ROHM,Xilinx,Pulse,ON,Everlight and Freescale. Main products comprise IC,Modules,Potentiometer,IC Socket,Relay,Connector.Our parts cover such applications as commercial,industrial, and automotives areas.

We are looking forward to setting up business relationship with you and hope to provide you with the best service and solution. Let us make a better world for our industry!



## Contact us

Tel: +86-755-8981 8866 Fax: +86-755-8427 6832

Email & Skype: info@chipsmall.com Web: www.chipsmall.com

Address: A1208, Overseas Decoration Building, #122 Zhenhua RD., Futian, Shenzhen, China



4

3

2

1

D

D

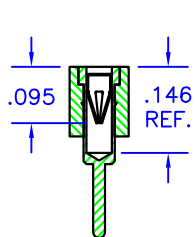
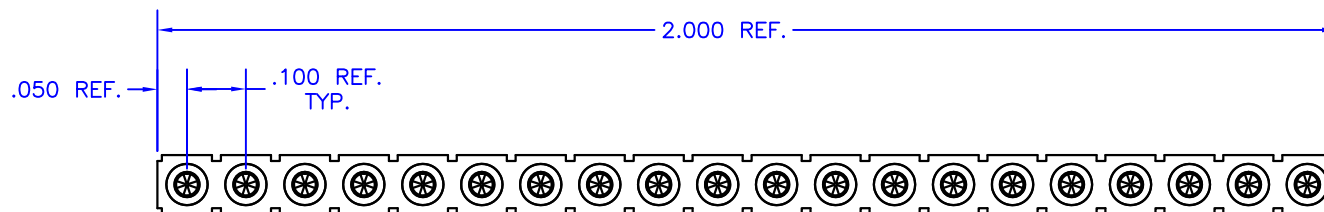

Sec. A-A

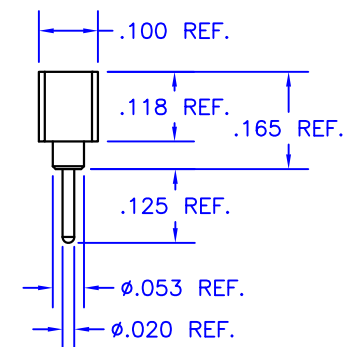
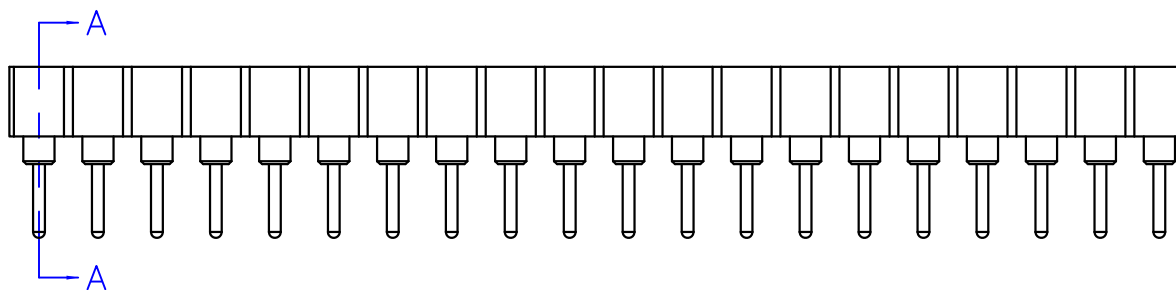

C

C

B

B

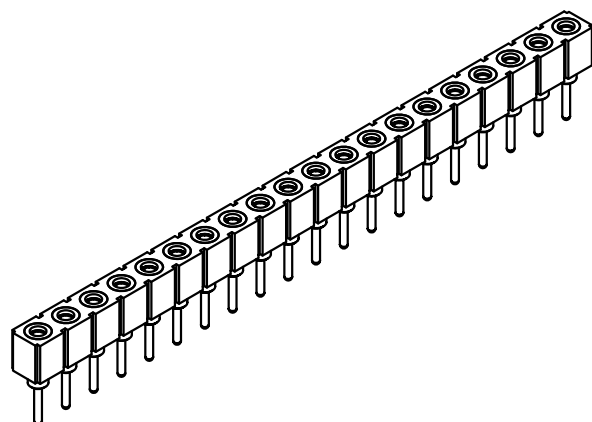

A

A

**NOTES:**

1. Unless otherwise noted, dimensions are in inches.
2. Shell: 360 brass, half-hard, with 200  $\mu$ m tin/lead over nickel
3. Contacts: Beryllium copper with 30  $\mu$ m gold over nickel
4. Body: Glass-filled black polyester, rated UL94V-0
5. Current rating: 3 amps, for 10°C temperature rise.
6. Solder mount in .028-.035 diameter hole.
7. Cut to length to suit application.
8. Mill-Max Part No. 310-93-120-41-001000

TOLERANCES - UNLESS  
OTHERWISE SPECIFIED

.XX =  $\pm.05$  [.002]  
.XXX =  $\pm.005$  [.0002]  
ANG. =  $\pm 2^\circ$



TITLE:

**MATING SOCKET**  
FOR .015-.025 DIAMETER PINS

MODEL:

**MS06**

SUBJECT:

**MECHANICAL DRAWING**ENGINEER:  
**D-M**DRAWN BY:  
**R.MOR**DCAL: **13242**

SHL 1 OF 1

FILENAME: **MS06**REV: **D**DATE: **03JUN13**

4

3

2

1