



Chipsmall Limited consists of a professional team with an average of over 10 year of expertise in the distribution of electronic components. Based in Hongkong, we have already established firm and mutual-benefit business relationships with customers from,Europe,America and south Asia,supplying obsolete and hard-to-find components to meet their specific needs.

With the principle of “Quality Parts,Customers Priority,Honest Operation,and Considerate Service”,our business mainly focus on the distribution of electronic components. Line cards we deal with include Microchip,ALPS,ROHM,Xilinx,Pulse,ON,Everlight and Freescale. Main products comprise IC,Modules,Potentiometer,IC Socket,Relay,Connector.Our parts cover such applications as commercial,industrial, and automotives areas.

We are looking forward to setting up business relationship with you and hope to provide you with the best service and solution. Let us make a better world for our industry!



## Contact us

Tel: +86-755-8981 8866 Fax: +86-755-8427 6832

Email & Skype: [info@chipsmall.com](mailto:info@chipsmall.com) Web: [www.chipsmall.com](http://www.chipsmall.com)

Address: A1208, Overseas Decoration Building, #122 Zhenhua RD., Futian, Shenzhen, China



2

1

THIS COPY IS PROVIDED ON A RESTRICTED BASIS AND IS NOT TO BE USED IN ANY WAY DETRIMENTAL TO THE INTERESTS OF PANDUIT CORP.

PANDUIT P/N	WEIGHT
MS14HD	5.0 LB/EACH PC (2268.0 g/10 PCS)

## NOTES:

1. SEE CURRENT CATALOG FOR ADDITIONAL PART NUMBER SUFFIXES TO INDICATE COLOR AND OR PACKAGE QUANTITY.
2. SEE CATALOG FOR COMPLETE LIST OF PARTS APPLICABLE FOR USE WITH THIS PART.
3. DIMENSIONS IN [ ] ARE IN METRIC.
4. PART INCLUDES:
  - 1- DOOR ASSEMBLY
  - 2- KEY
  - 4- DOOR MOUNTING SCREW
  - 1- DOCUMENTATION SLEEVE

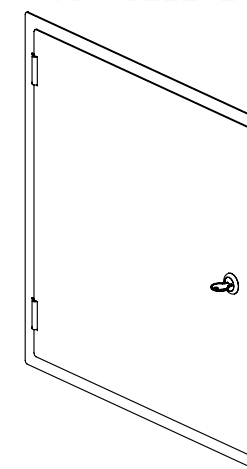
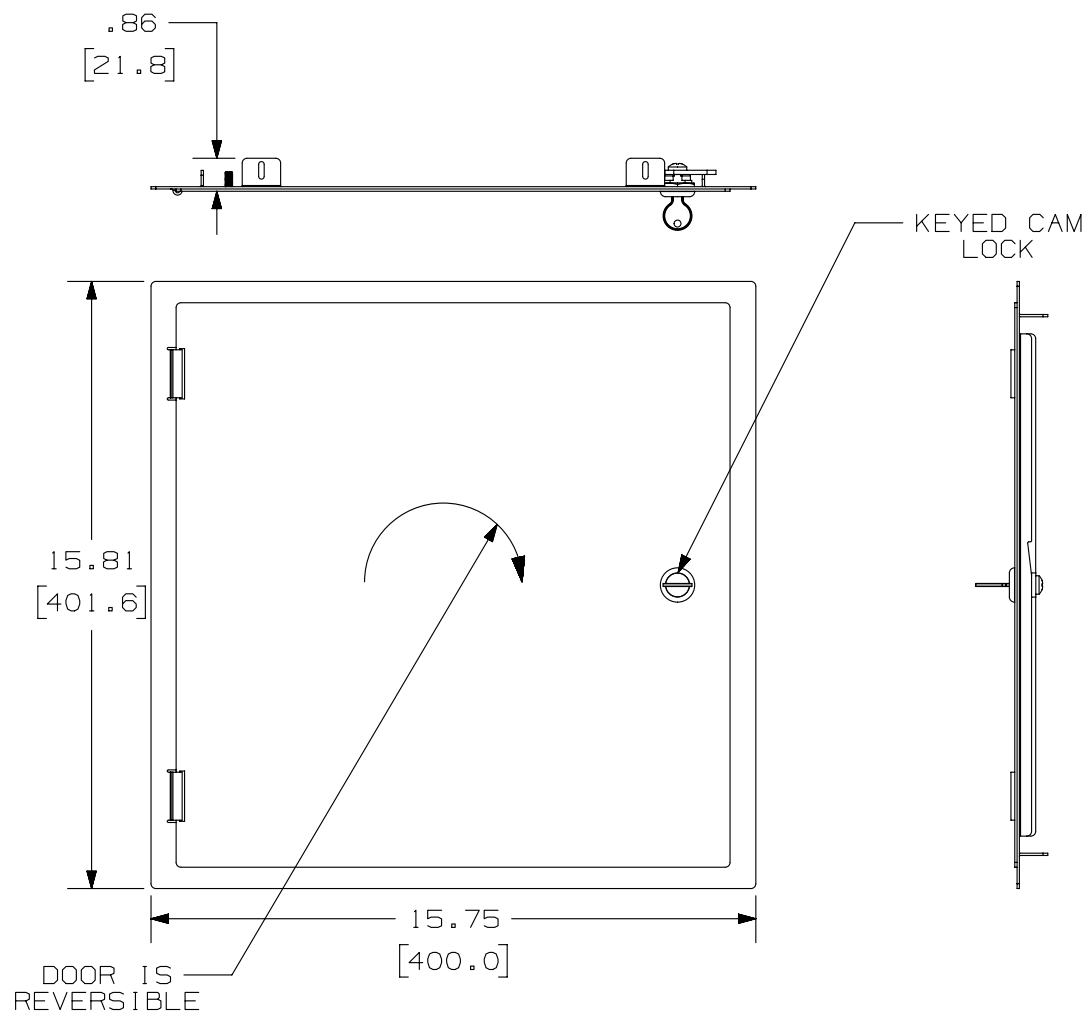

PART NUMBER		MS14HD	
TITLE		MEDIA DISTRIBUTION 14" HINGED DOOR	
ITEM REVISION NAME		CUSTOMER DRAWING	
DATASET FILE NAME		M02695AC-DC97/03A	
UNLESS OTHERWISE SPECIFIED, DIMENSIONAL TOLERANCES ARE: IN [ mm ]		MATERIAL:  16 GAGE C.R.S.	
DRAWING NUMBER: 02695-97		DRAWN BY JSP	
DATE 3-29-07		CHK REFR	
SCALE NONE		SIZE A	

REV	DATE	BY	CHK	APR	DESCRIPTION	ECN
1	4-24-14	MDJR	REFR	MMR	A. UPDATED TITLE BLOCK.	02695-97
R	11-19-07	JSP	REFR	REFR	RELEASED TO PRODUCTION	02695-97

2

1