



Chipsmall Limited consists of a professional team with an average of over 10 year of expertise in the distribution of electronic components. Based in Hongkong, we have already established firm and mutual-benefit business relationships with customers from,Europe,America and south Asia,supplying obsolete and hard-to-find components to meet their specific needs.

With the principle of “Quality Parts,Customers Priority,Honest Operation,and Considerate Service”,our business mainly focus on the distribution of electronic components. Line cards we deal with include Microchip,ALPS,ROHM,Xilinx,Pulse,ON,Everlight and Freescale. Main products comprise IC,Modules,Potentiometer,IC Socket,Relay,Connector.Our parts cover such applications as commercial,industrial, and automotives areas.

We are looking forward to setting up business relationship with you and hope to provide you with the best service and solution. Let us make a better world for our industry!



## Contact us

Tel: +86-755-8981 8866 Fax: +86-755-8427 6832

Email & Skype: info@chipsmall.com Web: www.chipsmall.com

Address: A1208, Overseas Decoration Building, #122 Zhenhua RD., Futian, Shenzhen, China



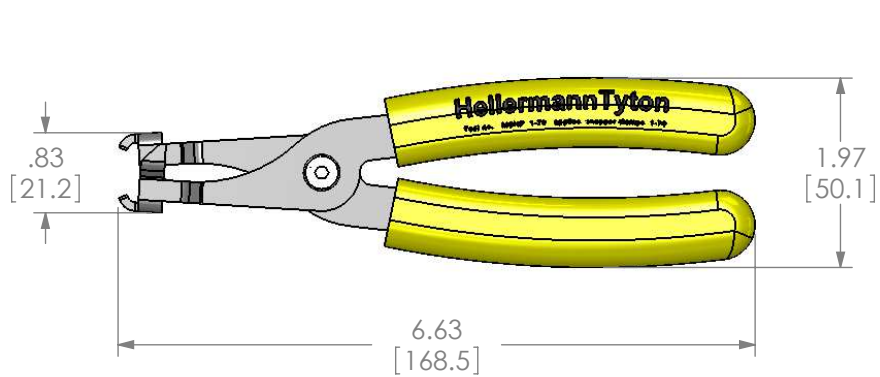
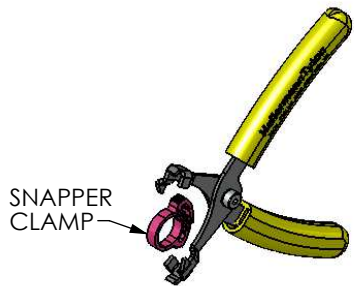

JAWS CLOSED

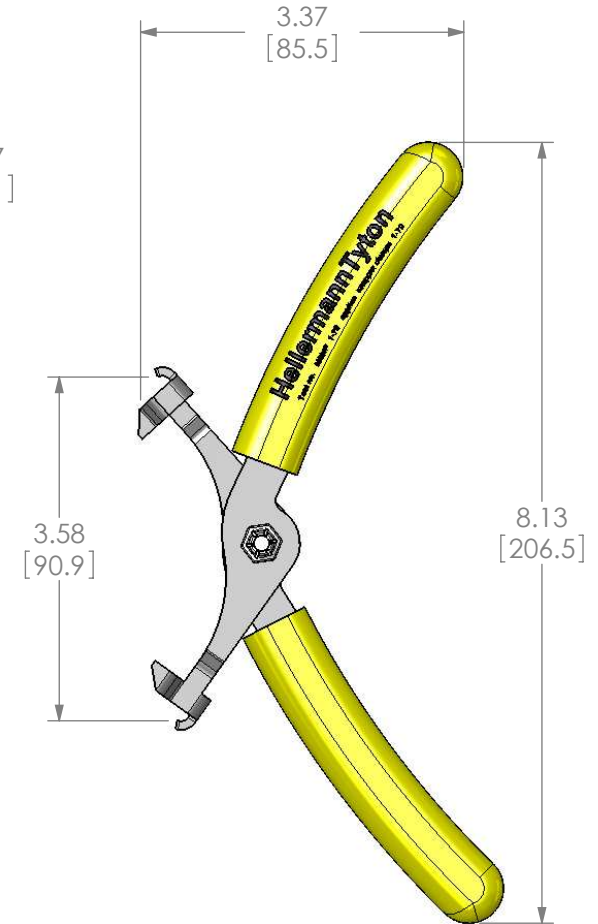
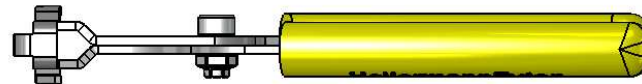
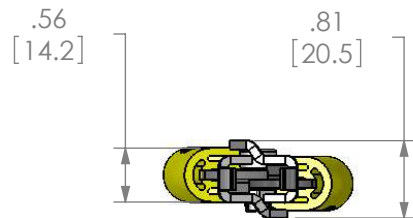

JAWS OPENED MAXIMUM

NOTES:

- 1) TOOL IS USED TO CLOSE SNP1 THRU SNP 70 SERIES HELLERMANNTYTON SNAPPER CLAMPS.
- 2.0) TOOL OPERATION:
- 2.1) FINGER TIGHTEN SNAPPER TO A HOSE TYPE APPLICATION.
- 2.2) APPLY JAWS OF TOOL TO HEAD OF SNAPPER AND SQUEEZE HANDLES UNTIL 2-3 ADDITIONAL TEETH (CLICKS) ARE MADE.
- 3) SEE SHEET 2 TO DISASSEMBLE A SNAPPER.

INVENTORS

# HellermannTyton

ALL PROPRIETARY RIGHTS IN THE SUBJECT MATTER SHOWN ON THIS DRAWING ARE EXCLUSIVE PROPERTY OF HELLERMANNTYTON

|      |      |             |
|------|------|-------------|
| name | date | city, state |
|      |      |             |
|      |      |             |
|      |      |             |

REVISION

|            |            |
|------------|------------|
| D level    | <b>01</b>  |
| drawn by   | WKL        |
| date       | 11/10/2009 |
| ECN #      | 011431     |
| part level | -          |

DIMENSIONS

|                 |                            |
|-----------------|----------------------------|
| FOOTER DECIMALS | .xxxx = ±.0005             |
|                 | .xxx = ±.005               |
|                 | .xx = ±.01                 |
|                 | .x = ±.03                  |
|                 | ∠ = ±0.5°                  |
|                 | unless otherwise specified |
| units           | inches                     |

PART

|          |                           |       |            |
|----------|---------------------------|-------|------------|
| number   | MSNP1-70                  | phase | Production |
| name     | CUSTOMER DRAWING MSNP1-70 |       |            |
| material |                           |       |            |

DRAWING

|                    |                     |         |                         |          |     |
|--------------------|---------------------|---------|-------------------------|----------|-----|
| format version N   | AH                  | CAD     | SW 2010                 | scale    | 1:2 |
| computer file name | TS2021004CST_01     |         | previous drawing number |          |     |
| drawn              | WKL                 | checked | WKL                     | approved |     |
| date               | 11/21/1989          | checked | 11/10/2009              | approved |     |
| type               | Customer            |         | sheet 1 of 2            |          |     |
| number             | <b>TS2021004CST</b> |         |                         |          |     |

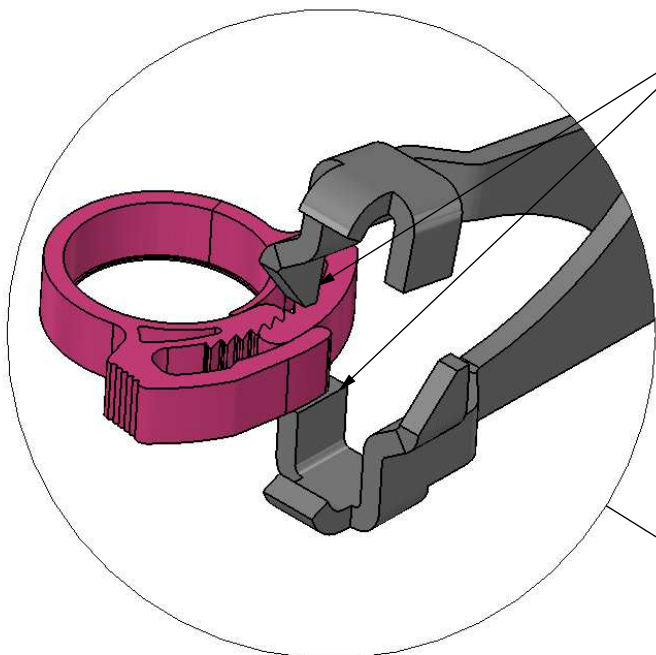

DETAIL A  
SCALE 3 : 2

- TO DISASSEMBLE A SNAPPER:
- 1) ALIGN THE FINGERS OF THE JAW AS SHOWN.
  - 2) SQUEEZE THE YELLOW HANDLES UNTIL THE ARMS OF THE SNAPPER SEPERATE AND ARE FREE AND OPEN.

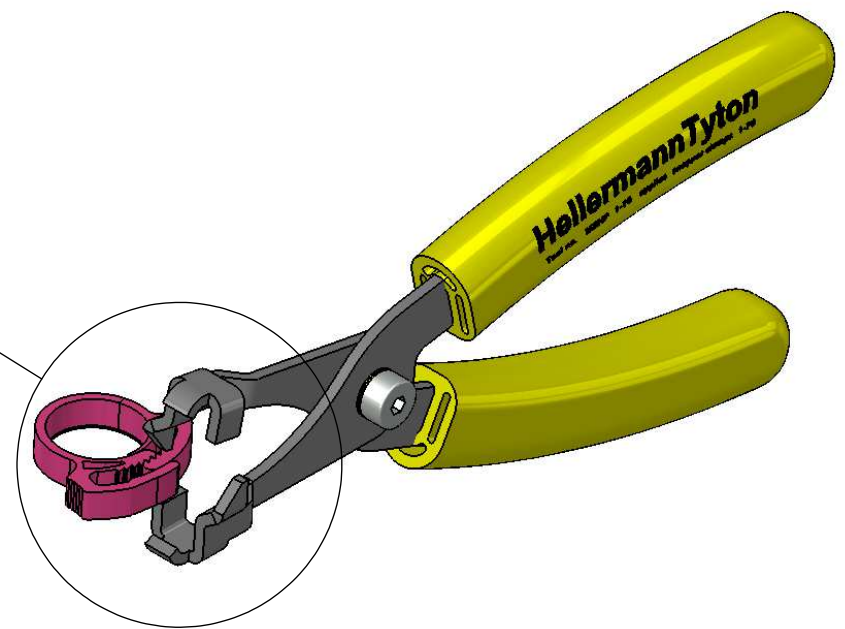

INVENTORS

# HellermannTyton

ALL PROPRIETARY RIGHTS IN THE SUBJECT MATTER SHOWN ON THIS DRAWING ARE EXCLUSIVE PROPERTY OF HELLERMANN TYTON

|      |      |             |
|------|------|-------------|
| name | date | city, state |
|      |      |             |
|      |      |             |
|      |      |             |

**REVISION**

|            |            |
|------------|------------|
| DRAWN by   | WKL        |
| DATE       | 11/10/2009 |
| ECN #      | 011431     |
| part level | -          |

**DIMENSIONS**

FOOTPRINTS

.xxxx = ±.0005  
 .xxx = ±.005  
 .xx = ±.01  
 .x = ±.03  
 < = ±0.5°

unless otherwise specified

units inches

**PART**

|          |                           |       |            |
|----------|---------------------------|-------|------------|
| number   | MSNP1-70                  | phase | Production |
| name     | CUSTOMER DRAWING MSNP1-70 |       |            |
| material |                           |       |            |

**DRAWING**

|                    |                 |         |                         |          |     |
|--------------------|-----------------|---------|-------------------------|----------|-----|
| format version N   | AH              | CAD     | SW 2010                 | scale    | 3:4 |
| computer file name | TS2021004CST_01 |         | previous drawing number |          |     |
| drawn              | WKL             | checked | WKL                     | approved |     |
|                    | 11/21/1989      |         | 11/10/2009              |          |     |
| type               | Customer        |         | sheet 2 of 2            |          |     |
| number             | TS2021004CST    |         |                         |          |     |