



Chipsmall Limited consists of a professional team with an average of over 10 year of expertise in the distribution of electronic components. Based in Hongkong, we have already established firm and mutual-benefit business relationships with customers from,Europe,America and south Asia,supplying obsolete and hard-to-find components to meet their specific needs.

With the principle of “Quality Parts,Customers Priority,Honest Operation,and Considerate Service”,our business mainly focus on the distribution of electronic components. Line cards we deal with include Microchip,ALPS,ROHM,Xilinx,Pulse,ON,Everlight and Freescale. Main products comprise IC,Modules,Potentiometer,IC Socket,Relay,Connector.Our parts cover such applications as commercial,industrial, and automotives areas.

We are looking forward to setting up business relationship with you and hope to provide you with the best service and solution. Let us make a better world for our industry!



Contact us

Tel: +86-755-8981 8866 Fax: +86-755-8427 6832

Email & Skype: info@chipsmall.com Web: www.chipsmall.com

Address: A1208, Overseas Decoration Building, #122 Zhenhua RD., Futian, Shenzhen, China



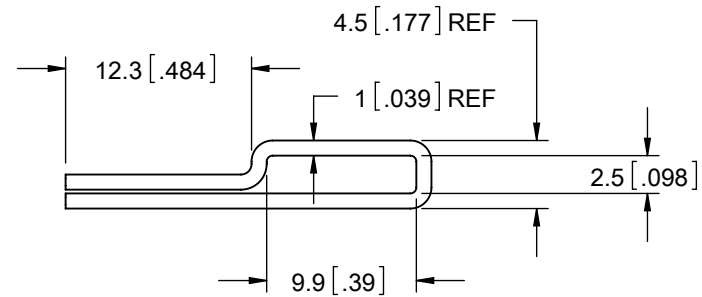
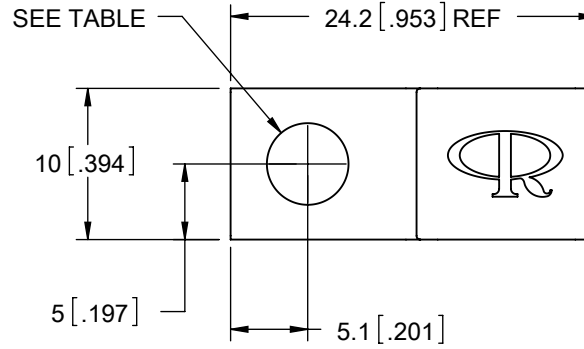
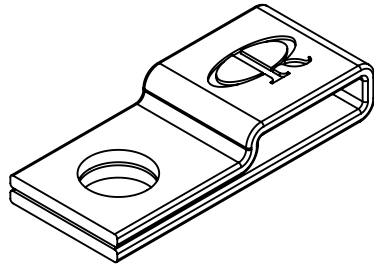

BROKEN EDGE
TO ELIMINATE
SHARPNESS

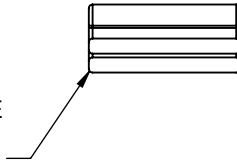

NOTES:
1. MATERIAL: 304 STAINLESS STEEL (RMS-381)
2. ALERNATE UNITS FOR REFERENCE ONLY.

PART NUMBER	HOLE Ø ±.25[.010]	SUGGESTED SCREW SIZE
MTH1-1	4.5[.177]	M4 OR #8
MTH1-2	5.4[.213]	M5 OR #10
MTH1-3	6.75[.266]	M6 OR 1/4

TITLE: METAL TIE HOLDER				UNITS: mm[IN]	
CREATED USING SOLIDWORKS	FILE #: MTH1	DWN: R.D.G.	APP: R.D.G.	FINAL	
GENERAL TOLERANCE UNLESS NOTED ±.5	SHEET: 1 OF 1	SHEET SIZE: A	DT: 06/11/09	CHKD: D.Z.	PART #
	RE: RICHCO, INC. --	RICHCO, INC. ENG@RICHCO-INC.COM (773) 539-4060		SEE TABLE	PRINT TYPE CA

B	WIDTH FROM 10.2 TO 10 & THCKNESS .9 TO 1, CO #1372	DZ	09/28/2012
A	RELEASED FOR PRODUCTION	SK	09/14/2009
REV.	DESCRIPTION	ENGR.	DATE