



Chipsmall Limited consists of a professional team with an average of over 10 year of expertise in the distribution of electronic components. Based in Hongkong, we have already established firm and mutual-benefit business relationships with customers from,Europe,America and south Asia,supplying obsolete and hard-to-find components to meet their specific needs.

With the principle of “Quality Parts,Customers Priority,Honest Operation,and Considerate Service”,our business mainly focus on the distribution of electronic components. Line cards we deal with include Microchip,ALPS,ROHM,Xilinx,Pulse,ON,Everlight and Freescale. Main products comprise IC,Modules,Potentiometer,IC Socket,Relay,Connector.Our parts cover such applications as commercial,industrial, and automotives areas.

We are looking forward to setting up business relationship with you and hope to provide you with the best service and solution. Let us make a better world for our industry!



Contact us

Tel: +86-755-8981 8866 Fax: +86-755-8427 6832

Email & Skype: info@chipsmall.com Web: www.chipsmall.com

Address: A1208, Overseas Decoration Building, #122 Zhenhua RD., Futian, Shenzhen, China



THIS COPY IS PROVIDED ON A RESTRICTED BASIS AND IS NOT TO BE USED IN ANY WAY DETRIMENTAL TO THE INTERESTS OF PANDUIT CORP.

PANDUIT PART NUMBER*	NO. OF BUNDLES	'A'	REC. FAST.	'B'	'C' ±.062	'D' ±.015	'E'	'F' REF	'G'	'H'	USE WITH CABLE TIE	WEIGHT lbs (g) / 100 pcs.
MTPC1H-E10	1	0.205	#10 SCR.	0.305	2.094	0.625	0.203	1.50	.320	.103	M, I, S, H	0.72 [324]
MTPC2H-E10	2				3.594			3.00				1.20 [543]
MTPC3H-E10	3				5.094			4.50				1.69 [766]
MTPC4H-E10	4				6.594			6.00				2.4 [1089]
MTPC5H-E10	5				8.094			7.50				2.9 [1315]
MTPC6H-E10	6				9.594			9.00				3.4 [1542]
MTPC7H-E10	7				11.094			10.50				3.7 [1672]

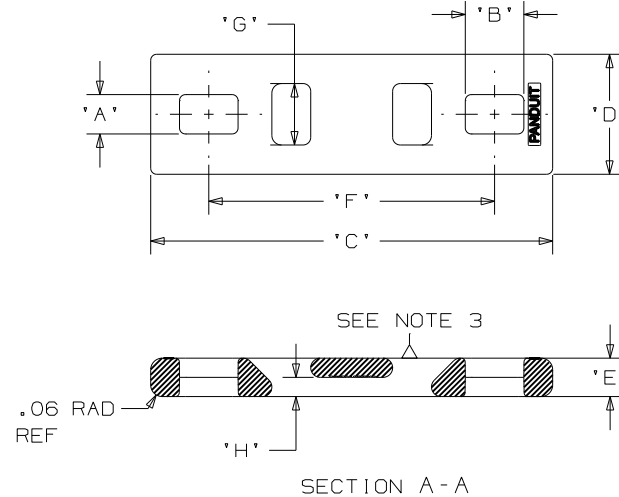

NOTES:

- SEE CURRENT PRICE SHEET FOR PART NUMBER SUFFIX DESIGNATION FOR PACKAGE SIZE.
- MATERIAL:**
-39: NATURAL HEAT STABILIZED NYLON 6/6
- KNOCKOUT PIN WITNESS SHALL BE FLUSH TO -.002
- ENGRAVING PLACED ON THE TOP SURFACE ('PANDUIT', AS SHOWN) SHALL BE LOCATED ON THE ENDS OF THE PART RECESSED BELOW SURFACE.

DIMENSIONS IN BRACKETS ARE METRIC [mm]	
CAD FILENAME/LAYERS G00239MY_DC_GB0239MY/OOB	
MTP CONTOUR SERIES MULTIPLE TIE PLATE	
UNLESS OTHERWISE SPECIFIED, DIMENSIONAL TOLERANCES ARE: (.X) ±0.05 [1.3] (.XXX) ±0.010 [0.25] (.XX) ±0.02 [0.5] ANGLES ± 5°	UNLESS OTHERWISE SPECIFIED, ALL DIMENSIONS ARE GIVEN IN INCHES, THIRD ANGLE PROJECTION.
DRAWN BY DJSM	MAT'L: NONE
DATE 4/10/07	SEE NOTE 2
CHK'D	DWG SIZE A
DRAWING NO. GB0239MY	

REV	DATE	BY	CHK	DESCRIPTION	ECN	R	CUST	SUP
OOB	7/8/08	ARHA		ADDED MTPC7H-E10, REMOVED -30 MATERIAL, REV'D TO TEAMCENTER NAME AND REV HISTORY	GB0239MY	OOB		
R	4/10/07	DJSM		INITIAL RELEASE - REPLACES GB0239MS	GB0239MY	R		