



Chipsmall Limited consists of a professional team with an average of over 10 year of expertise in the distribution of electronic components. Based in Hongkong, we have already established firm and mutual-benefit business relationships with customers from,Europe,America and south Asia,supplying obsolete and hard-to-find components to meet their specific needs.

With the principle of “Quality Parts,Customers Priority,Honest Operation,and Considerate Service”,our business mainly focus on the distribution of electronic components. Line cards we deal with include Microchip,ALPS,ROHM,Xilinx,Pulse,ON,Everlight and Freescale. Main products comprise IC,Modules,Potentiometer,IC Socket,Relay,Connector.Our parts cover such applications as commercial,industrial, and automotives areas.

We are looking forward to setting up business relationship with you and hope to provide you with the best service and solution. Let us make a better world for our industry!



Contact us

Tel: +86-755-8981 8866 Fax: +86-755-8427 6832

Email & Skype: info@chipsmall.com Web: www.chipsmall.com

Address: A1208, Overseas Decoration Building, #122 Zhenhua RD., Futian, Shenzhen, China



N-68X

Electrical Specifications (@25°C)

1. Maximum Power: 50 VA
2. Input Voltage:
Parallel: 115V@50/60Hz
Series: 230V@50/60Hz
3. Output Voltage: 115V ± 5%
4. Full Secondary Load: 0.435 Amps RMS
5. Voltage Regulation: 15 % TYP @ full load to no load

Description:

The N-68X is power transformer for isolating equipment from direct connection to the power line. It is constructed with nonconcentrically wound coils. The primary and secondary are wound on separate arbors, then assembled on a laminate core side-by-side separated by insulation. This prevents electrical connection under normal or overload conditions between the primary and secondary windings.

Safety:

These units are designed with 1500V isolation between winding to winding and between winding and core. Materials and construction are rated for Class B insulation system.

A. Dimensions: Unit: In inches

A	B	C	D
3.813	3.125	2.250	2.313

Weight: 1.7 Lbs.

Mounting Holes: .187 Dia. X 2

Connections: 7.0±1" leads, 0.250±0.062" Skin & Tin

Schematic:

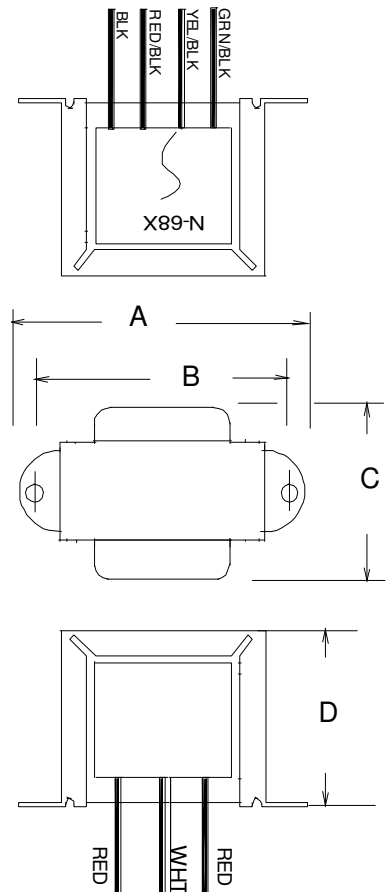
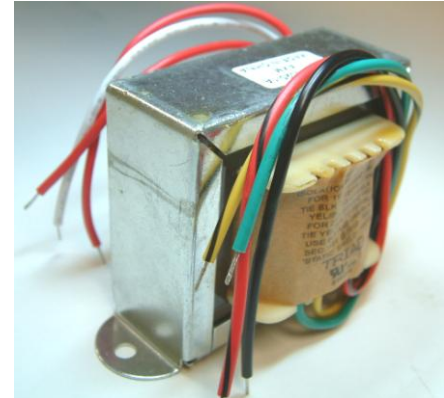
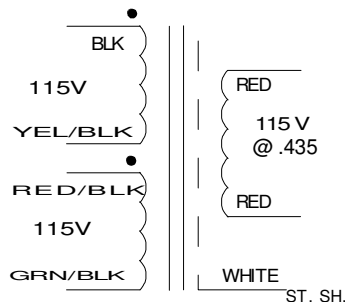

RoHS Compliance: As of manufacturing date February 2005, all standard products meet the requirements of 2011/65/EU, known as the RoHS initiative.

* Upon printing, this document is considered "uncontrolled". Please contact Triad Magnetics' website for the most current version.