



Chipsmall Limited consists of a professional team with an average of over 10 year of expertise in the distribution of electronic components. Based in Hongkong, we have already established firm and mutual-benefit business relationships with customers from,Europe,America and south Asia,supplying obsolete and hard-to-find components to meet their specific needs.

With the principle of “Quality Parts,Customers Priority,Honest Operation,and Considerate Service”,our business mainly focus on the distribution of electronic components. Line cards we deal with include Microchip,ALPS,ROHM,Xilinx,Pulse,ON,Everlight and Freescale. Main products comprise IC,Modules,Potentiometer,IC Socket,Relay,Connector.Our parts cover such applications as commercial,industrial, and automotives areas.

We are looking forward to setting up business relationship with you and hope to provide you with the best service and solution. Let us make a better world for our industry!



Contact us

Tel: +86-755-8981 8866 Fax: +86-755-8427 6832

Email & Skype: info@chipsmall.com Web: www.chipsmall.com

Address: A1208, Overseas Decoration Building, #122 Zhenhua RD., Futian, Shenzhen, China



Copying of this document and giving it to others and the use or communication of the contents thereof, are forbidden without express authority. Offenders are liable to the payment of damages. All rights are reserved in the event of the grant of a patent or the registration of the utility model or design.

Weitergabe sowie Vervielfältigung dieser Unterlage, Verwertung und Mitteilung ihres Inhalts nicht gestattet, soweit nicht ausdrücklich zugestanden. Zuwiderhandlungen verpflichten zu Schadenersatz. Alle Rechte für den Fall der Patenterteilung oder Gebrauchsmuster-Eintragung vorbehalten.

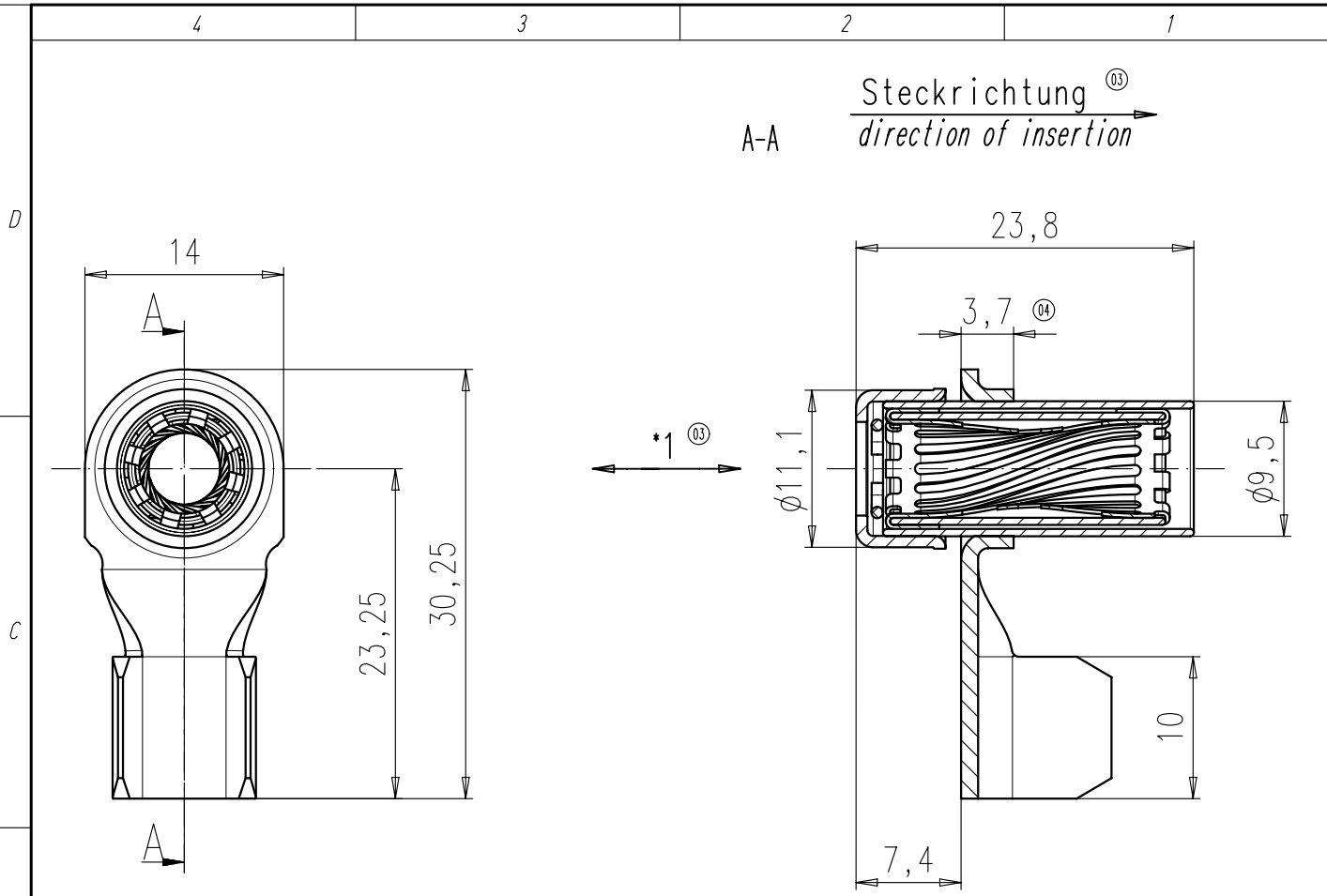

*1 Die Kräfteinleitung beim Stecken und Ziehen⁰³ muss entlang der Achse der Kontaktbuchse erfolgen
the initiation of the insertion and withdrawal force has to be along the axis of the contact socket

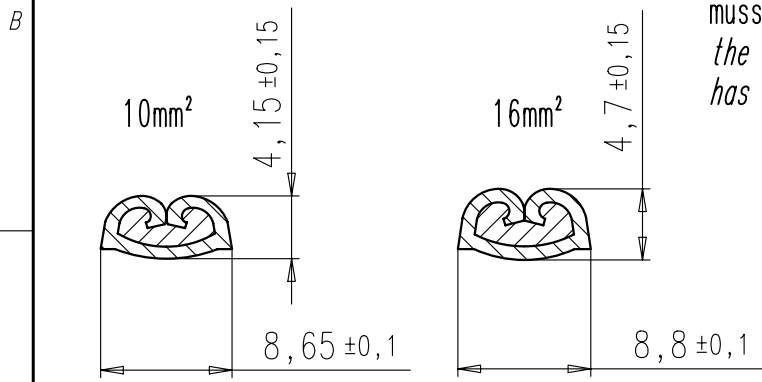

Crimp-Verarbeitungsspezifikation:
specification for crimping process
 N 50 380 0005 (10mm²)
 N 50 380 0004 (16mm²)

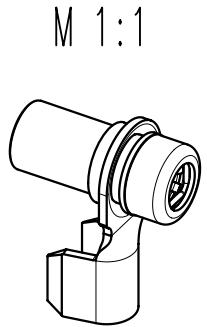

Masse (errechnet)/Calc WT: - 9		Zul. Abw./Tolerances:		Maßstab/Scale 2:1		A4				
Prüfmaß/Testdimension				DIN/ISO 13715		CUSTOMER DRAWING				
Teileindex Part index number				07 Datum/Date Name		Kontaktverrastung Größe 6 clickfit size 6				
				Gez. 06.12. Herrmann						
				Gepr. Checked						
04 201000321 21.05.10 Tol.		03 200900521 06.10.09 Hoe.		02 200800004 19.01.09 Tol.		01 200800287 06.12.07 AH		Amphenol-Tuchel Electronics GmbH		Blatt/Sheet 1
Index Änderung/Description Datum/Date Name						M N 02 060 6164 002		1 Bl.		
						Ers. f./Replacement for:				