



Chipsmall Limited consists of a professional team with an average of over 10 year of expertise in the distribution of electronic components. Based in Hongkong, we have already established firm and mutual-benefit business relationships with customers from,Europe,America and south Asia,supplying obsolete and hard-to-find components to meet their specific needs.

With the principle of “Quality Parts,Customers Priority,Honest Operation,and Considerate Service”,our business mainly focus on the distribution of electronic components. Line cards we deal with include Microchip,ALPS,ROHM,Xilinx,Pulse,ON,Everlight and Freescale. Main products comprise IC,Modules,Potentiometer,IC Socket,Relay,Connector.Our parts cover such applications as commercial,industrial, and automotives areas.

We are looking forward to setting up business relationship with you and hope to provide you with the best service and solution. Let us make a better world for our industry!



## Contact us

Tel: +86-755-8981 8866 Fax: +86-755-8427 6832

Email & Skype: info@chipsmall.com Web: www.chipsmall.com

Address: A1208, Overseas Decoration Building, #122 Zhenhua RD., Futian, Shenzhen, China



PRODUCT NUMBER	PITCH
NAxxB0x000J0G	2.50 mm

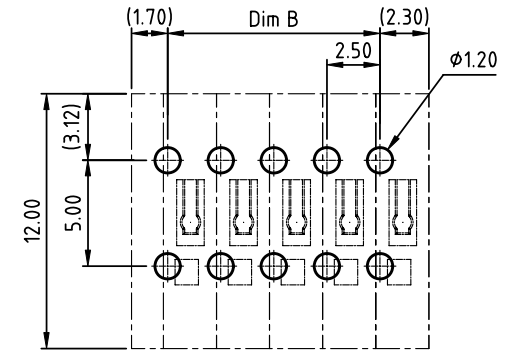
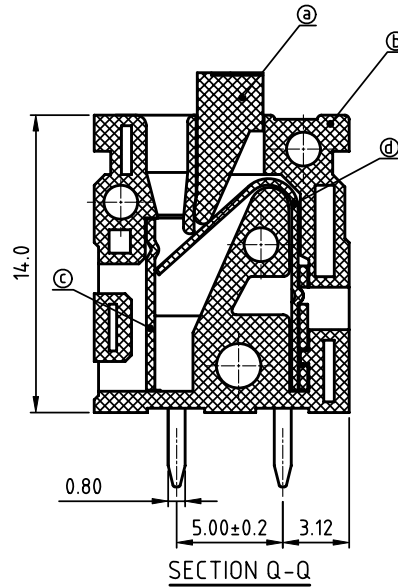
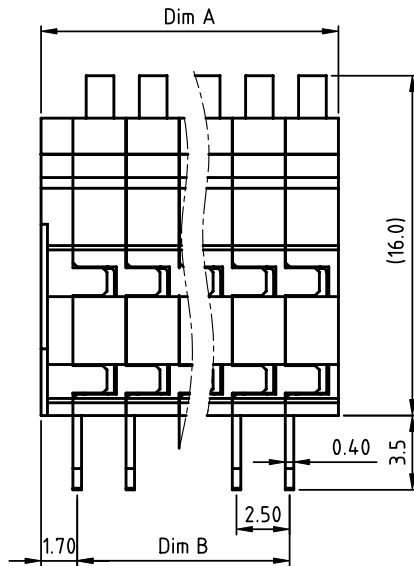
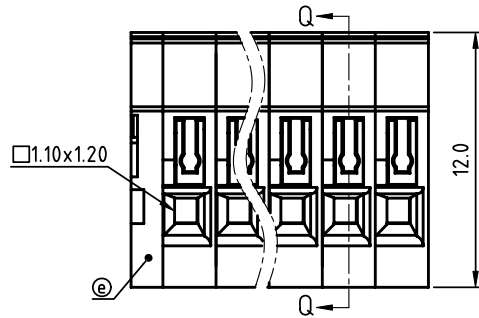

RECOMMENDED P.C.B LAYOUT  
TOP VIEW

Material:

- Item@ Terminal lever: Thermoplastic(UL94 V-0)
- ItemⓄ Terminal body Thermoplastic(UL94 V-0)
- ItemⓄ Solder pin: Brass Tin plated
- ItemⓄ wire guard: Stainless steel
- Item@ Terminal cover: Thermoplastic(UL94 V-0)

Electrical cULus

- Voltage rating: 150V
- Current rating: 3A
- Wire range: 0.08-0.52mm<sup>2</sup>
- Solid wire(AWG): 20-28
- Stranded wire(AWG): 20-28
- Wire strip length: 9-10mm
- Withstanding Voltage: 1.3KV
- Operating temperature: -40°C to +115°C
- Soldering temperature: 260°C±5°C/5 Sec
- Safety Approval:

PART NO.: NA xx B0 x 0 00J0 G

N=Number of poles  
Dim A=Nx2.5+1.5  
Dim B=(N-1)x2.5

Poles	Tolerance
2-6p	±0.20
7-12p	±0.25
13-24p	±0.30

End stackable	No. of poles	Color	RoHS compliant
0	2	Black (RAL9005)	RoHS compliant (lead<4%) In copper Alloy
02	2 poles	Red (RAL3001/D)	
03	3 poles	Orange(RAL2011/P)	
...	...	Yellow(RAL1018/A)	
...	...	Green(RAL6018/T)	
24	24 poles	Blue (RAL5015/A)	
		8 Grey(RAL7004/P)	
		9 White(RAL1102)	
		C Multiple colors	

mat'l. code		surface ASME Y14.5	tolerance ASME Y14.5	projection 	product family TERMINAL BLOCK
ltr	ecn no	dr	date	MM	title TERMINAL BLOCK
tolerances unless otherwise specified					
angles		X.±0.5		scale	dwg no NAXxB0x000J0G
file		X.X±0.3			
X*±1"		X.XX±0.1			sheet 1 of 1
dr	EVIN ZHONG	052314			size A4
enr	EVIN ZHONG	052314			type CUSTOMER Drawing
chr	HANKE FENG	052314			
appd	SHI JUN	052314			
sheet index	revision sheet	A	1		