



Chipsmall Limited consists of a professional team with an average of over 10 year of expertise in the distribution of electronic components. Based in Hongkong, we have already established firm and mutual-benefit business relationships with customers from,Europe,America and south Asia,supplying obsolete and hard-to-find components to meet their specific needs.

With the principle of “Quality Parts,Customers Priority,Honest Operation,and Considerate Service”,our business mainly focus on the distribution of electronic components. Line cards we deal with include Microchip,ALPS,ROHM,Xilinx,Pulse,ON,Everlight and Freescale. Main products comprise IC,Modules,Potentiometer,IC Socket,Relay,Connector.Our parts cover such applications as commercial,industrial, and automotives areas.

We are looking forward to setting up business relationship with you and hope to provide you with the best service and solution. Let us make a better world for our industry!



Contact us

Tel: +86-755-8981 8866 Fax: +86-755-8427 6832

Email & Skype: info@chipsmall.com Web: www.chipsmall.com

Address: A1208, Overseas Decoration Building, #122 Zhenhua RD., Futian, Shenzhen, China





NetCon-SXL-USB



USB-Device-Server for the integration of USB-HID devices into a network

Without the system driver you can now integrate USB input devices such as a keyboard, barcode scanner, RFID reader, Smart Card Reader, SignPads, PinPads etc. into a network. The only requirement is that your USB terminal is a HID device (USB class 03). All input data such as keystrokes, barcode scans, RFID data etc. can be directly requested or sent as ASCII data via TCP/IP. In addition, the data connection can be secured against unauthorised access by third parties with integrated SSL/TLS data encryption. Furthermore, the individually adaptable Web interface allows you to integrate your personal website. Printers (USB class 07) can also be connected without system drivers and consequently be used in the network.

Connection options:

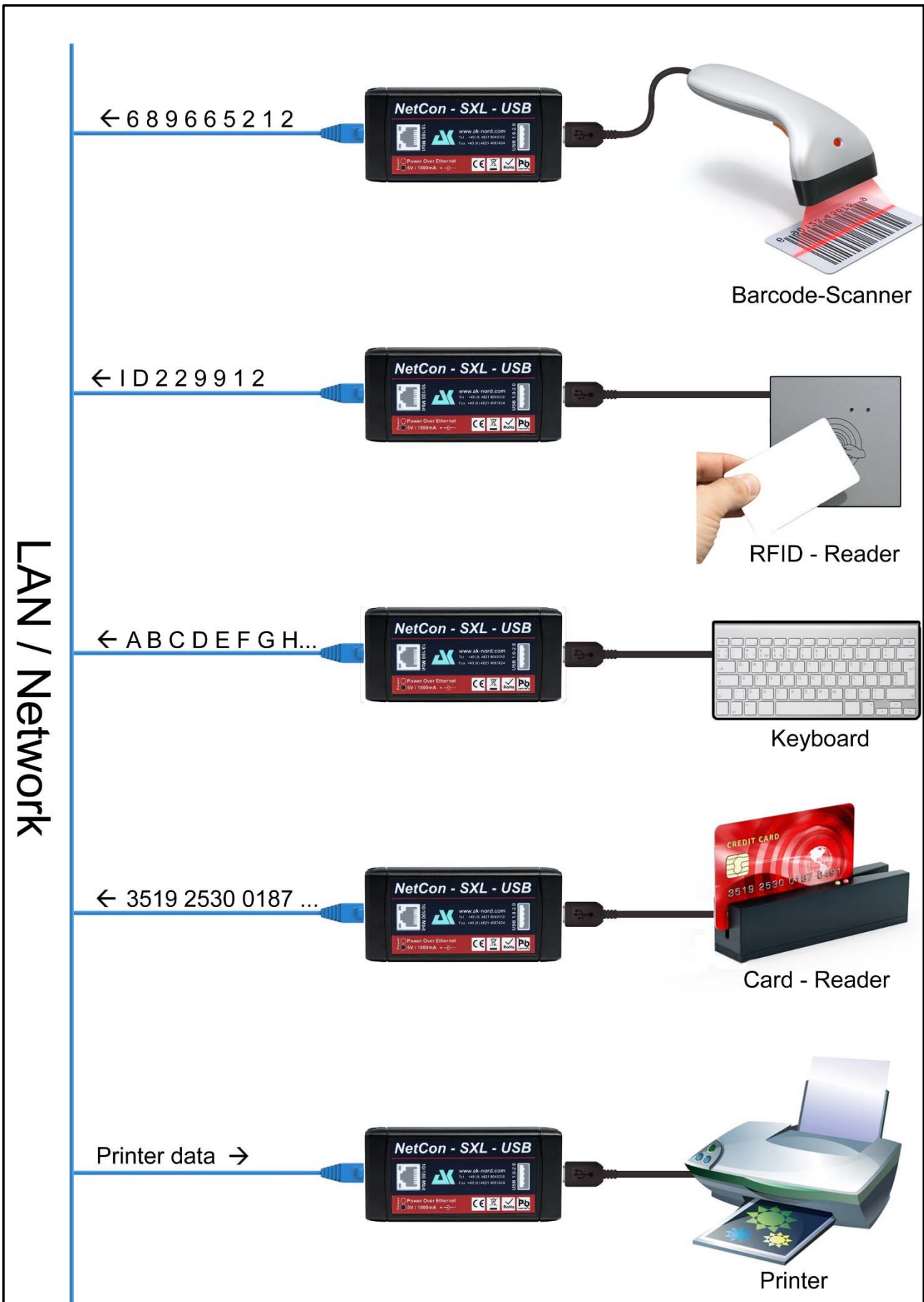

Technical data

- **Dimensions:**
40 x 21 x 82 mm (WxHxL)
- **Housing:**
Impact-proof plastic
- **Weight:**
37 grams
- **Temperature range:**
-40°C ...+ 70°C
- **Standards:**
CE / WEEE / RoHS-II
EN 55022 Class B
EN 55024 Class A
- **Power supply:**
-Switched power supply 5Volt, 2A
-PowerOverEthernet IEEE802.3af
- **Power consumption:**
5 Volts / ca. 200 mA
- **Connectors:**
1 x Ethernet RJ45
1 x USB-A Jack
- **Ethernet (M-DIX)**
10 Half Duplex
10 Full Duplex
100 Half Duplex
100 Full Duplex
AutoSensing
- **USB 1.0, 1.1, 2.0**
Host Mode
- Class 03 HID
- Class 07 Printer
- Class 09 Hub

Supported protocols IP-Dual-Stack

- IPv4
- TCP
- UDP
- FTP
- FTPS
- TFTP
- ICMP
- ARP
- SNMP
- LPR
- DHCP
- BOOTP
- DNS
- TELNET
- HTML
- HTTP
- HTTPS
- DYNDNS
- SMTP
- POP3
- SYSLOG
- AK-M2M
- IPv6
- NDP
- ICMPv6
- DHCPv6
- TCPv6
- UDPv6
- Netbios-NS
- LLMNR
- ZeroConfig
-APIPA
-AutoIP
- IP-Multicast
- IEEE802.1x
- SSL 3.0
- TLS 1.0
- TLS1.1
- TLS1.2

Management

1. Telnet
2. Browser

Views



Front with power
supply connector



Front with
PowerOverEthernet



Rear side with
USB connector

Emulations and functions

- Connect-On-Data
- Auto-Connect
- DYNDNS-Client
- FTP-Server
- LPR-Server
- 512KB internal flashdrive
- Flash-File-System
- E-Mail – Client
- TCP/UDP -Client
- TCP/UDP –Server
- SYSLOG-Client
- AKM2M

Order numbers

NetCon-SXL-USB-NT
NetCon-SXL-USB-POE

with switched power supply 5Volt, 2A
with PowerOverEthernet IEEE802.3af

Safety

- SSLv3
- TLS1.0
- TLS1.1
- TLS1.2
- IEEE 802.1x