



Chipsmall Limited consists of a professional team with an average of over 10 year of expertise in the distribution of electronic components. Based in Hongkong, we have already established firm and mutual-benefit business relationships with customers from,Europe,America and south Asia,supplying obsolete and hard-to-find components to meet their specific needs.

With the principle of “Quality Parts,Customers Priority,Honest Operation,and Considerate Service”,our business mainly focus on the distribution of electronic components. Line cards we deal with include Microchip,ALPS,ROHM,Xilinx,Pulse,ON,Everlight and Freescale. Main products comprise IC,Modules,Potentiometer,IC Socket,Relay,Connector.Our parts cover such applications as commercial,industrial, and automotives areas.

We are looking forward to setting up business relationship with you and hope to provide you with the best service and solution. Let us make a better world for our industry!



## Contact us

Tel: +86-755-8981 8866 Fax: +86-755-8427 6832

Email & Skype: info@chipsmall.com Web: www.chipsmall.com

Address: A1208, Overseas Decoration Building, #122 Zhenhua RD., Futian, Shenzhen, China



REV.	ECD	DESCRIPTION	DATE	BY
A	644	INITIAL RELEASE	6/15/2005	TT
B	879	ADDED .60mm TO 'B' DIM	12/28/2005	TT
C	1046	CLARIFY TOP/BOTTOM ENTRY AS SAME PART	12/28/2005	MNH

No. of Positions	DIMENSIONS		
	A	B	C
5	8.00	10.60	6.00
6	10.00	12.60	8.00
7	12.00	14.60	10.00
8	14.00	16.60	12.00
9	16.00	18.60	14.00
10	18.00	20.60	16.00
11	20.00	22.60	18.00
12	22.00	24.60	20.00
13	24.00	26.60	22.00
14	26.00	28.60	24.00
15	28.00	30.60	26.00
16	30.00	32.60	28.00
17	32.00	34.60	30.00
18	34.00	36.60	32.00
19	36.00	38.60	34.00
20	38.00	40.60	36.00
21	40.00	42.60	38.00
22	42.00	44.60	40.00
23	44.00	46.60	42.00
24	46.00	48.60	44.00
25	48.00	50.60	46.00
26	50.00	52.60	48.00
27	52.00	54.60	50.00
28	54.00	56.60	52.00
29	56.00	58.60	54.00
30	58.00	60.60	56.00
31	60.00	62.60	58.00
32	62.00	64.60	60.00
33	64.00	66.60	62.00
34	66.00	68.60	64.00
35	68.00	70.60	66.00
36	70.00	72.60	68.00
37	72.00	74.60	70.00
38	74.00	76.60	72.00
39	76.00	78.60	74.00
40	78.00	80.60	76.00

NOTE: Number of contacts (pins) is not the same as the number of positions. For this dual row connector, each position has 2 contacts (pins).

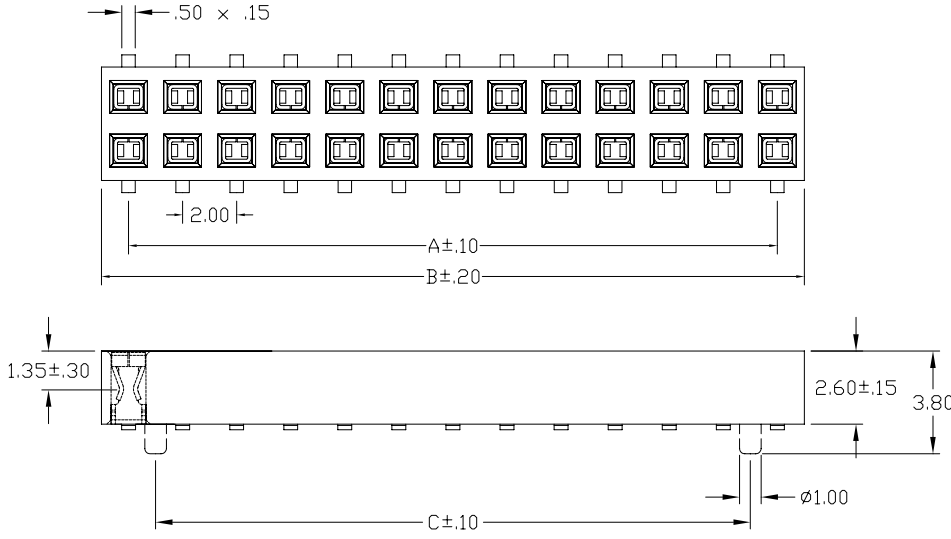

**SPECIFICATIONS**

Current Rating: 1 Amp  
 Insulator resistance: 5000 Megohms min.  
 Contact resistance: 20 m ohms max.  
 Dielectric withstanding: AC 500 V  
 Operating Temperature: -40° to +105°C  
 Max Processing Temp: 230°C for 30-60 seconds (260°C for 10 seconds)  
 Contact Material: Phosphor Bronze.  
 Insulator Material: Nylon-6T  
 Contacts Plating: Gold flash overall

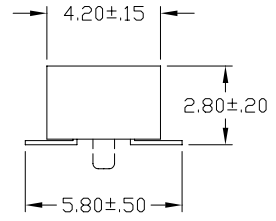

**RECOMMENDED P.C. BOARD SMT LAYOUT**

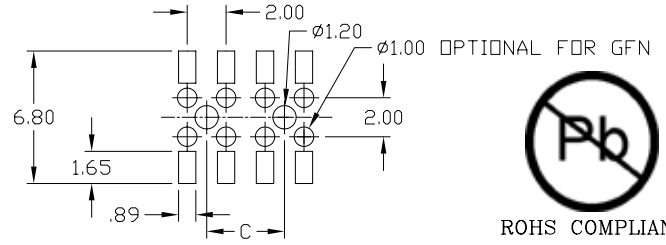

**PART NUMBER CODING**  
 NPPNxx2GxNx-RC

**MOUNTING STYLE**  
 P - SURFACE MOUNT W/ GUIDE PINS  
 S - SURFACE MOUNT W/O GUIDE PINS

**ENTRY TYPE**  
 F - TOP  
 H - BOTTOM

**NUMBER OF POSITIONS**  
 (5 - 40)

NOTE: TOP AND BOTTOM ENTRY PARTS ARE IDENTICAL AND INTERCHANGABLE

Sullins Electronics 801 E. Mission Rd. San Marcos, CA 92069	<b>GENERAL TOLERANCE</b>		<b>SCALE</b>	<b>NTS</b>	<b>DRAWN</b>	<b>TT</b>	<b>DATE</b>	<b>DWG. NO.</b>	<b>TITLE</b>	<b>REV.</b>
	XX. ±	XXX. ±	UNIT	MM	CHECK	MNH	DATE	10496	2.00mm FEMALE HEADER	C
	X. ± 0.20	.XXX ±	SIZE		APPROVE		DATE	NPPNxx2GxNx-RC	TOP/BOTTOM ENTRY, SMT	SHEET
	.X ± 0.10	X.* ±							2.80mm INSULATOR	
.XX ± 0.05	.X.* ±									