



Chipsmall Limited consists of a professional team with an average of over 10 year of expertise in the distribution of electronic components. Based in Hongkong, we have already established firm and mutual-benefit business relationships with customers from,Europe,America and south Asia,supplying obsolete and hard-to-find components to meet their specific needs.

With the principle of “Quality Parts,Customers Priority,Honest Operation,and Considerate Service”,our business mainly focus on the distribution of electronic components. Line cards we deal with include Microchip,ALPS,ROHM,Xilinx,Pulse,ON,Everlight and Freescale. Main products comprise IC,Modules,Potentiometer,IC Socket,Relay,Connector.Our parts cover such applications as commercial,industrial, and automotives areas.

We are looking forward to setting up business relationship with you and hope to provide you with the best service and solution. Let us make a better world for our industry!



Contact us

Tel: +86-755-8981 8866 Fax: +86-755-8427 6832

Email & Skype: info@chipsmall.com Web: www.chipsmall.com

Address: A1208, Overseas Decoration Building, #122 Zhenhua RD., Futian, Shenzhen, China



A B C D E F

REV.	MODIFICATION.	DATE	DRN
01	NEW DRAWING	18/10/04	NJB
02	ECN 06-277	29/11/06	NJB
03	CO2010114	06/03/08	SF
04	CO2010826	18/09/09	OW

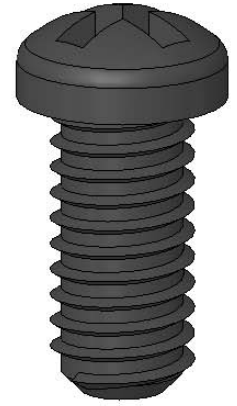
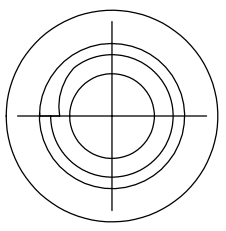
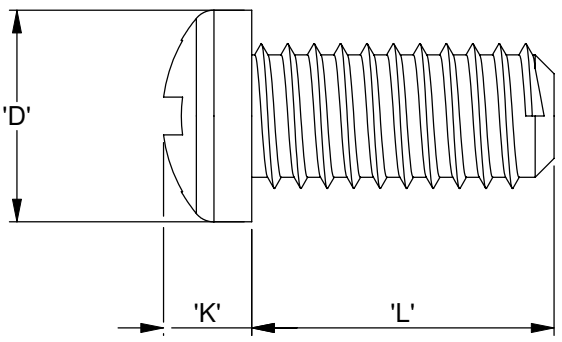

NOTES:
 1) ALTERNATE UNITS FOR REFERENCE ONLY
 2) ALL PRIMARY DIMENSIONS IN mm,
 SECONDARY DIMENSIONS IN INCHES.

INFORMATION CONTAINED IN THIS DOCUMENT IS CONFIDENTIAL TO RICHCO INTERNATIONAL Co., Ltd. AND MAY NOT BE DISCLOSED OR REPRODUCED IN WHOLE OR PART WITHOUT THEIR WRITTEN CONSENT

RICHCO, INC.
WWW.RICHCO-INC.COM

GENERAL TOLERANCES ±0.25 [0.010]
 ARE PRIMARY UNLESS OTHERWISE SPECIFIED
 1 DECIMAL PLACE ±
 2 DECIMAL PLACES ±
 ANGULAR ±1°

PART REF:	L ±0.5 [±.02]										D	K
NSE-34812-M6-L	8.0	10.0	12.0	16.0	20.0	25.0	30.0	40.0	50.0	60.0	12.0	4.6
	[.315]	[.394]	[.473]	[.630]	[.788]	[.985]	[1.182]	[1.575]	[1.969]	[2.363]	[.472]	[.181]
NSE-34812-M5-L	6.0	8.0	10.0	12.0	16.0	20.0	25.0	30.0	40.0	50.0	9.5	3.7
	[.236]	[.315]	[.394]	[.473]	[.630]	[.788]	[.985]	[1.182]	[1.575]	[1.969]	[.374]	[.145]
NSE-34812-M4-L	6.0	8.0	10.0	12.0	16.0	20.0	25.0	30.0	40.0		8.0	3.1
	[.236]	[.315]	[.394]	[.473]	[.630]	[.788]	[.985]	[1.182]	[1.575]		[.315]	[.122]
NSE-34812-M3-L	4.0	5.0	6.0	8.0	10.0	12.0	16.0	20.0	25.0		6.0	2.4
	[.158]	[.197]	[.236]	[.315]	[.394]	[.473]	[.630]	[.788]	[.985]		[.236]	[.094]

MATERIAL: NYLON 6/6 (RMS-179)				COLOUR: NATURAL	
TITLE: METRIC SCREW (DIN 34812)				PART No.: NSE-34812-MX-L	
DRG No.: 04-118		NPR REF:			SIZE A4
DRN NJB	DATE 18/10/04	CHKD I.C	DATE 18/10/04	SCALE NTS	SHEET No 1 OF 1

A B C D E F