



Chipsmall Limited consists of a professional team with an average of over 10 year of expertise in the distribution of electronic components. Based in Hongkong, we have already established firm and mutual-benefit business relationships with customers from,Europe,America and south Asia,supplying obsolete and hard-to-find components to meet their specific needs.

With the principle of “Quality Parts,Customers Priority,Honest Operation,and Considerate Service”,our business mainly focus on the distribution of electronic components. Line cards we deal with include Microchip,ALPS,ROHM,Xilinx,Pulse,ON,Everlight and Freescale. Main products comprise IC,Modules,Potentiometer,IC Socket,Relay,Connector.Our parts cover such applications as commercial,industrial, and automotives areas.

We are looking forward to setting up business relationship with you and hope to provide you with the best service and solution. Let us make a better world for our industry!



## Contact us

Tel: +86-755-8981 8866 Fax: +86-755-8427 6832

Email & Skype: info@chipsmall.com Web: www.chipsmall.com

Address: A1208, Overseas Decoration Building, #122 Zhenhua RD., Futian, Shenzhen, China



THIS COPY IS PROVIDED ON A RESTRICTED BASIS AND IS NOT TO BE USED IN ANY WAY DETRIMENTAL TO THE INTERESTS OF PANDUIT CORP.

NOTES:

1. VISIT OUR ON-LINE CATALOG AT WWW.PANDUIT.COM FOR A LIST OF CURRENT PARTS APPLICABLE FOR USE WITH THIS PRODUCT.
2. PRIMARY DIMENSIONS ARE IN MILLIMETERS (mm).
3. PARTS SUPPLIED:  
 (2) - PDU BRACKETS  
 (8) - TORX SCREWS  
 (1) - INSTRUCTION SHEET (NOT SHOWN)

PANDUIT P/N	WEIGHT
NVPDUBE	0.93 Kg/EACH 2.04 LBS/EACH

PDU MOUNTING BRACKET CAN BE ADJUSTED VERTICALLY ALONG CABINET PER RACK SPACE

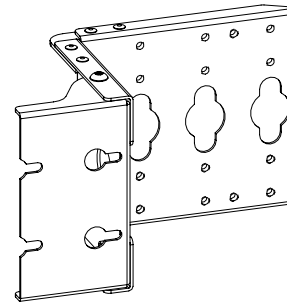

ISO VIEW

NET ACCESS N-TYPE PDU BRACKET (NVPDUBE)

CUSTOMER DRAWING

ITEM REVISION NAME

11V223AN/01

DATASET FILE NAME

11V223AN\_DC/01A

UNLESS OTHERWISE SPECIFIED, DIMENSIONAL TOLERANCES ARE:

INCHES	METRIC - MILLIMETER	ANGLE
X.X +/- 0.03	X +/- 0.8	+/- 1°
X.XX +/- 0.018	X.X +/- 0.46	
X.XXX +/- 0.007	X.XX +/- 0.18	

MATERIAL:

N/A

DRAWING NUMBER:

11V223AN-DC

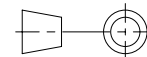

THIRD ANGLE PROJECTION

REV	DATE	BY	CHK	APR	DESCRIPTION	ECN	TITLE	ITEM REVISION NAME	DATASET FILE NAME	MATERIAL	DRAWING NUMBER	SIZE
01A	6/13/17	MEX-JAGC	SSP	ELE	RELEASED TO PRODUCTION	V09001HH/02	NET ACCESS N-TYPE PDU BRACKET (NVPDUBE)	11V223AN/01	11V223AN_DC/01A	N/A	11V223AN-DC	A
											SHT 1 OF 2	

D10100DA/20

THIS COPY IS PROVIDED ON A RESTRICTED BASIS AND IS NOT TO BE USED IN ANY WAY DETRIMENTAL TO THE INTERESTS OF PANDUIT CORP.

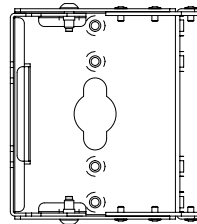
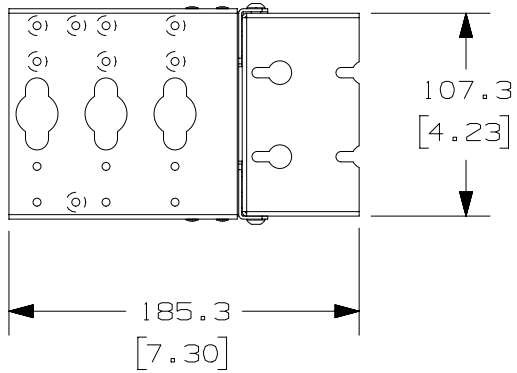
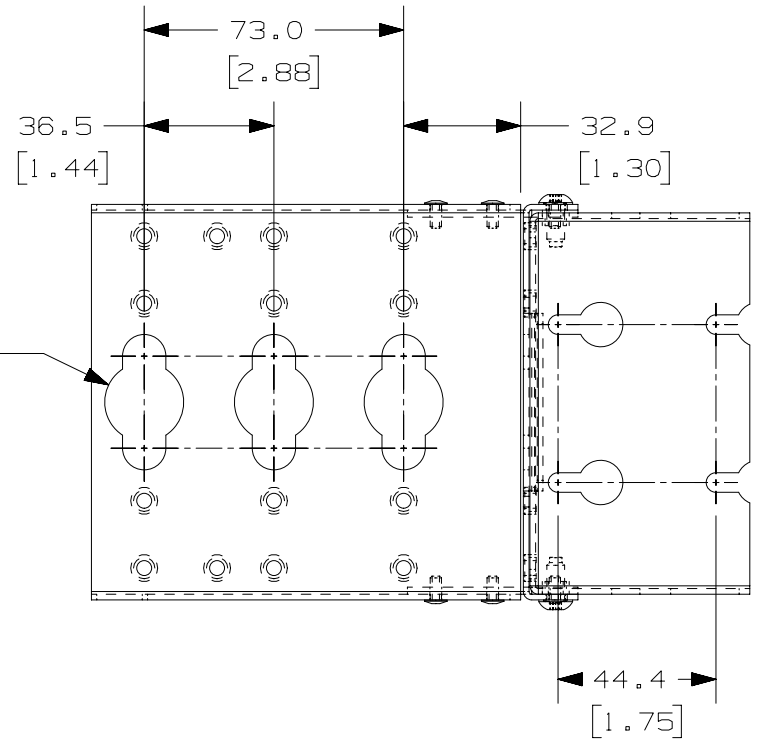
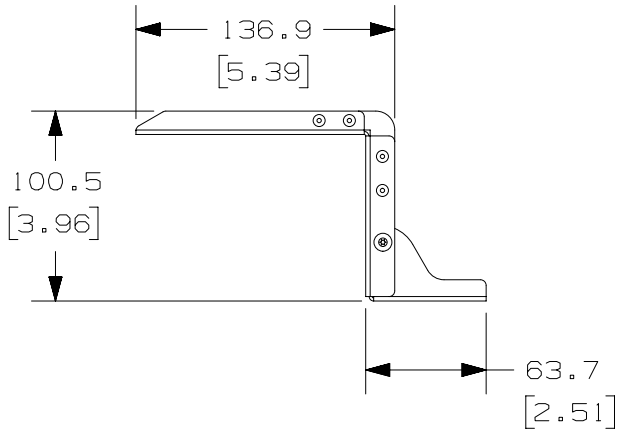

01A	6/13/17	MEX-JAGC	SSP	ELE	SEE SHEET 1 FOR REVISIONS			V09001HH/02	
REV	DATE	BY	CHK	APR	DESCRIPTION			ECN	

TITLE <b>NET ACCESS N-TYPE PDU BRACKET (NVPDUBE)</b>			
CUSTOMER DRAWING			
ITEM REVISION NAME 11V223AN/01		<b>PANDUIT</b>	
DATASET FILE NAME 11V223AN_DC/01A			
UNLESS OTHERWISE SPECIFIED, DIMENSIONAL TOLERANCES ARE:			MATERIAL: N/A
INCHES	METRIC - MILLIMETER	ANGLE	
X.X +/- 0.03	X +/- 0.8	+/- 1°	
X.XX +/- 0.018	X.X +/- 0.46		
X.XXX +/- 0.007	X.XX +/- 0.18		
DRAWN BY MEX-JAGC		DATE 6/13/17	CHK SSP
THIRD ANGLE PROJECTION		SCALE NONE	DRAWING NUMBER: 11V223AN-DC
SHT 2 OF 2		SIZE A	

DL10100DA/20