



Chipsmall Limited consists of a professional team with an average of over 10 year of expertise in the distribution of electronic components. Based in Hongkong, we have already established firm and mutual-benefit business relationships with customers from,Europe,America and south Asia,supplying obsolete and hard-to-find components to meet their specific needs.

With the principle of "Quality Parts,Customers Priority,Honest Operation,and Considerate Service",our business mainly focus on the distribution of electronic components. Line cards we deal with include Microchip,ALPS,ROHM,Xilinx,Pulse,ON,Everlight and Freescale. Main products comprise IC,Modules,Potentiometer,IC Socket,Relay,Connector.Our parts cover such applications as commercial,industrial, and automotives areas.

We are looking forward to setting up business relationship with you and hope to provide you with the best service and solution. Let us make a better world for our industry!



Contact us

Tel: +86-755-8981 8866 Fax: +86-755-8427 6832

Email & Skype: info@chipsmall.com Web: www.chipsmall.com

Address: A1208, Overseas Decoration Building, #122 Zhenhua RD., Futian, Shenzhen, China



NYLON 6/6 (RMS-01) COLOR: NATURAL PART NO.	FLAME RETARDANT (RMS-19) COLOR: NATURAL PART NO.
OFSH-4-1-01LA	OFSH-4-1-19LA

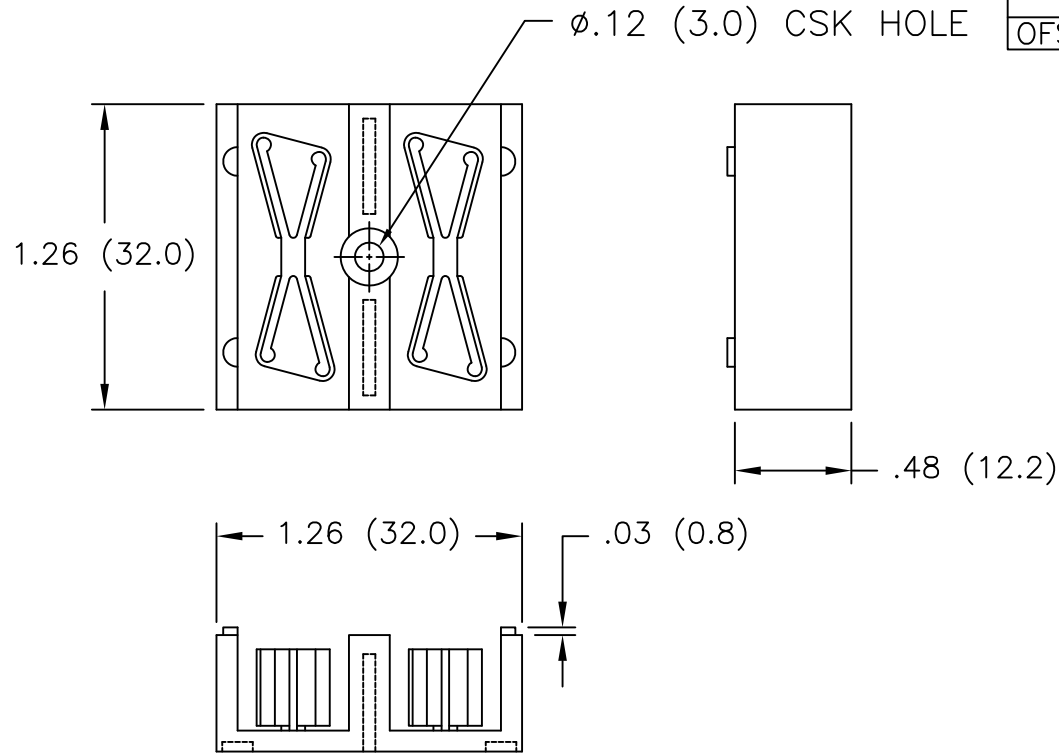

NOTES:

1. OPTIONAL ADHESIVE PATCHES (RMS-400), SUPPLIED SEPARATELY IN THE BAG.
2. ABILITY TO STACK WITH "M3" SCREW OR RIVETS. ALSO STACKS INDEPENDENTLY WITHOUT MOUNTING HARDWARE.
3. TO ACCEPT UP TO TWELVE 2.7 DIA. SPLICES OR FOUR 4.2 DIA. SPLICES.
4. STANDARD PACK QUANTITY: 50.

TITLE: OPTICAL FIBER SPLICE HOLDER				⊕	≡	DWG IN IN (MM)	Ⓜ
TOLERANCES UNLESS NOTED .XX=±.010 .XXX=±.005 FRAC=±1/64 ANG=±1'	FILE # OFSH-4	DWN: J.L.	APP:	FINAL			
	MAT'L: SEE TABLE	DT: 7.31.98	DT:	PART #		PRINT	
	RE: RICHCO, INC.	RICHCO INC. PO BOX 804238, CHICAGO, 60680 (773) 539-4060		SEE TABLE		TYPE CA	

C	SEE CO 200381 FOR CHANGES	SK 06.17.09
B	SEE ECN #542 FOR CHANGES	SM 12.20.02
A	ADDED NOTE 5. AND CHANGED FILE NO.	SM 07.11.01
REV	DESCRIPTION	ENGR DATE