



Chipsmall Limited consists of a professional team with an average of over 10 year of expertise in the distribution of electronic components. Based in Hongkong, we have already established firm and mutual-benefit business relationships with customers from,Europe,America and south Asia,supplying obsolete and hard-to-find components to meet their specific needs.

With the principle of "Quality Parts,Customers Priority,Honest Operation,and Considerate Service",our business mainly focus on the distribution of electronic components. Line cards we deal with include Microchip,ALPS,ROHM,Xilinx,Pulse,ON,Everlight and Freescale. Main products comprise IC,Modules,Potentiometer,IC Socket,Relay,Connector.Our parts cover such applications as commercial,industrial, and automotives areas.

We are looking forward to setting up business relationship with you and hope to provide you with the best service and solution. Let us make a better world for our industry!



Contact us

Tel: +86-755-8981 8866 Fax: +86-755-8427 6832

Email & Skype: info@chipsmall.com Web: www.chipsmall.com

Address: A1208, Overseas Decoration Building, #122 Zhenhua RD., Futian, Shenzhen, China



REV.	MODIFICATION.	DATE	DRN
01	CO 2010732	14/07/09	TC

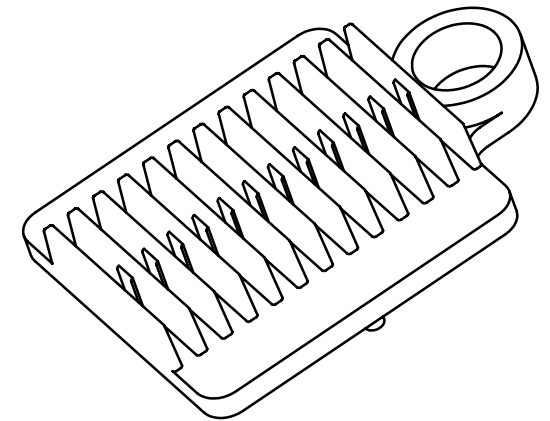
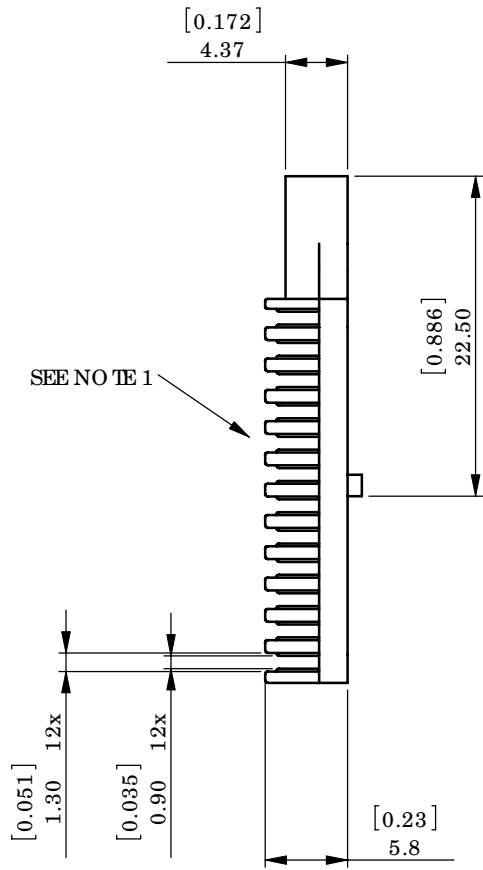
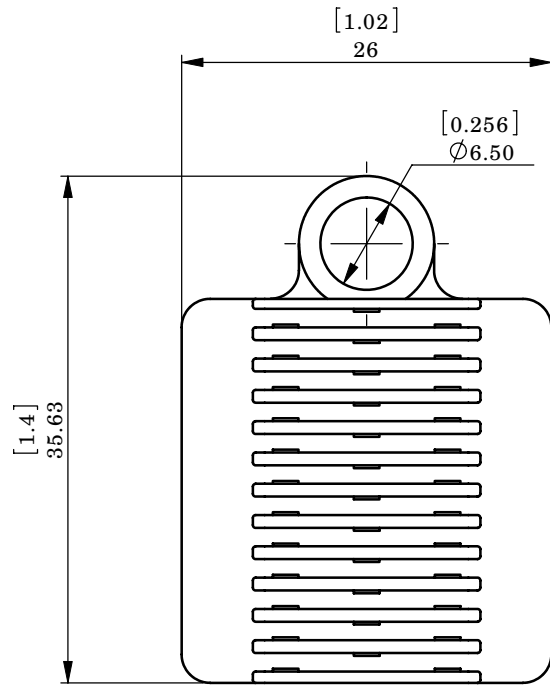

NOTES:
 1) FINS MAY BE SUBJECT TO SLIGHT GASSING ON EDGES
 2) ALTERNATE UNITS FOR REFERENCE ONLY

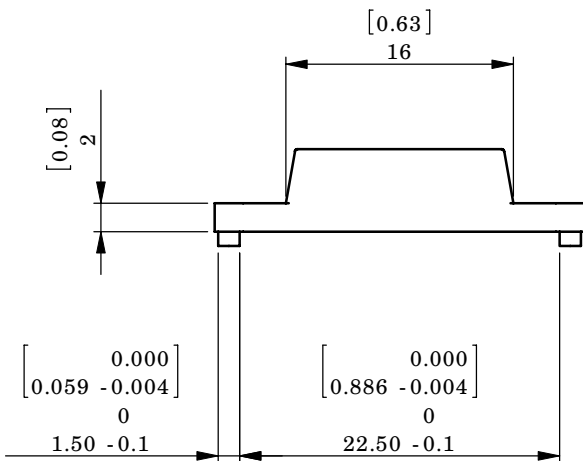

PARTNo	MATERIAL
OFSH-T-12-01BLK	NYLON 66 UL94 V-2 (RMS-01)
OFSH-T-12-19BLK	NYLON 66 UL94 V-0 (RMS-19)

INFORMATION CONTAINED IN THIS DOCUMENT IS CONFIDENTIAL TO RICHCO INTERNATIONAL Co., Ltd. AND MAY NOT BE DISCLOSED OR REPRODUCED IN WHOLE OR PART WITHOUT THEIR WRITTEN CONSENT

RICHCO, INC.
 WWW.RICHCO-INC.COM

ALL DIMENSIONS IN mm
 GENERAL TOLERANCES ±0.25
 UNLESS OTHERWISE STATED
 1 DECIMAL PLACE ±
 2 DECIMAL PLACES ±
 ANGULAR ±1°

THIRD ANGLE

MATERIAL: SEE TABLE		COLOUR: BLACK	
DESCRIPTION: SPLICE HOLDER		PARTNo: SEE TABLE	
DRG No: 09-065	NPR No: 2001-146	SHEET SIZE A4	
DRN TC	DATE 14/07/09	CHKD JK	DATE 14/07/09
SCALE NTS	SHEETNo. 1 OF 1		