



Chipsmall Limited consists of a professional team with an average of over 10 year of expertise in the distribution of electronic components. Based in Hongkong, we have already established firm and mutual-benefit business relationships with customers from,Europe,America and south Asia,supplying obsolete and hard-to-find components to meet their specific needs.

With the principle of “Quality Parts,Customers Priority,Honest Operation,and Considerate Service”,our business mainly focus on the distribution of electronic components. Line cards we deal with include Microchip,ALPS,ROHM,Xilinx,Pulse,ON,Everlight and Freescale. Main products comprise IC,Modules,Potentiometer,IC Socket,Relay,Connector.Our parts cover such applications as commercial,industrial, and automotives areas.

We are looking forward to setting up business relationship with you and hope to provide you with the best service and solution. Let us make a better world for our industry!



Contact us

Tel: +86-755-8981 8866 Fax: +86-755-8427 6832

Email & Skype: info@chipsmall.com Web: www.chipsmall.com

Address: A1208, Overseas Decoration Building, #122 Zhenhua RD., Futian, Shenzhen, China



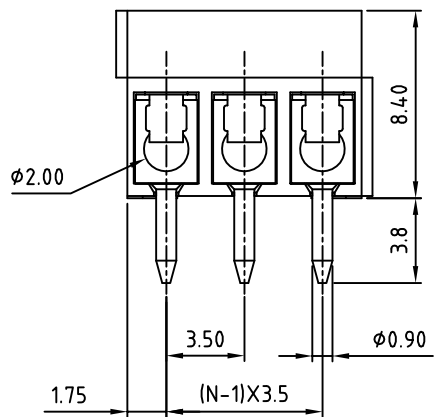
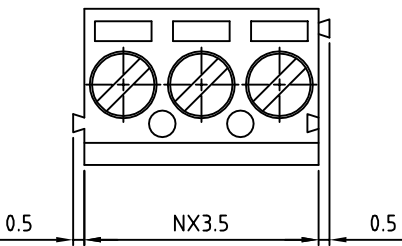

N=Number of contacts

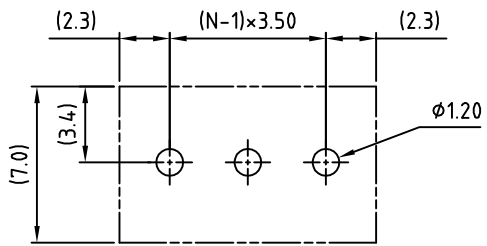

P.C.B. LAYOUT

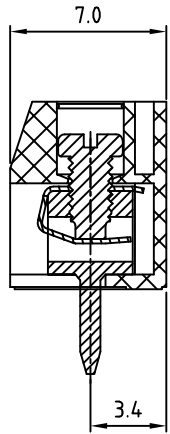

SIGN	DATE	DESCRIPTION	APPROVER

Material

- Terminal body(metal housing): Brass(CuZn),Tin plated
- Terminal screw: Steel Zinc plating "-" slot type
- Wire guard :stainless steel
- Insulator (housing): Thermoplastic (UL94V-0)

Electrical UL / CSA

- Voltage rating: 125V/125V
- Current rating: 10A/10A
- Wire range:
 - Solid wire(AWG): 16-26 / 16-26
 - Stranded wire(AWG): 16-26 / 16-26
- Torque: 1.7Lb-In/4kgf.cm
- Screw: M2
- Wire strip length: 5-6mm
- Withstanding Voltage: 1.25KV/1.25KV
- Operating temperature: -30°C to +105°C
- Soldering temperature: 250°C±10°C/5 Sec
- Safety Approval:

RoHS Compliant

PART NUMBER

OSTTEXX0161

No. of Poles
 02: 2 Poles
 03: 3 Poles
 ...
 24 24 Poles

COLOR
 0: Black
 5: Green
 6: Blue (Standard)
 8: Grey



THESE DRAWINGS AND SPECIFICATIONS ARE THE PROPERTY OF ON-SHORE TECHNOLOGY, INC. AND SHALL NOT BE REPRODUCED, COPIED OR USED IN ANY MANNER WITHOUT THE PRIOR WRITTEN CONSENT OF ON-SHORE TECHNOLOGY, INC.

TITLE		OSTTE 3.5mm series			
PART NO.	OSTTEXX0161			DWG NO.	OSTTEXX0161.DWG
APPROVED	CHECKED	DESIGNED	DRAWN	CUST NO.	Tolerance
	Marvin 2007.02.02	Marvin 2007.02.02	Marvin 2007.02.02		X. ±0.50 X.X ±0.30 X.XX ±0.10 X° ±1°
SHEET: 01/01				UNIT: mm SCALE: NONE REV.: B	