



Chipsmall Limited consists of a professional team with an average of over 10 year of expertise in the distribution of electronic components. Based in Hongkong, we have already established firm and mutual-benefit business relationships with customers from,Europe,America and south Asia,supplying obsolete and hard-to-find components to meet their specific needs.

With the principle of “Quality Parts,Customers Priority,Honest Operation,and Considerate Service”,our business mainly focus on the distribution of electronic components. Line cards we deal with include Microchip,ALPS,ROHM,Xilinx,Pulse,ON,Everlight and Freescale. Main products comprise IC,Modules,Potentiometer,IC Socket,Relay,Connector.Our parts cover such applications as commercial,industrial, and automotives areas.

We are looking forward to setting up business relationship with you and hope to provide you with the best service and solution. Let us make a better world for our industry!



## Contact us

Tel: +86-755-8981 8866 Fax: +86-755-8427 6832

Email & Skype: info@chipsmall.com Web: www.chipsmall.com

Address: A1208, Overseas Decoration Building, #122 Zhenhua RD., Futian, Shenzhen, China



# Customer Information Sheet

DRAWING No.: P25-XX26

SHEET 2 OF 2

IF IN DOUBT - ASK

©

NOT TO SCALE

THIRD ANGLE PROJECTION

ALL DIMENSIONS IN mm

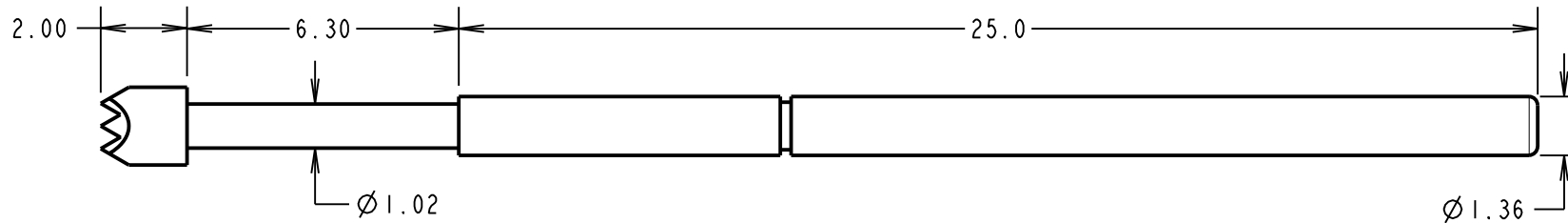

ORDER CODE:  
**P25-XX26**  
PROBE HEAD  
VARIANT (SEE BELOW)

- NOTES:  
1. TO BE USED WITH SLEEVE S25-XX6.  
2. SUITABLE FOR A MINIMUM DISTANCE BETWEEN CENTRES OF 2.54mm.

PROBE HEAD VARIANTS	
<p>SPEAR HEAD P25-0126</p>	<p>CROWN HEAD P25-3226</p>
<p>TULIP HEAD P25-1726</p>	<p>SERRATED HEAD P25-4026</p>

SPECIFICATIONS:  
MATERIAL:  
PLUNGER = BERYLLIUM COPPER  
BARREL = PHOSPHOR BRONZE  
SPRING = MUSIC WIRE  
FINISH:  
PLUNGER, BARREL AND SPRING = GOLD OVER NICKEL  
ELECTRICAL:  
CURRENT RATING = 3A  
CONTACT RESISTANCE = 30 MILLIOHMS  
MECHANICAL:  
DURABILITY = 1,000,000 CYCLES  
FULL TRAVEL = 6.30mm  
SPRING FORCES:  
AT FULL TRAVEL = 3.43N±0.69N (350g ±20%)  
AT 2/3 TRAVEL = 2.26N ±0.45N (230g ±20%)  
ENVIRONMENTAL:  
TEMPERATURE RANGE = -40°C TO +85°C

SM	5	16.03.11	11173
NAME	ISS.	DATE	C/NOTE
APPROVED: S. MCCULLAGH			
CHECKED:		R. ADDE	
DRAWN:		W. J. BOURNE	
CUSTOMER REF.:			
ASSEMBLY DRG:			

**HARWIN**

HARWIN USA TEL: 603 893 5376 FAX: 603 893 5396 mis@harwin.com	HARWIN Europe (UK) TEL: 023 9231 4545 FAX: 023 9231 4590 mis@harwin.co.uk	HARWIN Asia TEL: +65 6 779 4909 FAX: +65 6 779 3868 mis@harwin.com.sg
--	--	--

THIS DRAWING AND ANY INFORMATION OR DESCRIPTIVE MATTER SET OUT HEREON ARE CONFIDENTIAL AND COPYRIGHT PROPERTY OF THE HARWIN GROUP AND MUST NOT BE DISCLOSED, LOANED, COPIED OR USED FOR MANUFACTURING, TENDERING OR FOR ANY OTHER PURPOSE WITHOUT THEIR WRITTEN PERMISSION.

TOLERANCES  
X. = ±1mm  
X.X = ±0.25mm  
X.XX = ±0.10mm  
X.XXX = ±0.01mm  
ANGLES = ±5°  
UNLESS STATED

MATERIAL:  
SEE ABOVE  
FINISH: SEE ABOVE  
S/AREA: mm<sup>2</sup>

TITLE:  
2.54mm MIN. CENTRE  
TWO-PIECE SPRING PROBE  
DRAWING NUMBER:  
**P25-XX26**

SHT  
2 OF 2