



Chipsmall Limited consists of a professional team with an average of over 10 year of expertise in the distribution of electronic components. Based in Hongkong, we have already established firm and mutual-benefit business relationships with customers from,Europe,America and south Asia,supplying obsolete and hard-to-find components to meet their specific needs.

With the principle of “Quality Parts,Customers Priority,Honest Operation,and Considerate Service”,our business mainly focus on the distribution of electronic components. Line cards we deal with include Microchip,ALPS,ROHM,Xilinx,Pulse,ON,Everlight and Freescale. Main products comprise IC,Modules,Potentiometer,IC Socket,Relay,Connector.Our parts cover such applications as commercial,industrial, and automotives areas.

We are looking forward to setting up business relationship with you and hope to provide you with the best service and solution. Let us make a better world for our industry!



Contact us

Tel: +86-755-8981 8866 Fax: +86-755-8427 6832

Email & Skype: info@chipsmall.com Web: www.chipsmall.com

Address: A1208, Overseas Decoration Building, #122 Zhenhua RD., Futian, Shenzhen, China



P36 series

Low profile rotary code switches



DISTINCTIVE FEATURES

- 3 actuator types
- Sub-miniature size
- Solder and flux sealed, washable



ENVIRONMENTAL SPECIFICATIONS

- Operating temperature: -50 °C to +125 °C (-58 °F to +257 °F)



ELECTRICAL SPECIFICATIONS

- Operating voltage : ≤ 42 V
- Contact load, static : ≤ 0.4 A
- Contact load, dynamic : ≤ 0.1 A
- Initial contact resistance : 80 m Ω max.
- Insulation resistance : 100 M Ω min.



MATERIALS

- Base : UL94-V0, high temperature thermoplastic
- Cover : stainless steel
- Actuator : PA 4.6 nylon
- Contacts : gold over nickel plated phosphor bronze
- Terminals : tin plated



PCB MOUNTING

SURFACE MOUNT

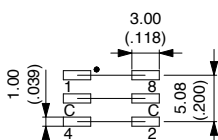

THROUGH-HOLE

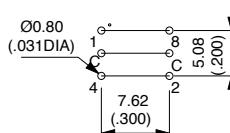

The company reserves the right to change specifications without notice.

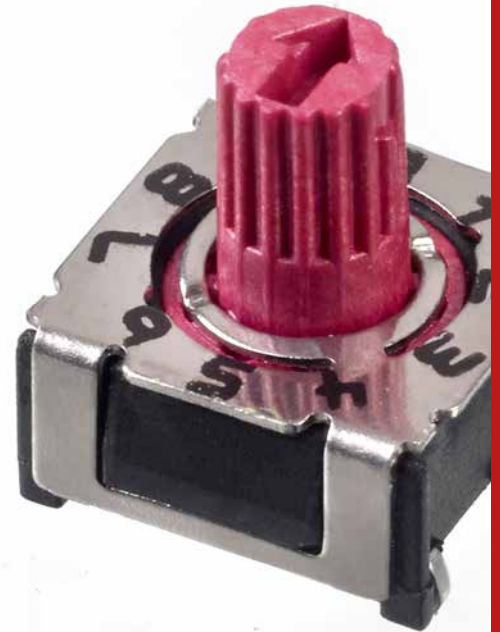

P36 series

Low profile rotary code switches



SOLDERING

- DIN CEI 68-2-20
- Manual soldering : 340 °C (644 °F) max. for 2 seconds max.
- Wave soldering : 280 °C (536 °F) max. for 5 seconds max.
- Reflow soldering : 260 °C (500 °F) max. for 10 seconds max.



PACKAGING

P36S1..

1,300 pieces per reel

dim.A = 22.4 mm

dim B = 16.4 mm

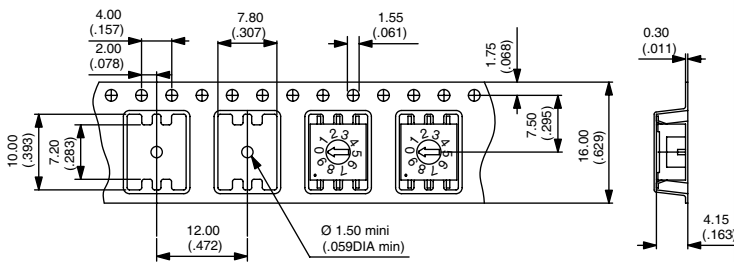

P36S3..

P36S8..

600 pieces per reel

dim.A = 30.4 mm

dim B = 24.4 mm

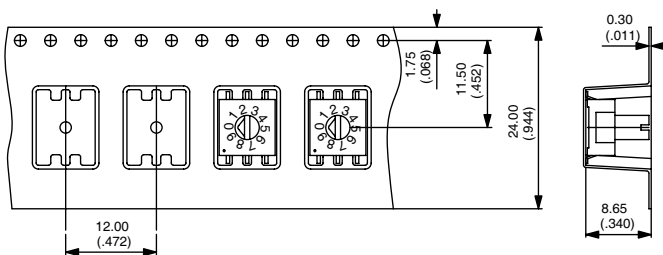

Reels : To order a SMT product with tape & reel packaging, add "TR" at the end of its part number.

Tubes : 50 pieces (through-hole or SMT) per tube.

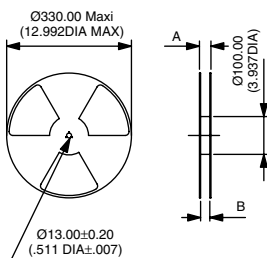

P36 series

Low profile rotary code switches



BUILD YOUR PART NUMBER

P36

SERIES

MOUNTING

ACTUATORS

CODES

TERMINALS

(none)	Through-hole
S	Surface mount

1	Screwdriver
3	Spindle
8	Slotted spindle

01	BCD
02	BCD complement
03	Hexadecimal
06	Hexadecimal complement

(none)	Straight or SMT
V	Crimped
L254	Right angle, spacing 2.54 (.100)



ABOUT THIS SERIES

On the following pages, you will find successively basic part numbers of switches and options in the same order as in above chart.

THROUGH-HOLE



P36

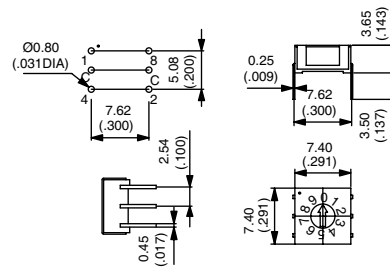

SURFACE MOUNT



P36S

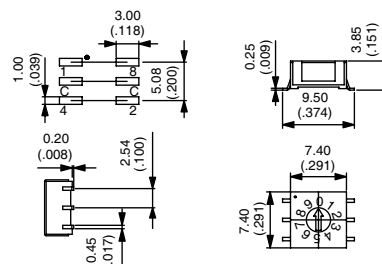

P36 series

Low profile rotary code switches

ACTUATORS

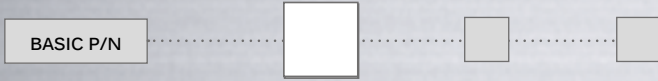

- 1 Screwdriver
- 3 Spindle
- 8 Slotted spindle

Actuator colour
 depending on codes :
 BCD : Red
 BCD compl. : Orange
 Hexadecimal : Grey
 Hexadec. compl. : White

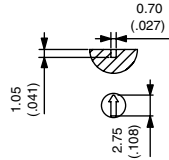

1

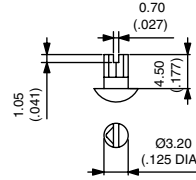

3

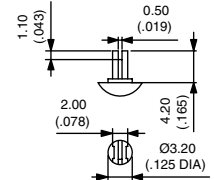

-8

CODES

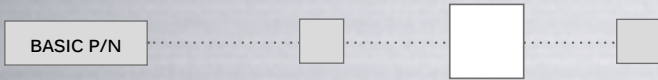

- 01 BCD
- 02 BCD complement
- 03 Hexadecimal
- 06 Hexadecimal complement

POSITION	C	1	2	4	8	MARKING
0	●					0
1	●	●				1
2	●		●			2
3	●	●	●			3
4	●			●		4
5	●	●			●	5
6	●		●	●		6
7	●	●	●	●		7
8	●				●	8
9	●	●			●	9

01

POSITION	C	1	2	4	8	MARKING
0	●	●	●	●	●	0
1	●		●		●	1
2	●	●		●	●	2
3	●			●	●	3
4	●	●	●		●	4
5	●		●		●	5
6	●	●		●	●	6
7	●				●	7
8	●	●	●	●	●	8
9	●		●	●	●	9

02

POSITION	C	1	2	4	8	MARKING
0	●					0
1	●	●				1
2	●		●			2
3	●	●	●			3
4	●			●		4
5	●	●		●		5
6	●		●	●		6
7	●	●	●	●		7
8	●				●	8
9	●	●			●	9
10	●		●		●	10
11	●	●	●		●	11
12	●			●	●	12
13	●	●		●	●	13
14	●		●	●	●	14
15	●	●	●	●	●	15

03

POSITION	C	1	2	4	8	MARKING
0	●					0
1	●	●	●	●	●	1
2	●	●		●	●	2
3	●			●	●	3
4	●	●	●		●	4
5	●		●		●	5
6	●	●			●	6
7	●				●	7
8	●	●	●	●		8
9	●		●	●		9
10	●	●		●		10
11	●			●		11
12	●	●	●			12
13	●		●			13
14	●	●				14
15	●					15

06

TERMINALS

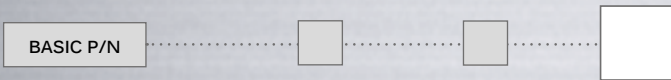

- (none) Straight or SMT
- V Crimped
- L254 Right angle, spacing 2,54 (.100)



(none)



V

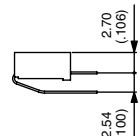
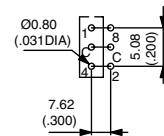
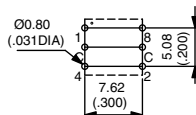

L254