



Chipsmall Limited consists of a professional team with an average of over 10 year of expertise in the distribution of electronic components. Based in Hongkong, we have already established firm and mutual-benefit business relationships with customers from,Europe,America and south Asia,supplying obsolete and hard-to-find components to meet their specific needs.

With the principle of “Quality Parts,Customers Priority,Honest Operation,and Considerate Service”,our business mainly focus on the distribution of electronic components. Line cards we deal with include Microchip,ALPS,ROHM,Xilinx,Pulse,ON,Everlight and Freescale. Main products comprise IC,Modules,Potentiometer,IC Socket,Relay,Connector.Our parts cover such applications as commercial,industrial, and automotives areas.

We are looking forward to setting up business relationship with you and hope to provide you with the best service and solution. Let us make a better world for our industry!



Contact us

Tel: +86-755-8981 8866 Fax: +86-755-8427 6832

Email & Skype: info@chipsmall.com Web: www.chipsmall.com

Address: A1208, Overseas Decoration Building, #122 Zhenhua RD., Futian, Shenzhen, China



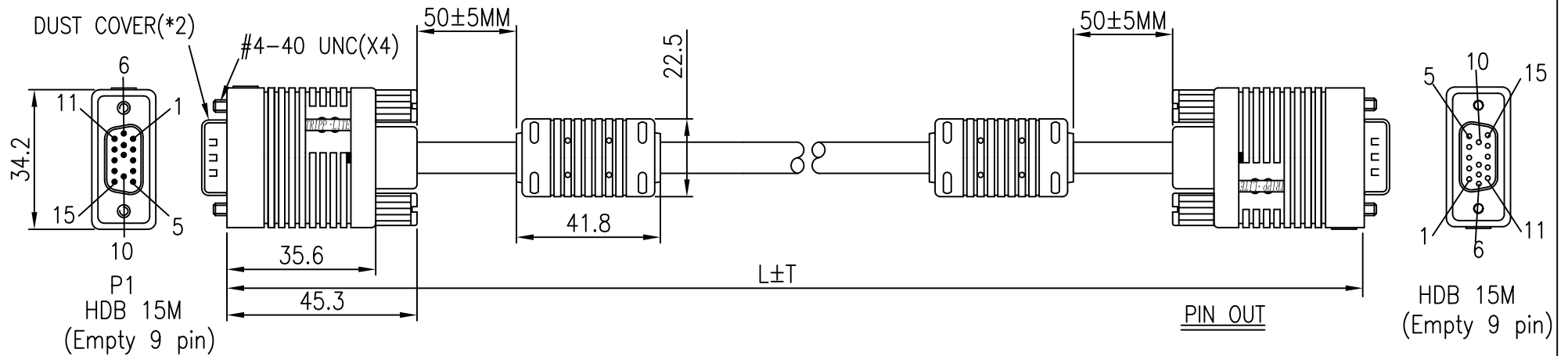

NOTE:

1. CABLE: UL2919 [(30AWG+1C+D+AL+ML)*3C+(30AWG*4C)+(30AWG*2PAIRS)],AL-FOIL AND BRAID SHIELDED(65% AL)+DRAIN WIRE(BARE COPPER), BLACK PVC VW-1&CM JACKET, SLOT $\phi 7.5 \pm 0.15$ mm.
2. CONNECTOR: P1&P2: HIGH DENSITY D-SUB 15PIN MALE: SOLDER TYPE, GOLD FLASH CONTACTS, EMPTY 9PIN AND GOLD SHELL,PBT BLACK.
3. THUMB SCREW TO BE MOLDED.
4. SHIELDED: COPPER FOIL TAPE COVER PREMOLD AND 360° SOLDER TO CONNECTOR SHELL AND CABLE BRAID.
5. ALL HOOD: MOLDED BLACK PVC.
6. TESTING:100% ELECTRICAL TEST AT 1M OHM INSULATION RESISTANCE.
SWAY TEST:FASTEN PLUG, MARKING 90° EACH FOR UP AND DOWN ONE TIME.
HI-POT TEST(AFTER SWAY TEST):DC300V,100M OHM
7. MOLD NO:HD15-01& FC-01.

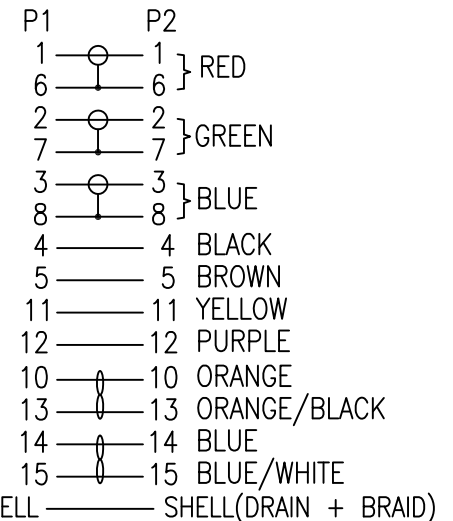

PART NO CHART:

P/N	XX(FT)	L	T
P502-006	06	1829	+51/-51
P502-010	10	3048	+51/-51
P502-015	15	4572	+152/-51
P502-020	20	6096	+152/-51
P502-025	25	7620	+152/-51
P502-030	30	9144	+152/-51
P502-035	35	10668	+152/-51
P502-040	40	12192	+305/-152
P502-050	50	15240	+305/-152
P502-075	75	22860	+305/-152
P502-100	100	30480	+305/-152

D	Increase Wire Fire Rating	11/09/15												
C	ADD THE LENGTH	11/03/14												
B	ADD THE P/N P502-020,P502-040	10/20/14												
A	INITIAL RELEASE	06/02/12												
REV	DESCRIPTION OF CHANGE	DATE												
<table border="1"> <thead> <tr> <th>TOLERANCE</th> <th>INCHES</th> <th>M/M</th> </tr> </thead> <tbody> <tr> <td>.X</td> <td>.015</td> <td>.30</td> </tr> <tr> <td>.XX</td> <td>.010</td> <td>.10</td> </tr> <tr> <td>.XXX</td> <td>.005</td> <td>.05</td> </tr> </tbody> </table>		TOLERANCE	INCHES	M/M	.X	.015	.30	.XX	.010	.10	.XXX	.005	.05	
TOLERANCE	INCHES	M/M												
.X	.015	.30												
.XX	.010	.10												
.XXX	.005	.05												
SCALE	NONE	REV D												
UNIT	MM													
DRAWN BY	LuLu	<table border="1"> <tr> <td>SHEET</td> <td>1/2</td> <td rowspan="2">DWG NO.</td> </tr> <tr> <td>DATE</td> <td>11/09/15</td> </tr> </table>	SHEET	1/2	DWG NO.	DATE	11/09/15							
SHEET	1/2	DWG NO.												
DATE	11/09/15													
CHECK BY		TITLE HD15M TO HD15M												
APPD BY		PART NO. P502-XXX												

