



Chipsmall Limited consists of a professional team with an average of over 10 year of expertise in the distribution of electronic components. Based in Hongkong, we have already established firm and mutual-benefit business relationships with customers from,Europe,America and south Asia,supplying obsolete and hard-to-find components to meet their specific needs.

With the principle of “Quality Parts,Customers Priority,Honest Operation,and Considerate Service”,our business mainly focus on the distribution of electronic components. Line cards we deal with include Microchip,ALPS,ROHM,Xilinx,Pulse,ON,Everlight and Freescale. Main products comprise IC,Modules,Potentiometer,IC Socket,Relay,Connector.Our parts cover such applications as commercial,industrial, and automotives areas.

We are looking forward to setting up business relationship with you and hope to provide you with the best service and solution. Let us make a better world for our industry!



Contact us

Tel: +86-755-8981 8866 Fax: +86-755-8427 6832

Email & Skype: info@chipsmall.com Web: www.chipsmall.com

Address: A1208, Overseas Decoration Building, #122 Zhenhua RD., Futian, Shenzhen, China



Panel Actuators and Indicators

Type PB

Red Emergency Stop Push Buttons



PB 22S



PB 22B

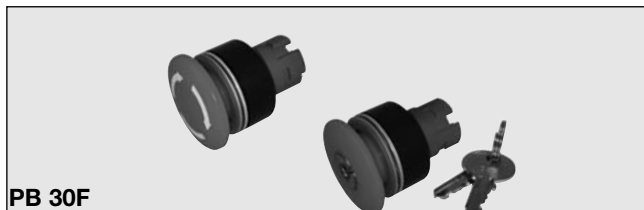

PB 30F

- Ø 22mm (Ø0.87") Standard and bezel style
- Ø 30mm (Ø1.18") Flush style
- Mushroom shape
- Push to lock, turn clockwise to reset
- Push to lock, unlock by turning the key
- Ø 40mm (Ø1.57") or Ø 60mm (Ø2.36") head
- cULus and CE
- IEC/EN 60947-5-1, UL 508, IEC/EN 60073, IEC/EN 60529
- EN 418
- IEC/EN 60947-5-5

Product description

The STOP function is obtained by pushing the head while the reset is obtained by turning clockwise the head or the key.

It is used in dangerous situations

when emergency measures are required.

They should be ordered in parts (operator + holder + contact block) and installed in an enclosure.

Approvals



Types

- EM4** = Red emergency stop Ø40mm (Ø1.57")
EM6 = Red emergency stop Ø60mm (Ø2.36")
KEM4 = Red key-reset emergency stop Ø40mm (Ø1.57")

Colour

R = Red

Ordering key

PB 22S EM4 1 R

Series _____
 Dimension and Style _____
 Type _____
 Action _____
 Colour _____

Dimensions and styles

- 22S** = Ø22mm (Ø0.87") Standard style
22B = Ø22mm (Ø0.87") Bezel style
30F = Ø30mm (Ø1.18") Flush style

Action

- 1** = Maintained

General data

Peripheral of actuator	AL
Actuator	Pa
Mechanical life	≥ 5 x 10 ⁴ cycles
Operating temperature	-25 to +70°C (-13 to +158°F)
Storage temperature	-30 to +80°C (-22 to +176°F)
Degree of protection	IP 65

Dimensions - Push Buttons mm/inches

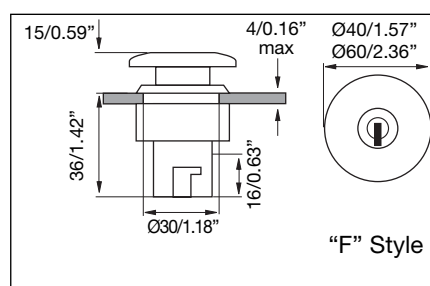
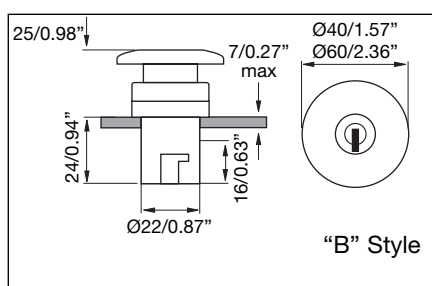
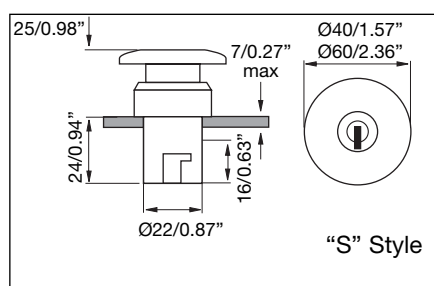

Panel Actuators and Indicators

Type PA2

Contact Block

CARLO GAVAZZI



- High switching power
- Double switch
- Industrial applications
- 10A switching capacity
- Up to 500VAC
- Modular mounting (up to 3 elements)
- Screw terminals
- High reliability
- cULus and CE
- IEC/EN 60947-5-1, IEC/EN 60947-5-5, UL 508

Product description

Switching element equipped with two independent elements. Available in different switching configurations. Pole and throw configurations can be single

pole single throw (SPST) or double pole single throw (DPST). Elements can be snapped to each other on the bottom, up to 3.

Ordering key

PA 2 110 / 1

Type _____
 Number of contacts _____
 Contact code _____
 Options (1 = Snap action
 2 = Slow action with forced opening \Rightarrow NC contact)

Approvals



Terminals

Screw terminals

Max. section single-core wire
 Max. section stranded wire
 Copper conductor wire
 Terminal tightening torque

2 x 2.5mm² (0.004sq.inch)
 2 x 1.5mm² (0.002sq.inch)
 14 AWG
 1.2Nm (10.6in.lb.)

Technical data

Contact resistance	≤50mΩ
Travel	5.8 ± 0.2mm (2.28" ± 0.08")
Rated insulation Voltage U _i	660VAC/DC (acc. to IEC 60947-5-1) 600VAC/DC (acc. to UL508)
Rated imp. withstand voltage U _{imp}	2500VAC 50Hz 1min.
Minimum switching power	
Min Current	100mA
Min Voltage	24V
Switch housing	PC
Contact parts	Cu
Contact material	
Standard	Hard silver
Optional	Gold/silver
Optional for aggressive atmospheres	Silver/palladium
Operating temperature	-25 to +70°C (-13 to +158°F)
Storage temperature	-30 to +80°C (-22 to +176°F)

Contact code

Contact configuration	Contact code
2 NO contacts (DPST)	200
2 NC contacts (DPST)	020
1 NC contact (SPST)	010
1 NO contact (SPST)	100
1 NC + 1 NO contacts (DPST)	110

Contact characteristics

Contact Rating AC1	10A @ 250VAC		
Contact Rating	AC15	DC13	
(acc. to IEC 60947-5-1)			
@ 24V	10A	6A	
@ 110V	8A	1A	
@ 220V	6A	0.5A	
@ 380V	4A	-	
@ 500V	2.5A	-	
Thermal Contact Rating	10A (A600)	5A (B600)	
(acc. to UL 508)	2.5A (Q600/Q300)		
AC Contact Rating (acc. to UL 508)	A600	B600	
B600 (all snap codes)	@ 120V 6A	3A	
A600 (all slow codes)	@ 240V 3A	1.5A	
	@ 480V 1.5A	0.75A	
	@ 600V 1.2A	0.6A	
DC Contact Rating (acc. to UL 508)	Q600	Q300	
Q600 (all snap codes)	@ 125V 0.55A	0.55A	
Q600 (100, 200 slow codes)	@ 250V 0.27A	0.27A	
Q300 (010, 020, 110 slow codes)	@ 480V 0.10A	-	
	@ 600V 0.10A	-	



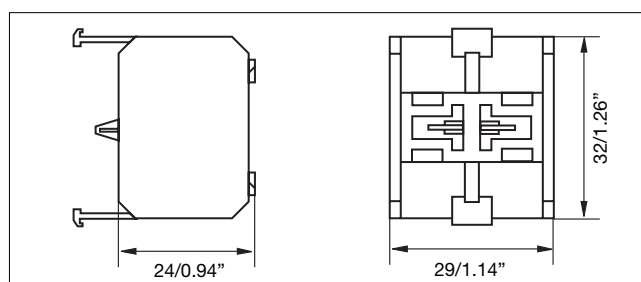

Dimensions mm/inches

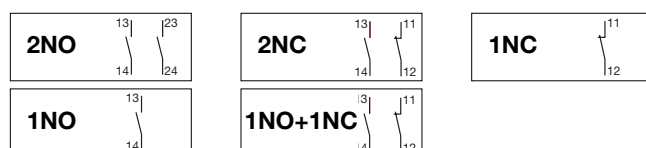

Wiring diagram

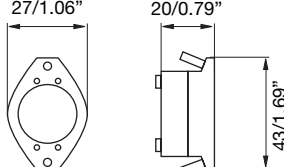

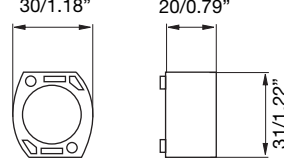
Holders

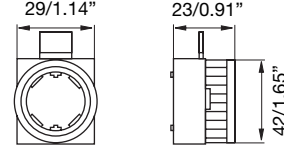
	Holder type "M"	PB MB M	
	Holder type "P"	PB MB P	
	Holder type "N"	PB MB N	
	Code		
	Material		

Assembling and Mounting

It come easy to get a complete product. Just to choose the operator, the holder, the lamp element and the contact block (up to 3).

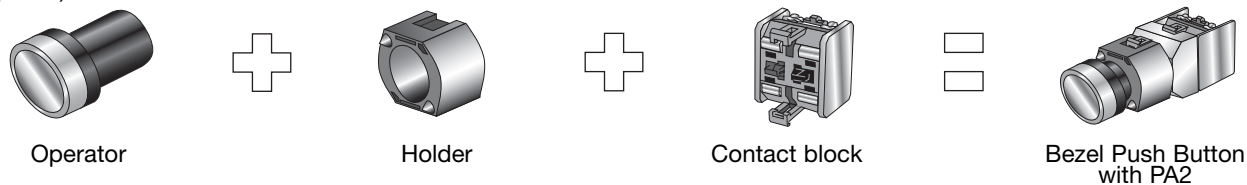

To install it, the only tool needed is a screwdriver. The same used to wiring the contact block can be used to fix the push-button.

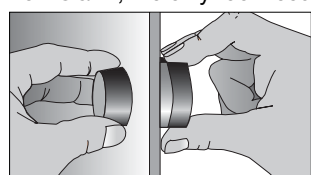

The operator will be inserted into the panel.

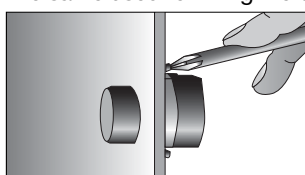



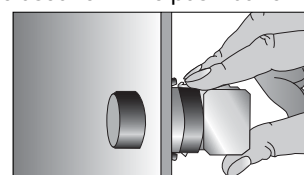



The holder will be secured at the back by two screws or nut.



The contact block is snapped on.

Accessories for Panel Actuators

	Terminal shield Installed behind the wiring screws of the contact block to avoid electric shock.	PC		PA 2 SHIELD
	Mounting ring Ø22mm (0.87") Installed on plastic panel to strengthen mounting.	FE		PA MR 22
	Mounting ring Ø25mm (0.98") When the mounting hole is Ø25mm (0.98"), it should be add to the panel.	FE		PA MR 25
	Front bezel set Ø30mm (1.18") For Ø30mm (1.18") panel hole, to have a thinner effect.	AL		PA FBZL 30
	Warning plate For emergency stop push buttons. Thickness 1.5mm/0.059"	ABS	Ø60mm/Ø2.36" Ø90mm/Ø3.54"	PA WP 6 PA WP 9
	Panel hole cap Ø22mm (0.87") For blocking up prepared or useless holes on the panels.	ABS		PA PHC 22