



Chipsmall Limited consists of a professional team with an average of over 10 year of expertise in the distribution of electronic components. Based in Hongkong, we have already established firm and mutual-benefit business relationships with customers from,Europe,America and south Asia,supplying obsolete and hard-to-find components to meet their specific needs.

With the principle of “Quality Parts,Customers Priority,Honest Operation,and Considerate Service”,our business mainly focus on the distribution of electronic components. Line cards we deal with include Microchip,ALPS,ROHM,Xilinx,Pulse,ON,Everlight and Freescale. Main products comprise IC,Modules,Potentiometer,IC Socket,Relay,Connector.Our parts cover such applications as commercial,industrial, and automotives areas.

We are looking forward to setting up business relationship with you and hope to provide you with the best service and solution. Let us make a better world for our industry!



## Contact us

Tel: +86-755-8981 8866 Fax: +86-755-8427 6832

Email & Skype: info@chipsmall.com Web: www.chipsmall.com

Address: A1208, Overseas Decoration Building, #122 Zhenhua RD., Futian, Shenzhen, China



## PB Series Inner Panel *PBP Series*



**Note:** This product line will soon be discontinued as a stocked series. Available while quantities last. For alternative solution assistance, please contact Hammond Customer Service - [sales@hammfg.com](mailto:sales@hammfg.com) or USA (716) 630-7030, Canada and International (519) 822-2960.



- Available in steel or unfinished aluminum.
- 14 gauge steel panels are finished in white powder coating.
- Aluminum panels are 0.080" (2.03 mm) unfinished.
- Hardware to mount inner panel is included with PB series enclosures.

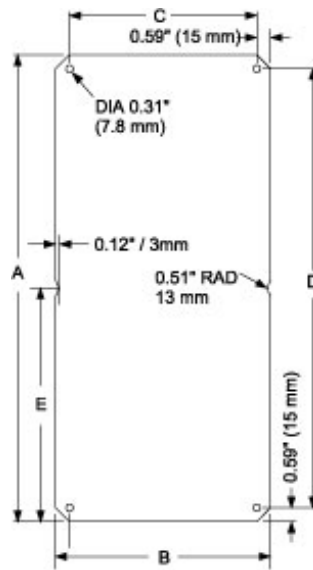

Steel Panel Part No.	Aluminum Panel	Fits PB Enclosure	A	B	C	D	E
PBP2718	PBPA2718	PB271818	9.06	5.51	4.33	7.88	-
PBP2727	PBPA2727	PB272718	9.06	9.06	7.88	7.88	-
PBP3627	PBPA3627	PB362718	12.60	9.06	7.88	11.42	-
PBP5427	PBPA5427	PB542718	19.69	9.06	7.88	18.51	9.84
PBP5436	PBPA5436	PB543618	19.69	12.60	11.42	18.51	9.84

*Data subject to change without notice*

